

APR 18 1975

WELL SCHEDULE  
GEOLOGICAL SURVEY

99  
Elog # 249 PUNCHED  
WATER RESOURCES DIVISION

U. S. DEPT. OF THE INTERIOR

MASTER CARD

Record by WTO Source of data Bowc Obs driller Date 2-20-73 Map MECHANICSBURG

State MISS County VAZOO (or town) 82

Latitude: 32° 43' 53" N Longitude: 090° 30' 05" W Sequential number: 1

Lat-long accuracy: 2 T 10 S, R 3 E Sec 10 NW, SW, NW

Local well number: 0009CB1010N03W Other number: B & M

Local use: 150249 Owner or name: FOREST MOODY Address: \_\_\_\_\_

Ownership: County, Fed Gov't, City, Corp or Co, Private, State Agency, Water Dist P

Use of water: (A) Air cond, Bottling, Comm, Dewater, Power, Fire, Dom, Irr, Med, Ind, P S, Rec, (S) Stock, Instit, Unused, Repressure, Recharge, Desal-P S, Desal-other, Other H

Use of well: (A) Anode, Drain, Seismic, Heat Res, Obs; Oil-gas; Recharge, Test, Unused, Withdraw, Waste, Destroyed. (W) W

DATA AVAILABLE: Well data  Freq. W/L meas.  Field aquifer char.

Hyd. lab. data:

Qual. water data, type:

Freq. sampling:  Pumpage inventory:  Aperture cards:

Log data: 130'-946' DE

WELL-DESCRIPTION CARD

SAME AS ON MASTER CARD Depth well: 950 ft Meas. 3

Depth cased: 930 ft Casing type: \_\_\_\_\_; Diam. 4x2 in 4

Finish: (C) porous concrete, (F) gravel w. (perf.), (G) gravel w. (screen), (H) horiz. gallery, (P) open end, (S) perf., (T) screen, (W) sd. pt., (X) shored, (Z) open hole, other S

Method Drilled: (A) air rot., (B) bored, (C) cable, (D) dug, (H) jetted, (J) air rot., (P) air percussion, (R) reverse, (T) trenching, (V) driven, (W) drive wash, (Z) other H

Date Drilled: 2-20-73 973 Pump intake setting: \_\_\_\_\_ ft 36

Driller: CRESSWELL address BENTONIA

Lift (type): (A) air, (B) bucket, (C) cent., (J) jet, (L) multiple, (M) multiple, (N) none, (P) piston, (R) rot., (S) submerg, (T) turb., (Z) other S Deep  Shallow

Power (type): (nat) diesel, elec, gas, gasoline, hand, gas, wind; (LP) H.P. 3/4 S Trans. or meter no. \_\_\_\_\_

Descrip. MP \_\_\_\_\_ ft above \_\_\_\_\_ ft below LSD, Alt. MP \_\_\_\_\_

Alt. LSD: 120 Accuracy: topo 4

Water Level: \_\_\_\_\_ ft above \_\_\_\_\_ ft below MP; \_\_\_\_\_ ft below LSD Accuracy: \_\_\_\_\_ D

Date meas: 373 Yield: \_\_\_\_\_ gpm 20 Method determined

Drawdown: \_\_\_\_\_ ft Accuracy: \_\_\_\_\_ Pumping period: \_\_\_\_\_ hrs \_\_\_\_\_

QUALITY OF WATER DATA: Iron \_\_\_\_\_ ppm Sulfate \_\_\_\_\_ ppm Chloride \_\_\_\_\_ ppm Hard. \_\_\_\_\_ ppm

Sp. Conduct \_\_\_\_\_ K x 10<sup>6</sup> Temp. \_\_\_\_\_ °F Date sampled \_\_\_\_\_

Taste, color, etc. \_\_\_\_\_

**HYDROGEOLOGIC CARD**

**SAME AS ON MASTER CARD** Physiographic Province: 03 Section: \_\_\_\_\_

Drainage Basin: E 15J Subbasin: \_\_\_\_\_

Topo of well site: (D) depression, stream channel, dunes, flat, hilltop, sink, swamp, (E) offshore, pediment, hillside, terrace, undulating, valley flat

MAJOR AQUIFER: system \_\_\_\_\_ series TE aquifer, formation, group SS

Lithology: \_\_\_\_\_ Origin: 2 Aquifer Thickness: 40 ft *broken*

Length of well open to: \_\_\_\_\_ ft 20 Depth to top of: \_\_\_\_\_ ft 890

MINOR AQUIFER: system \_\_\_\_\_ series \_\_\_\_\_ aquifer, formation, group \_\_\_\_\_

Lithology: \_\_\_\_\_ Origin: \_\_\_\_\_ Aquifer Thickness: \_\_\_\_\_ ft

Length of well open to: \_\_\_\_\_ ft \_\_\_\_\_ Depth to top of: \_\_\_\_\_ ft \_\_\_\_\_

Intervals Screened: \_\_\_\_\_

Depth to consolidated rock: \_\_\_\_\_ ft \_\_\_\_\_ Source of data: \_\_\_\_\_

Depth to basement: \_\_\_\_\_ ft \_\_\_\_\_ Source of data: \_\_\_\_\_

Surficial material: \_\_\_\_\_ Infiltration characteristics: \_\_\_\_\_

Coefficient Trans: \_\_\_\_\_ gpd/ft \_\_\_\_\_ Coefficient Storage: \_\_\_\_\_

Coefficient Perm: \_\_\_\_\_ gpd/ft<sup>2</sup>; Spec cap: \_\_\_\_\_ gpm/ft; Number of geologic cards: \_\_\_\_\_

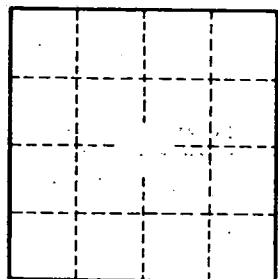
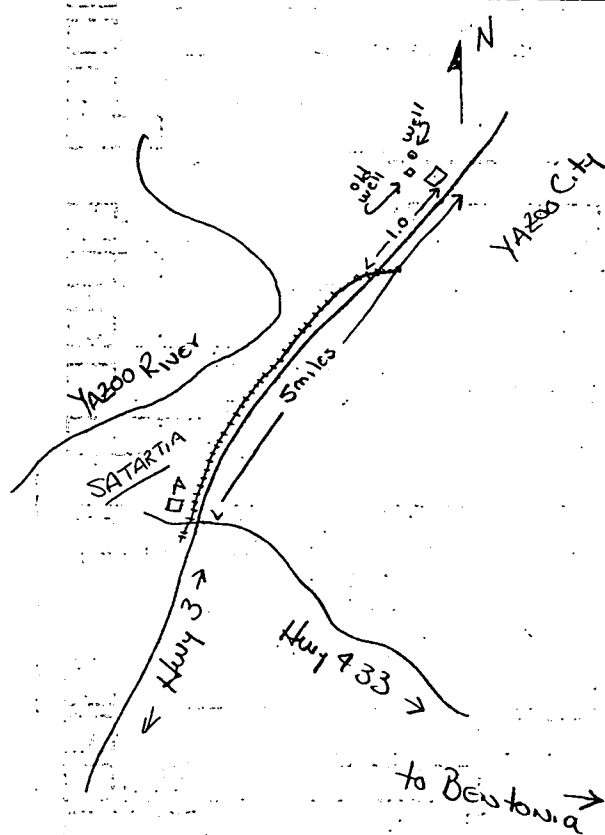

Well No. \_\_\_\_\_