

WELL SCHEDULE

U. S. DEPT. OF THE INTERIOR GEOLOGICAL SURVEY WATER RESOURCES DIVISION

MASTER CARD

Record by J. Shell Source of data BOWC Date 1/69 Map _____

State 45 County 28 (or town) Yalobusha 81

Latitude: 34° 08' 34" N Longitude: 089° 38' 27" W Sequential number: 7

La-long accuracy: 3 T 11 N 4 E 89 W NE NE

Local well number: C030 RA081 S04W Other number: Gore Circle B & M.

Local use: 064 Owner or name: City well #2 City well #1

Owner or name: WATER VALLEY W Address: Miss

Ownership: County, Fed Gov't, City, Corp or Co, Private, State Agency, Water Dist M

Use of water: (A) Air cond, Bottling, Comm, De-water, Fire, Dom, Irr, Med, Ind, P S, Rec, (S) Stock, Instat, Unused, Re-pressure, Recharge, Desal-P S, Desal-other, Other P

Use of well: (A) Anode, Drain, Seismic, Heat Res, Obs, Oil-gas, Recharge, Test, Unused, Withdraw, Waste, Destroyed. (D) (G) (H) (I) (J) (K) (L) (M) (N) (O) (P) (Q) (R) (S) (T) (U) (V) (W) (X) (Y) (Z) W

DATA AVAILABLE: Well data Freq. W/L meas.: Field aquifer char.

Hyd. lab. data:

Qual. water data; type: MSBOW 1168

Freq. sampling: Pumpage inventory: no, period:

Aperture cards: yes

Log data:

WELL-DESCRIPTION CARD

SAME AS ON MASTER CARD Depth well: 74 ft Meas. rept 3

Depth cased (first perf.): 44 ft Casing type: steel; Diam. 12 in

Finish: (C) porous concrete, (F) gravel w. (perf.), (G) gravel w. (screen), (H) horiz. gallery, (I) open end, (J) open perf., (K) screen, (L) sd. pt., (M) shored, (N) open hole, (O) other G

Method drilled: (A) air rot, (B) bored, (C) cable, (D) dug, (E) hyd jetted, (F) air rot., (G) percussion, (H) rotary, (I) reverse, (J) trenching, (K) driven, (L) drive wash, (M) other H

Date drilled: 968 Pump intake setting: _____ ft

Driller: Singer Layne Central

Lift (type): (A) air, (B) bucket, (C) cent, (D) jet, (E) multiple, (F) multiple, (G) none, (H) piston, (I) rot, (J) submerg, (K) turb, (L) other T Deep Shallow

Power (type): (A) diesel, (B) elec, (C) gas, (D) gasoline, (E) hand, (F) gas, (G) wind, (H) H.P. 25 Trans. or meter no. _____

Descrip. MP hole in pump base 2.0 above below LSD, Alt. MP _____

Alt. LSD: 300 Accuracy: (source) 5

Water Level 15.0 ft above below MP, Ft. above 13 LSD Accuracy: D

Date meas: 10/6/71 Yield: 620 gpm Method determined

Drawdown: 800 ft Accuracy: _____ Pumping period _____ hrs

QUALITY OF WATER DATA: Iron _____ ppm Sulfate _____ ppm Chloride _____ ppm Hard. _____ ppm

Sp. Conduct _____ K x 10⁶ Temp. _____ °F Date sampled 117 N68

Taste, color, etc. pH=5.4 CL=11. Fe trace (MSBOW)

Well No.

C 30

Well No. C 30

Latitude-longitude _____ N
_____ S
d m s d m s

HYDROGEOLOGIC CARD

SAME AS ON MASTER CARD Physiographic Province: 03 Section: _____

Drainage Basin: D Subbasin: 15F

Topo of well site: (D) depression, (C) stream channel, (E) dunes, (F) flat, (H) hilltop, (K) sink, (L) swamp, (P) offshore, (S) pediment, (T) hillside, (U) terrace, (V) undulating, valley flat

MAJOR AQUIFER: system _____ series TE aquifer, formation, group MW

Lithology: 4S Origin: 2 Aquifer Thickness: 64 ft

Length of well open to: 64 ft Depth to top of: 30 ft

MINOR AQUIFER: system _____ series _____ aquifer, formation, group _____

Lithology: _____ Origin: _____ Aquifer Thickness: _____ ft

Length of well open to: _____ ft Depth to top of: _____ ft

Intervals Screened: 10" SS shutter 44-74' 30' x 10" SS

Depth to consolidated rock: _____ ft Source of data: _____

Depth to basement: _____ ft Source of data: _____

Surficial material: _____ Infiltration characteristics: _____

Coefficient Trans: _____ gpd/ft² Coefficient Storage: _____

Coefficient Perm: _____ gpd/ft²; Spec cap: _____ gpm/ft; Number of geologic cards: _____

Only @ 800 gpm

Clay 0-9 ft
C. sand 9-73
Clay 73-82

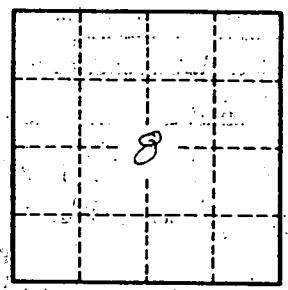

*4/21/71
Pumping test by cap flow meter.
W.L. 15.00
- 0.76
14.24*

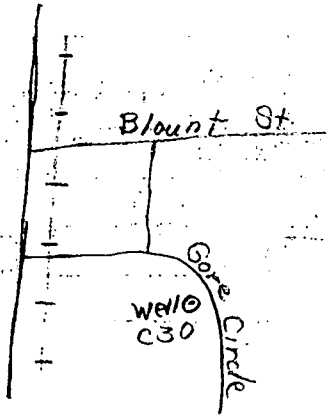

Well No.

C 30