

GW-759  
DOH-800006-01

TRANSMITTED FOR ADP

Noxapater Quad

6/77

Recorded by PEG JAC  
Date 3/28/69 4/27/77

U.S. GEOLOGICAL SURVEY  
WATER RESOURCES DIVISION  
MISSISSIPPI DISTRICT  
WELL RECORD

Well No. P14  
E-Log No. 23  
County WINSTON

Site ID 325940089041301 R=0\* T=A\* 2=W\* **PUNCHED**

Data reliab. 3=C\*<sup>C</sup>U Report. agency 4=USGS\* Dist. 6=28\* 7=28\* Co. 8=159\*

Lat. Long. 9=325940\* 10=0890413\* Well No. 12=P014\*

Location 13=NESW S 09 T 13 N R 12 E\* Alt. 16=540\*

Hyd. Unit (OWDC) 20=03180001\* Date 21=0312811969\*

Well use 23=W\* Water Use 24=P\* Hole depth 27= \* Well depth 28=530\*

WL 30=160\* Date 31=1010011969\* Source 33=S\*

Status 273=Y\*

7/19/79  
164.

GEN. SITE DATA

OWNER

R=158\* T=A\* Date 159# 0312811969\* Owner No. \_\_\_\_\_

Owner 161=NOXAPATER\*

FIELD CW

R=192\* T=A\* Date 193# 1010011969\* Temp. 196#00010\* 197=70.0\*

R=192\* T=A\* Date 193# 1010011969\* Cond. 196#00095\* 197=120\*

R=192\* T=A\* Date 193# 1 1\* pH 196#00040\* 197= \* \*

CONSTR.

R=58\* T=A\* 59# 1\* Date 60=0312811969\* Remarks \_\_\_\_\_

Drlg. 63=021\* Name HERNDON-HAMAN Method 65=H\* Finish 66=S\*

CASING

R=76\* T=A\* 59# 1\*

Top csng. 77# 0\* Bot. csng. 78=510\* Diam. 79# 18\*

R=76\* T=A\* 59# 1\*

Top csng. 77# \* Bot. csng. 78= \* Diam. 79# \* \*

OPENINGS

R=82\* T=A\* 59# 1\* Top 83# 510\* Bottom 84=530\*

Type 85=S\* Diam. 87=4\* Size 88= \* \*

R=82\* T=A\* 59# 1\* Top 83# \* Bottom 84= \* \*

Type 85= \* Diam. 87= \* Size 88= \* \*

YIELD

R=146\* T=A\* 147# 1\* Q 150=1110\* Q/S 272= \* \*

134 flows 146 pumped

R=42\* T= A \* Lift type 43# S\* Intake 44= \* Power type 45= E\*

LIFT Date 38= 03/28/1969\* H.P. 46= \*

R=198\* T= A \* Log 199# E\* Top 200= 0.\* Bot 201= 6.09.\*

R=198\* T= A \* Log 199# \* Top 200= \* Bot 201= \*

R=189\* T= A \* E Log No. 190# 0.23\* 191= M I S S D I S T \*

ANAL. R=114\* T= A \* Year 115# 1969\* Type 120= B\*

R=90\* T= A \* 256# 1\* Top 91= 4.75.\* Bot 92= 5.35.\*

Unit ID 93= 124WLCXL\* Name of Unit Lower Wilcox

R=90\* T= A \* 256# 1\* Top 91= \* Bot 92= \*

Unit ID 93= \* Name of Unit

R=98\* T= A \* 99# 1\* Unit tested 100= 124WLCXL\* 1032A\*

R=105\* T= A \* 99# 1\* Test No. 106# 1\*

107= 5.5350\* Transmissivity (gal/d)/ft

108= 8.88.\* Hydraul. cond. (gal/d)/ft

110= 0.0040\* Storage coeff. Boundaries

HYDRAULICS

# Water Level Data

12/1/88

WL= 160.00

1983 n. 84 well 599'

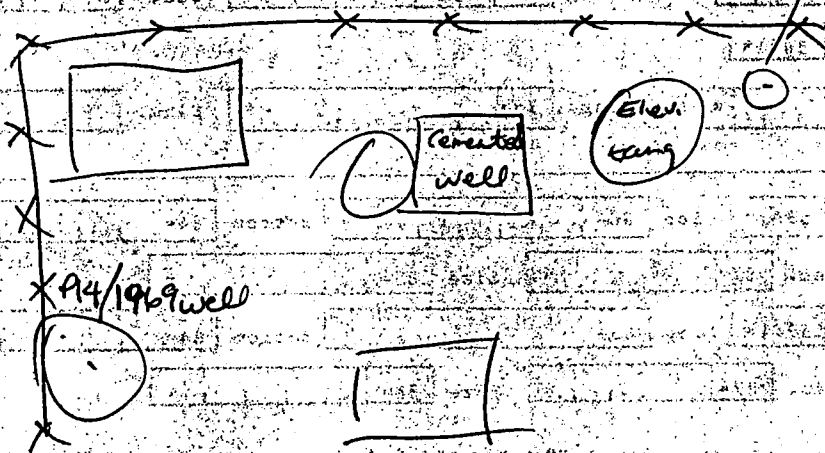

P14