

WELL SCHEDULE

U. S. DEPT. OF THE INTERIOR

GEOLOGICAL SURVEY

WATER RESOURCES DIVISION

REPLACEMENT

MASTER CARD

Record by P.E. Grantham Source WSP 576 p. 489 Date 4-29-63
of data Dr. J.C. Robert Map

State Mississippi County Wilkinson Co
(or town) 28 79

Latitude: 31 deg 06 min 02 sec N Longitude: 091 deg 17 min 49 sec W
Sequential number: 4

Lat-long accuracy: 3 T. 2 S. R. 2 E. Sec 38, NE $\frac{1}{4}$, NW $\frac{1}{4}$, NE $\frac{1}{4}$

Local well number: M006AA3802N02W Other number: #37m Bull. 56

Local use: WOODVILLE Owner or name: Town of Woodville

Owner or name: WOODVILLE Address: 1/4 mi. S of P.O.

Ownership: County, Fed Gov't, City, Corp or Co, Private, State Agency, Water Dist M

Use of water: (A) Air cond, Bottling, Comm, Dewater, Power, Fire, Dom, Irr, Med, Ind, P S, Rec, (S) Stock, Instit, Unused, Reppure, Recharge, Desal-P S, Desal-other, Other U

Use of well: (A) Anode, Drain, Seismic, Heat Res, Obs, Oil-gas, Recharge, Test, Unused, Withdraw, Waste, Destroyed D

DATA AVAILABLE: Well data 70 Freq. W/L meas.: 71 Field aquifer char. 72

Hyd. lab. data: 73

Qual. water data; type: MSBOH: 8-25-59 74

Freq. sampling: 75 Pumpage inventory: yes 76 no, period: 77

Aperture cards: 78

Log data: Drllrs Log WSP 576 p. 489 79

WELL-DESCRIPTION CARD

SAME AS ON MASTER CARD Depth well: 960 ft 960 Meas. 24 6

Depth cased: (first perf.) ft 25 Casing type: Steel ; Diám. 8 in 29 30

Finish: porous concrete, gravel w. (perf.), gravel w. (screen), horiz. gallery, open end, (P) perf., (S) screen, (T) sd. pt., (W) shored, (X) open hole, (Z) other 31

Method Drilled: (A) air bored, (B) cable, (C) dug, (D) hyd jettied, (H) air reverse, (J) percussion, (P) rotary, (R) trenching, (T) driven, (V) drive wash, (W) other 32

Date Drilled: 1916 9/16 Pump intake setting: ft 36 38

Driller: W. Sperry name address

Lift (type): (A) air, (B) bucket, (C) cent, (J) jet, (L) multiple, (M) multiple, (N) none, (P) piston, (R) rot, (S) submerg, (T) turb, other 39 Deep 40

Power (type): diesel, elec, gas, gasoline, hand, gas, wind; H.P. 41 Trans. or meter no. 42

Descrip. MP t.o.c ft above LSD. Alt. MP 43

Alt. LSD: 360 360 Accuracy: (source) 47 5

Water Level: 292 ft below MP; Ft below LSD 291 Accuracy: 52 A

Date meas: 1/15/70 170 Yield: 100 gpm 100 Method determined 61

Drawdown: ft 62 Accuracy: 63 Pumping period hrs 64 68

QUALITY OF WATER DATA: Iron 8 ppm 69 Sulfate 11 ppm 70 Chloride 1.0 ppm 71 Hard. 22 ppm 72

Sp. Conduct 73 K x 10⁶ Temp. °F 76 Date sampled 859 77 79

Taste, color, etc. 80

RECORDED AND VERIFIED
ROLLA COMPUTATION BRANCH

Well No.

M6

Well No. M6

Latitude-longitude _____
d m s d m s

HYDROGEOLOGIC CARD

SAME AS ON MASTER CARD Physiographic Province: _____ Section: 03

Drainage Basin: D Subbasin: 14E

Topo of well site: (D) depression, stream channel, dunes, flat, hilltop, sink, swamp, (E) (F) (H) (K) (L) (P) (S) (T) (U) (V) offshore, pediment, hillside, terrace, undulating, valley flat

MAJOR AQUIFER: system _____ series TM aquifer, formation, group MZ

Lithology: US Origin: 3 Aquifer Thickness: _____ ft

Length of well open to: _____ ft Depth to top of: _____ ft

MINOR AQUIFER: system _____ series _____ aquifer, formation, group _____

Lithology: _____ Origin: _____ Aquifer Thickness: _____ ft

Length of well open to: _____ ft Depth to top of: _____ ft

Intervals Screened: _____

Depth to consolidated rock: _____ ft Source of data: _____

Depth to basement: _____ ft Source of data: _____

Surficial material: _____ Infiltration characteristics: _____

Coefficient Trans: _____ gpd/ft Coefficient Storage: _____

Coefficient Perm: _____ gpd/ft²; Spec cap: _____ gpm/ft; Number of geologic cards: _____

Located 1/4 mile south of P.O.

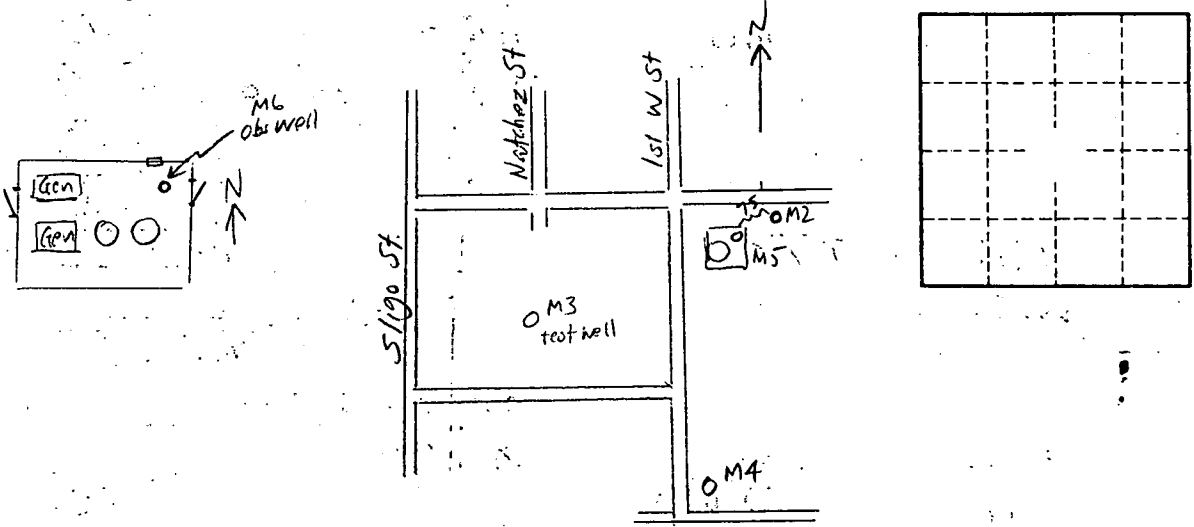

WL 300 in 1943 (Bull. 57)
280 4/29/63

Well No.

M6