

JUN 26 1975

H 29

ENCLOSURE

FORM 9-1642 (1-68)

Well No.

WELL SCHEDULE

E log # 46

U. S. DEPT. OF THE INTERIOR

GEOLOGICAL SURVEY

WATER RESOURCES DIVISION

Not  
Destruction  
completed  
11/20/76  
JAE

MASTER CARD

Record by WTO Source of data Obs driller Date 7-11-74 Map Walthall Quad

State Miss 28 County (or town) Webster 78

Latitude: 33<sup>3</sup>3<sup>1</sup>4<sup>5</sup>N Longitude: 0<sup>8</sup>9<sup>1</sup>6<sup>4</sup>3 Sequential number: 1

Lat-long accuracy: 2<sup>0</sup> T 19<sup>0</sup> S, R 10<sup>0</sup> W, Sec 8 N 1/2 E, SW NE

Local well number: H029 A0819N10E Other number: B & M

Local use: 330046 Owner or name: Emergency Supply well

Owner or name: EUPORA Address: Eupora, Miss.

Ownership: County, Fed Gov't, City, Corp or Co, Private, State Agency, Water Dist M

Use of water: (A) Air cond, Bottling, Comm, Dewater, Power, Fire, Dom, Irr, Med, Ind, P S, Rec, (S) Stock, (T) Instit, (U) Unused, (V) Repressure, (W) Recharge, (X) Desal-P S, (Y) Desal-other, (Z) Other U

Use of well: (A) Anode, (D) Drain, (G) Seismic, (H) Heat Res, (I) Obs, (J) Oil gas, (K) Recharge, (L) Test, (M) Unused, (N) Withdraw, (O) Waste, (P) Destroyed. 7

DATA AVAILABLE: Well data  Freq. W/L meas.:  Field aquifer char.

Hyd. lab. data:

Qual. water data; type:

Freq. sampling:  Pumpage inventory:  yes no; period:

Aperture cards:  yes

Log data: E log 10' - 257'

WELL-DESCRIPTION CARD

SAME AS ON MASTER CARD Depth well:  ft  Meas.  accuracy

Depth cased:  ft  Casing type:  ; Diam.  in

Finish: (C) porous concrete, (F) gravel w. (perf.), (G) gravel w. (screen), (H) horz. gallery, (I) open end, (J) open hole, (K) other, (L) other, (M) other, (N) other, (O) other, (P) other, (Q) other, (R) other, (S) other, (T) other, (U) other, (V) other, (W) other, (X) other, (Y) other, (Z) other

Method Drilled: (A) air rot, (B) bored, (C) cable, (D) dug, (E) hyd rot., (F) jetted, (G) air percussion, (H) reverse, (I) rotary, (J) trenching, (K) driven, (L) wash, (M) other, (N) other, (O) other, (P) other, (Q) other, (R) other, (S) other, (T) other, (U) other, (V) other, (W) other, (X) other, (Y) other, (Z) other

Date Drilled: 7-11-74 974 Pump intake setting:  ft

Driller: Herndon Well & Supply Shannon Miss.

Lift (type): (A) air, (B) bucket, (C) cent, (D) jet, (E) multiple, (F) multiple, (G) none, (H) piston, (I) rot, (J) submerg, (K) turb, (L) other, (M) other, (N) other, (O) other, (P) other, (Q) other, (R) other, (S) other, (T) other, (U) other, (V) other, (W) other, (X) other, (Y) other, (Z) other  Deep  Shallow

Power (type): (A) diesel, (B) elec, (C) gas, (D) gasoline, (E) hand, (F) gas, (G) wind, (H) H.P., (I) other, (J) other, (K) other, (L) other, (M) other, (N) other, (O) other, (P) other, (Q) other, (R) other, (S) other, (T) other, (U) other, (V) other, (W) other, (X) other, (Y) other, (Z) other  Trans. or meter no.

Descrip. MP  above ft below LSD, Alt. MP

Alt. LSD: 365 Accuracy: topo

Water Level:  ft above below MP;  ft above below LSD Accuracy:

Date meas:  Yield:  gpm  Method determined

Drawdown:  ft Accuracy:  Pumping period:  hrs

QUALITY OF WATER DATA: Iron  ppm Sulfate  ppm Chloride  ppm Hard.  ppm

Sp. Conduct  K x 10<sup>6</sup> Temp.  °F Date sampled

Taste, color, etc.

Well No. \_\_\_\_\_

Latitude-longitude \_\_\_\_\_ N  
S  
d m s d m s

### HYDROGEOLOGIC CARD

SAME AS ON MASTER CARD

Physiographic Province: \_\_\_\_\_

013

Section: \_\_\_\_\_

D Drainage Basin: \_\_\_\_\_

115K

Subbasin: \_\_\_\_\_

Topo of well site: (D) depression, stream channel, (C) dunes, flat, hilltop, sink, swamp, (E) offshore, pediment, hillside, terrace, undulating, valley flat, (F) dunes, flat, hilltop, sink, swamp, (H) (K) (L) (P) (S) (T) (U) (V)

MAJOR AQUIFER: system \_\_\_\_\_ series \_\_\_\_\_ aquifer, formation, group \_\_\_\_\_

Lithology: \_\_\_\_\_ Origin: \_\_\_\_\_ Aquifer Thickness: \_\_\_\_\_ ft

Length of well open to: \_\_\_\_\_ ft Depth to top of: \_\_\_\_\_ ft

MINOR AQUIFER: system \_\_\_\_\_ series \_\_\_\_\_ aquifer, formation, group \_\_\_\_\_

Lithology: \_\_\_\_\_ Origin: \_\_\_\_\_ Aquifer Thickness: \_\_\_\_\_ ft

Length of well open to: \_\_\_\_\_ ft Depth to top of: \_\_\_\_\_ ft

Intervals Screened: \_\_\_\_\_

Depth to consolidated rock: \_\_\_\_\_ ft Source of data: \_\_\_\_\_

Depth to basement: \_\_\_\_\_ ft Source of data: \_\_\_\_\_

Surficial material: \_\_\_\_\_ Infiltration characteristics: \_\_\_\_\_

Coefficient Trans: \_\_\_\_\_ gpd/ft Coefficient Storage: \_\_\_\_\_

Coefficient Perm: \_\_\_\_\_ gpd/ft<sup>2</sup>; Spec cap: \_\_\_\_\_ gpm/ft; Number of geologic cards: \_\_\_\_\_

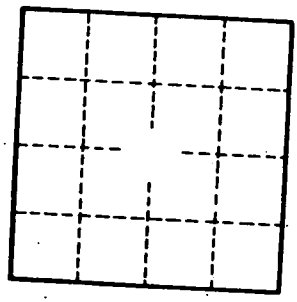
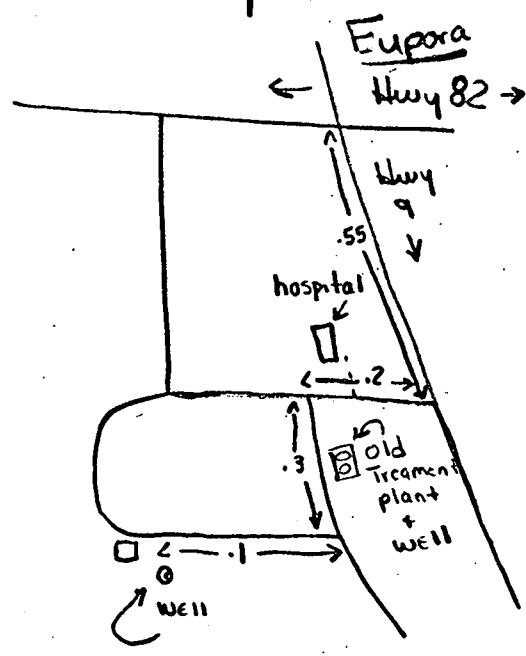

Well No. \_\_\_\_\_