

WELL SCHEDULE

U. S. DEPT. OF THE INTERIOR

GEOLOGICAL SURVEY

E-log # 29 WATER RESOURCES DIVISION

MASTER CARD

Record by G. J. Dalsin Source of data Dr. LOG Date 5-5-1971 Map Walthall Miss

State 28 County (or town) 78

Latitude: 33 31 38 N Longitude: 08 9 17 W Sequential number: 1

Lat-long accuracy: 20 T. 19 S, R. 10 W, Sec. 7, SW 1/4, SW 1/4, NE 1/4

Local well number: H025CA0719N10E Other number: TEST HOLE # 3

Local use: 021029 Owner or name: EUPORA, MISS

Owner or name: EUPORA Address: SW of Eupora

Ownership: County, Fed Gov't, City, Corp or Co, Private, State Agency, Water Dist M

Use of Air cond, Bottling, Comm, Dewater, Power, Fire, Dom, Irr, Med, Ind, P S, Rec, water: (S) (T) (U) (V) (W) (X) (Y) (Z) U

Use of well: (A) (D) (G) (H) (I) (J) (K) (L) (M) (N) (O) (P) (Q) (R) (S) (T) (U) (V) (W) (X) (Y) (Z) T

DATA AVAILABLE: Well data 70 Freq. W/L meas.: 71 Field aquifer char. 72

Hyd. lab. data: 73

Qual. water data; type: 74

Freq. sampling: 75 Pumpage inventory: yes no; period: 76

Aperture cards: 77

Log data: F-Log 6-338' DE 78 79

WELL-DESCRIPTION CARD

SAME AS ON MASTER CARD Depth well: 338 ft Meas. rept accuracy 24 4

Depth cased: (first perf.) ft Casing type: Diam. in 29 30

Finish: porous concrete, gravel w. (perf.), gravel w. (screen), horiz. gallery, open end, perf., screen, sd. pt., shored, open hole, other 31

Method: (A) (B) (C) (D) (E) (F) (G) (H) (I) (J) (K) (L) (M) (N) (O) (P) (Q) (R) (S) (T) (U) (V) (W) (X) (Y) (Z) H

Drilled: air bored, cable, dug, hyd jetted, rot., air reverse percuss, rotary, driven, wash, other 32

Date Drilled: 5-5-1971 9 7 1 Pump intake setting: ft 36 38

Driller: Herndon-Horman Shannon name address

Lift (type): (A) (B) (C) (D) (E) (F) (G) (H) (I) (J) (K) (L) (M) (N) (O) (P) (Q) (R) (S) (T) (U) (V) (W) (X) (Y) (Z) Deep Shallow 39 40

Power (type): nat LP Trans. or meter no. 41

Descrip. MP ft above below LSD, Alt. MP

Alt. LSD: 380 Accuracy: (source) Topo 20' cont. 47

Water Level ft above below MP; Ft below LSD Accuracy: 52

Date meas: Yield: gpm Method determined 61

Drawdown: ft Accuracy: Pumping period hrs 66 68

QUALITY OF WATER DATA: Iron ppm Sulfate ppm Chloride ppm Hard. ppm 72

Sp. Conduct K x 10 Temp. °F Date sampled 73 74 76 77 79

Taste, color, etc.

PUNCHED and VERIFIED ROLLA COMPUTATION BRANCH

Well No.

Well No. H25

Latitude-Longitude \_\_\_\_\_  
d m s d m s

**HYDROGEOLOGIC CARD**

SAME AS ON MASTER CARD Physiographic Province: 03 Section: \_\_\_\_\_

D Drainage Basin: 15K Subbasin: \_\_\_\_\_

Topo of well site: (D) depression, stream channel, dunes, flat, hilltop, sink, swamp, (F) offshore, pediment, hillside, terrace, undulating, valley flat: F

MAJOR AQUIFER: system \_\_\_\_\_ series TIE aquifer, formation, group TELW LW

Lithology: 3 Origin: 2 Aquifer Thickness: \_\_\_\_\_ ft

Length of well open to: \_\_\_\_\_ ft Depth to top of: \_\_\_\_\_ ft

MINOR AQUIFER: system \_\_\_\_\_ series \_\_\_\_\_ aquifer, formation, group \_\_\_\_\_

Lithology: \_\_\_\_\_ Origin: \_\_\_\_\_ Aquifer Thickness: \_\_\_\_\_ ft

Length of well open to: \_\_\_\_\_ ft Depth to top of: \_\_\_\_\_ ft

Intervals Screened: \_\_\_\_\_

Depth to consolidated rock: \_\_\_\_\_ ft Source of data: \_\_\_\_\_

Depth to basement: \_\_\_\_\_ ft Source of data: \_\_\_\_\_

Surficial material: \_\_\_\_\_ Infiltration characteristics: \_\_\_\_\_

Coefficient Trans: \_\_\_\_\_ gpd/ft Coefficient Storage: \_\_\_\_\_

Coefficient Perm: \_\_\_\_\_ gpd/ft; Spec cap: \_\_\_\_\_ gpm/ft; Number of geologic cards: \_\_\_\_\_

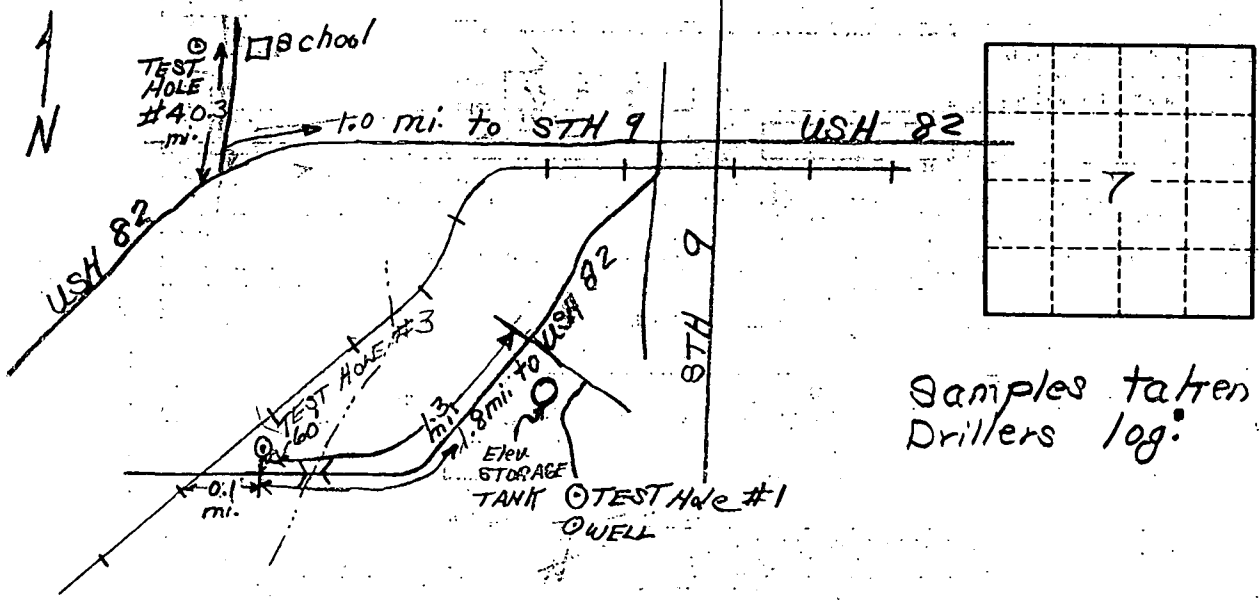

Well No.