

DOA # 0100005-01  
GW 01010

TRANSMITTED FOR ADP

-1500  
boge Eufora  
1916

Recorded by WTO JAC

U.S. GEOLOGICAL SURVEY  
WATER RESOURCES DIVISION  
MISSISSIPPI DISTRICT  
WELL RECORD

6/77

Well No. H19

Date 9/69 4/26/77

E-Log No. #21

GPSD 10/31/96 CH

County WEBSTER

Site ID 333145089152501 R=0\* T=A\* 2=W\*

**PUNCHED**

Eupora Quad

GEN. SITE DATA

Data reliab. 3=C Report. agency 4=USGS Dist. 6=28 7=28 Co. 8=155

Lat. 9=333145 Long. 10=0891525 Well No. 12=H019

Location 13=SW/NW/SE/NN 13=NWSE S 09 T 19N R 10E Alt. 16=355

Hyd. Unit (OWDC) 20= Date 21=0810011969

Well use 23=W Water Use 24=P Hole depth 27= Well depth 28=149

WL 30=44 Date 31=0810011969 Source 33=G

Status 273=Y

OWNER

R=158\* T=A\* Date 159#0810011969 Owner No.

Owner 161=LEGRANGE WA

*This is now a City of Eupora Well!*

FIELD QW

R=192\* T=A\* Date 193#1111911970 Temp. 196#00010 197=17.5

R=192\* T=A\* Date 193# Cond. 196#00095 197=

R=192\* T=A\* Date 193#1111911970 pH 196#00400 197=6.8

CONSTR.

R=58\* T=A\* 59#1 Date 60=0810011969 Remarks

Drlg. 63=064 Name Layne Central Method 65=H Finish 66=S

CASING

R=76\* T=A\* 59#1

Top csgn. 77#0 Bot. csgn. 78=129 Diam. 79#16

R=76\* T=A\* 59#1

Top csgn 77# Bot. csgn. 78= Diam. 79#

OPENINGS

R=82\* T=A\* 59#1 Top 83#129 Bottom 84=149

Type 85=S Diam. 87=6 Size 88=

R=82\* T=A\* 59#1 Top 83# Bottom 84=

Type 85= Diam. 87= Size 88=

*This is wrong, see drillers log*

YIELD

R=146 T=A\* 147#1 Q 150=7.8 Q/S 272=

134 flows 146 pumped

R=42\* T= A \* Lift type 43# 7 \* Intake 44= \* Power type 45= E \*

LIFT Date 38= 08/00/1969 \* H.P. 46= \*

R=198\* T= A \* Log 199# D \* Top 200= 0. \* Bot 201= 1.60. \*

R=198\* T= A \* Log 199# E \* Top 200= 1.27. \* Bot 201= 1.153. \*

R=189\* T= A \* E Log No. 190# 021. \* 191= M I S S D I S T \*

ANAL. R=114\* T= A \* Year 115# 1970. \* Type 120= B \*

R=90\* T= A \* 256# 1 \* Top 91= 1.30. \* Bot 92= 1.52. \*

AQUIFERS Unit ID 93= 124WLCXL \* Name of Unit LOWER W.L.Co \*

R=90\* T= A \* 256# 1 \* Top 91= \* Bot 92= \*

Unit ID 93= \* Name of Unit

R=98\* T= A \* 99# 1 \* Unit tested 100= \*

R=105\* T= A \* 99# 1 \* Test No. 106# \*

HYDRAULICS 107= \* Transmissivity (gal/d)/ft

108= \* Hydraul. cond. (gal/d)/ft<sup>2</sup>

110= \* Storage coeff. Boundaries

Webster  
H 19  
8-29-69

MISSISSIPPI  
BOARD OF WATER COMMISSIONERS  
416 North State Street  
Jackson, Mississippi 39201

CODED

WATER WELL DRILLERS LOG

8-29 1969 Lump Central Co. Webster  
date well completed firm name county well located

LANDOWNER:	description of formations encountered	from	to
<u>LaGrange Water Assoc.</u>			
<u>Eupora, Miss.</u> (mailing address)	<u>Loose White Sand</u>	<u>12</u>	<u>17</u>
WELL LOCATION:	<u>Hard Clay</u>	<u>17</u>	<u>101</u>
sec. <u>9</u> T <u>19</u> N R <u>10</u> E	<u>Clay Hard Sand Fine Sand</u>	<u>101</u>	<u>115</u>
<u>1/4</u> miles <u>S.E.</u> of <u>EUPORA</u> (distance) (direction) (nearest town)	<u>Hard Black Clay</u>	<u>115</u>	<u>129</u>
WELL PURPOSE: <u>Domestic</u> (home, irrigation, municipal, industrial)	<u>Sand</u>	<u>129</u>	<u>135</u>
WELL COMPLETION DATA:	<u>Rock</u>	<u>135</u>	<u>136</u>
(1) diameter (inches) <u>16"</u>	<u>Fine Sand &amp; Clay</u>	<u>136</u>	<u>150</u>
(2) total depth (feet) <u>153'</u>	<u>Hard Black Clay</u>	<u>150</u>	<u>193</u>
(3) static water level (feet) <u>44'</u> below top of ground.			
(4) casing <u>Steel</u> <u>100'</u> (material) (depth) <u>16" AND 129' 2 8"</u> (size) If telescope see back.			
(5) screen <u>20'</u> <u>129'</u> (length) (depth to top) <u>6" Stainless Steel</u> (size) (material)			
(6) pump _____ (HP) _____ (yield gpm) <u>Electric</u> (type power)			
(7) electric log _____ (yes or no) ( <u>USGS e-log # 21</u> ) (organization running log)			
(8) how well bottom plugged <u>Solid</u> <u>Bottom</u>			
DRILLERS REMARKS: <u>Pump not installed as of this date. No tests run.</u>			

OCT 13 1969

MISS. BD. OF WATER COMM.

7

If well telescopes please sketch and show depths.

GROUND LEVEL

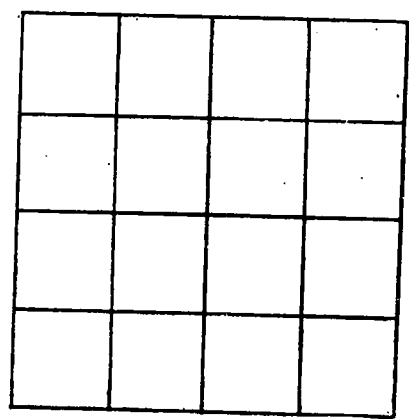

SECTION \_\_\_\_\_

Please indicate well location X.

ADDITIONAL INFORMATION

A series of horizontal lines for recording additional information.

If more than one screen, show locations of each on sketch.

DEPARTMENT OF ENVIRONMENTAL QUALITY - OLWR  
PUBLIC SUPPLY WELLS PROJECT

GPS LOG

USER NAME(S): Hornbeak DATE: 10/31/96

UNIT DEQ #: 82859 FILE #: B103121A

HEALTH DEPT. #: 100005-01 ELEV. \_\_\_\_\_

USGS #: H19 (Webster Co.) OLWR #: \_\_\_\_\_

OWNER: La Grange Water Assoc. QUAD: Eupora

LOCATION: SE-NW S 9 T 19N R 10E COUNTY: Webster

LOCATION DESCRIPTION: .10 mi. East of Elec. Substation which is on NE side of Hwy 9 S. 1.0 mi. SE of Hwy 82 (Eupora)

CASING DIA: 16" PUMP TYPE & SIZE: 10 HP Elec.

GPS FIELD LOCATION: LAT. 33° 31' 40.7" LONG. 89° 15' 26.6"

GPS CORRECTED LOCATION: LAT. 33.52798618 LONG. 89.25709314

REMARKS: GPS at Well.

\* (Choctaw Co. well in Webster Co.)

\* (Well is No Longer in Use.)

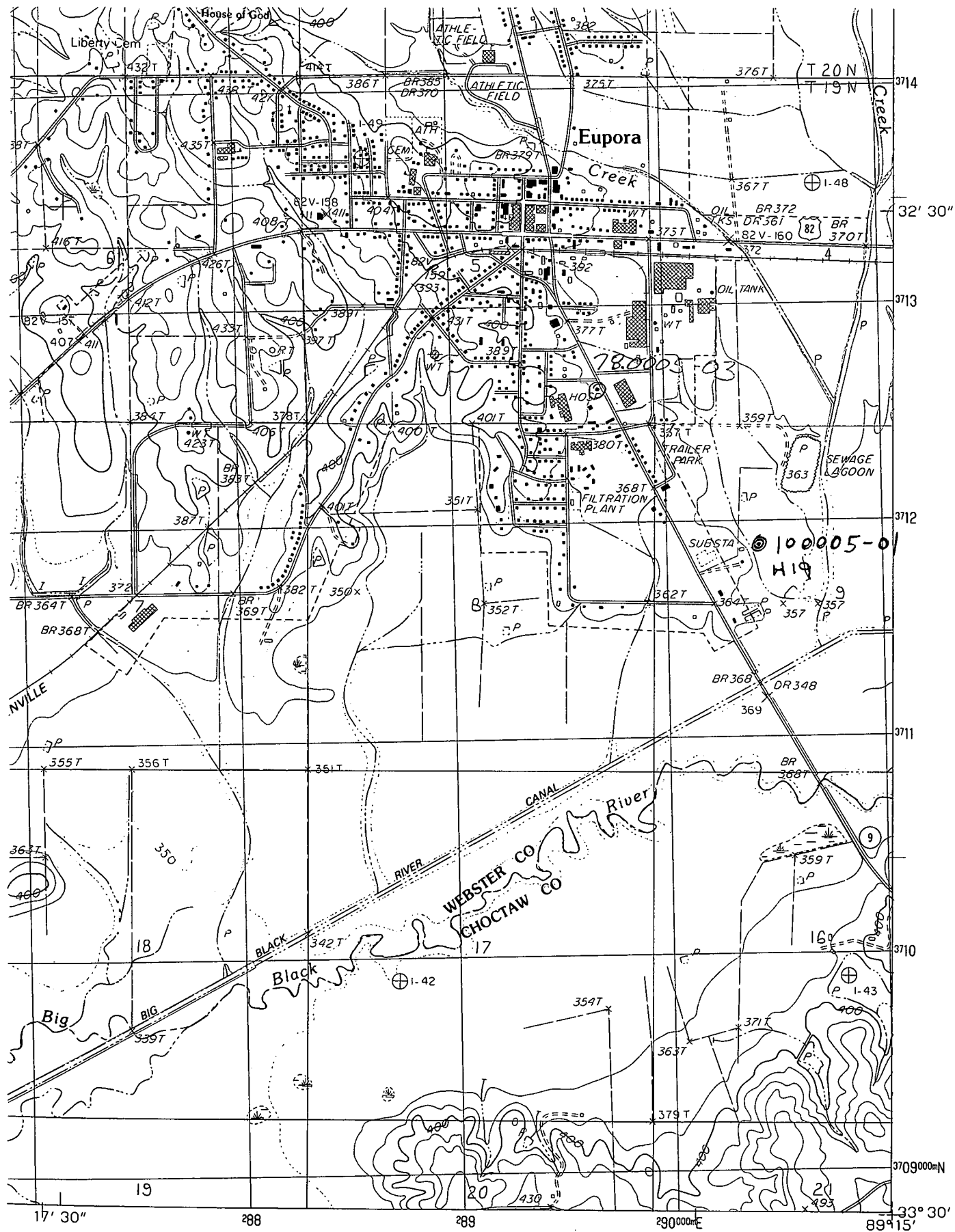

7 76  
5-19N 10

100005-01  
H19

INTERIOR—GEOLOGICAL SURVEY, RESTON, VIRGINIA—1984

ROAD LEGEND

- Improved Road .....
- Unimproved Road .....
- Trail .....
- Interstate Route
- ◻ U. S. Route
- State Route



1	2	3	1 Cadaretta
			2 Bellefontaine
			3 Hobbsland



Webster  
H 19  
8-29-69

MISSISSIPPI  
BOARD OF WATER COMMISSIONERS  
416 North State Street  
Jackson, Mississippi 39201

CODED

WATER WELL DRILLERS LOG

8-29 1969 Lynn Central Co. Webster  
date well completed firm name county well located

LANDOWNER:  
Lake George Water Assoc.  
Eupora, Miss.  
(mailing address)

description of formations encountered	from	to
<u>Sandy Clay</u>	<u>0</u>	<u>12</u>
<u>Loose White Sand</u>	<u>12</u>	<u>17</u>
<u>Hard Clay</u>	<u>17</u>	<u>101</u>
<u>Clay Hard Clay Fine Sand</u>	<u>101</u>	<u>115</u>
<u>Hard Black Clay</u>	<u>115</u>	<u>129</u>
<u>Sand</u>	<u>129</u>	<u>135</u>
<u>Rock</u>	<u>135</u>	<u>136</u>
<u>Fine Sand &amp; Clay</u>	<u>136</u>	<u>150</u>
<u>Hard Black Clay</u>	<u>150</u>	<u>193</u>

WELL LOCATION:  
sec 9 T 19 N R 10 E  
2/4 mile S.E. of EUPORA  
(distance) (direction) (nearest town)

WELL PURPOSE: Domestic  
(home, irrigation, municipal, industrial)

- WELL COMPLETION DATA:
- (1) diameter (inches) 16"
  - (2) total depth (feet) 153'
  - (3) static water level (feet) 44' below top of ground.
  - (4) casing Steel, 100'  
(material) (depth)  
16" AND 129' O.D. 8"  
(size) if telescope see back.
  - (5) screen 20', 129'  
(length) (depth to top)  
6" Stainless Steel  
(size) (material)
  - (6) pump \_\_\_\_\_ (HP) \_\_\_\_\_ (yield gpm)  
Electric  
(type power)
  - (7) electric log \_\_\_\_\_ (yes or no) (USGS  
e-log #21)  
(organization running log)
  - (8) how well bottom plugged Solid  
Bottom

DRILLERS REMARKS:  
Pump not installed as of  
this date. No tests run.

OCT 13 1969  
MISS. BD. OF  
WATER COMM.