

MAR 17 1975

U. S. DEPT. OF THE INTERIOR

WELL SCHEDULE
GEOLOGICAL SURVEY

Well No. H10

WATER RESOURCES DIVISION

MASTER CARD

Record by RET

Source of data MBOWC

Date 10-14-70 1:02, 500

NW NW Sec 3

Latitude: 33° 39' 12" N

County Webster

Map WALTHAM QUAL

Lat-long accuracy: 20' T 20' S

Longitude: 089° 17' 27" W

Sequential number: 1

Local well number: H0100B3020N10E

W, Sec 30, NW t, SE t, NW t

Other number: B & M

Local use: 002

Owner or name: MT ZION WA

Owner of name:

Ownership: County, Fed Gov't, City, Corp or Co, Private, State Agency, Water Dist

Address:

Use of water: (A) Air cond, Bottling, Comm, Dewater, Power, Fire, Dom, Irr, Mad, Ind, P S, Rec, Stock, Instit, Unused, Recharge, Desal-P S, Desal-other, Other

Use of well: (A) Anode, Drain, Seismic, Heat Res, Obs, Oil-gas, Recharge, Test, Unused, Withdraw, Waste, Destroyed

DATA AVAILABLE: Well data Freq. W/L meas: Field aquifer char.

Hyd. lab. data: Qual. water data; type: MSBOW 10/67

Freq. sampling: Aperture cards: Pumpage inventory: yes no, period:

Log data: E log #15 on test well 0.6 mi to the south - H13

WELL-DESCRIPTION CARD

SAME AS ON MASTER CARD

Depth well: 370 ft Meas. 370 ft Casing type: 3

Finish: porous concrete, gravel v. concrete, gravel v. (perf.), gravel v. (screen), horiz. gallery, end, open perf., screen, sd. pt., shored, open hole, other

Method: (A) air bored, (B) cable, (C) dug, (D) hyd rot., (E) jetted, (F) air percussion, (G) reverse, (H) trenching, (I) driven, (J) drive wash, other

Drilled: 967 ft Pump intake setting: ft

Driller: Ratliff Lift (type): 7 Deep Shallow

Power (type): elec nat gas, gasoline, hand, LP, gas, wind; H.P. 20 address

Alt. LSD: 490 ft above MP; 165 ft below LSD, Alt. MP 5

Water Level: 164.71 ft Date meas: 5-6-1971 Yield: 100 gal on test Accuracy: 80

Drawdown: ft Method determined: 1

QUALITY OF WATER DATA: Iron 420 ppm Sulfate 3 ppm Chloride 119.5 ppm

Sp. Conduct 420 K x 10⁶ Temp. 57.1 °F Date sampled 571

Taste, color, etc. Fe = 11 pH = 8.2 Cl = 56

12/12/79
490 MP 193.07
191 191.07
299 191.07

Well No. H10

Well No. H10

Latitude-longitude _____ N
S
d m s d m s

HYDROGEOLOGIC CARD

SAME AS ON MASTER CARD Physiographic Province: 03 Section: _____

D Drainage Basin: 15K Subbasin: _____

Topo of well site: (D) depression, stream channel, dunes, flat, hilltop, sink, swamp, (E) offshore, pediment, hillside, terrace, undulating, valley flat
(C) (E) (F) (R) (K) (L) (U) (V)

MAJOR AQUIFER: system _____ series TE aquifer, formation, group LW

Lithology: _____ Origin: 2 Aquifer Thickness: 14-30 ft

Length of well open to: 14 ft Depth to top of: 16 ft 355 ft

MINOR AQUIFER: system _____ series _____ aquifer, formation, group _____

Lithology: _____ Origin: _____ Aquifer Thickness: _____ ft

Length of well open to: _____ ft Depth to top of: _____ ft

Intervals Screened: 354-370 ft 16' x 4" ss

Depth to consolidated rock: _____ ft Source of data: _____

Depth to basement: _____ ft Source of data: _____

Surficial material: _____ Infiltration characteristics: _____

Coefficient Trans: 6.000 gpd/ft 602 Coefficient Storage: _____

Coefficient Perm: 200-400 gpd/ft²; Spec cap: 2.6 gpm/ft; Number of geologic cards: _____

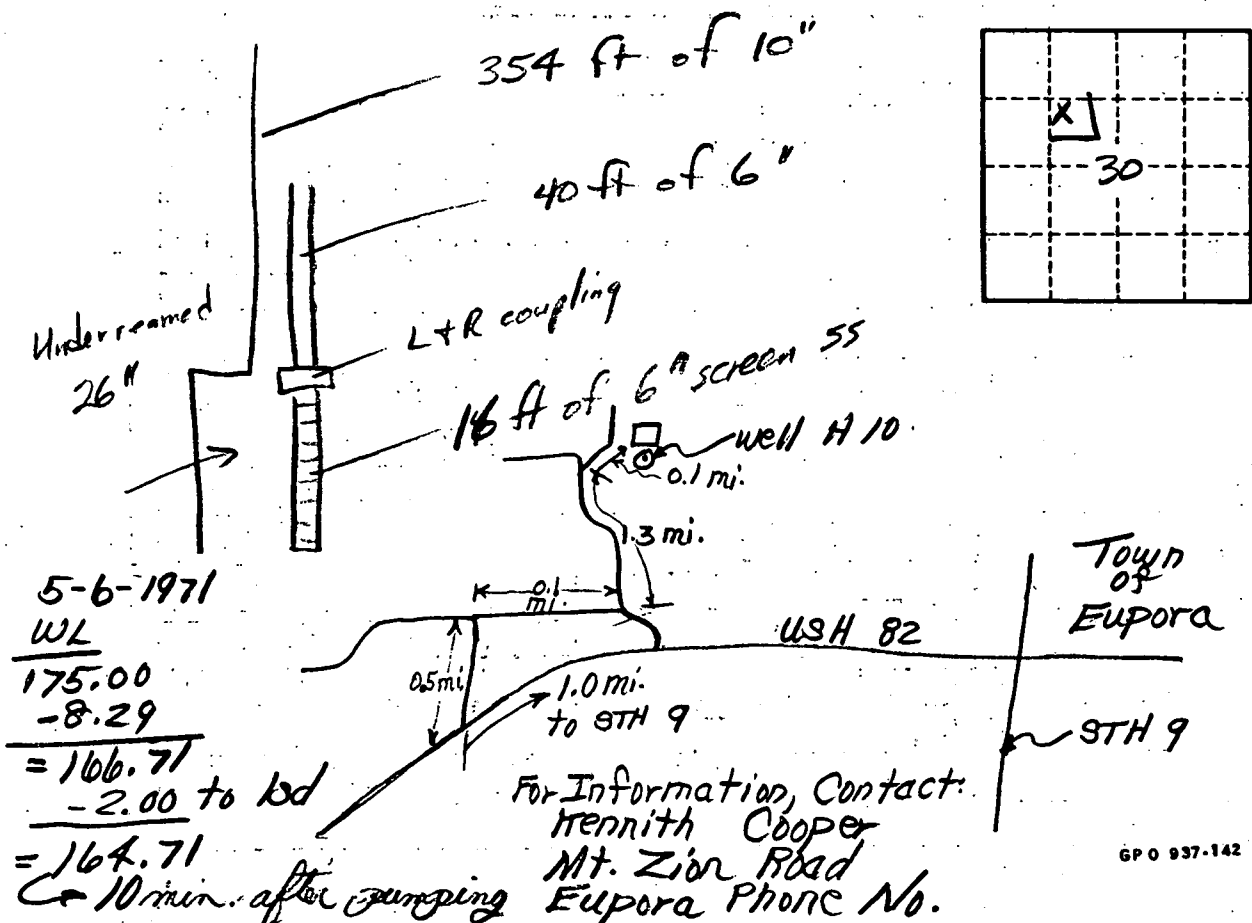

Webster
 H 10
 3-67
 Elec Log
 March 1967

MISSISSIPPI
 BOARD OF WATER COMMISSIONERS
 416 North State Street
 Jackson, Mississippi 39201

coded

WATER WELL DRILLERS LOG
 Robert E. Ruff Co. Webster
 firm name county well located

LANDOWNER: Mt. Zion
 Water Assn.
 Eupora, Miss.
 (mailing address)

WELL LOCATION:
 sec 30 T 20 N R 10 E
 S W
 2 miles N.W. of Eupora
 (distance) (direction) (nearest town)

WELL PURPOSE: Municipal
 (home, irrigation, municipal, industrial)

WELL COMPLETION DATA:
 (1) diameter (inches) 10 x 6
 (2) total depth (feet) 370
 (3) static water level (feet) 158 below above top of ground.
 (4) casing Bl. St. 354' (material) (depth)
 10" (size) If telescope see back.
 (5) screen 16' 354' (length) (depth to top)
 6" (size) S.S. (material)
 (6) pump 20 (HP) 80 (yield gpm)
 El Meter (type power) (uses elec #15)
 (7) electric log yes - on test well (yes or no) (H13)
 M. E. S. (organization running log)
 (8) how well bottom plugged BRV.

description of formations encountered	from	to
Red Clay	0	24
Red clay + shale	24	46
Blue Clay	46	69
Clay + sand	69	92
sand + clay streaks	92	115
shale	115	182
shale + rocks	182	269
shale	269	355
sand	355	369
shale	369	371

CODED



DRILLERS REMARKS:

①

If well telescopes please sketch and show depths.

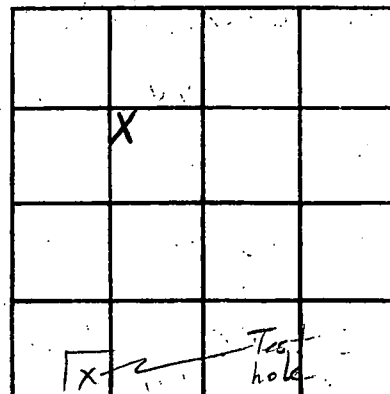
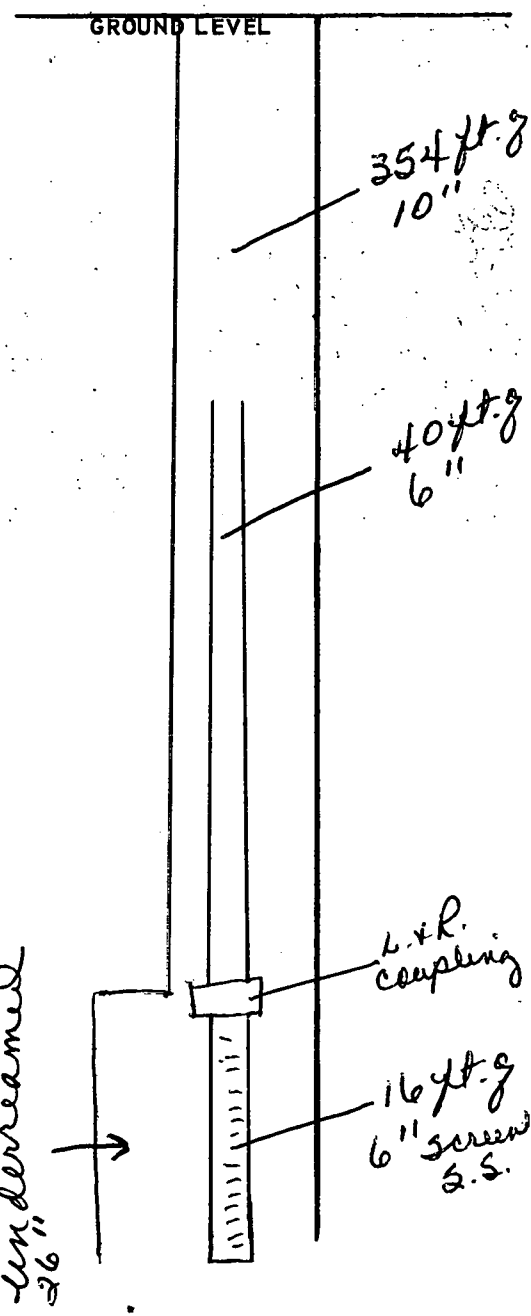

SECTION 30

Please indicate well location X.

ADDITIONAL INFORMATION

Blank lined area for additional information.

If more than one screen, show locations of each on sketch.