

WELL SCHEDULE

U. S. DEPT. OF THE INTERIOR

GEOLOGICAL SURVEY

WATER RESOURCES DIVISION

MASTER CARD

Record by E.J. Harvey Source of data _____ Date 11-11-54 Map Readland

State Mississippi 28 County (or town) Washington 76

Latitude: 33° 05' 39" N Longitude: 091° 08' 06" W Sequential number: 1

Lat-long accuracy: 2 T. 14 S. R. 9 Sec 2, Irregular

Local well number: R0030214N09W Other number: _____ B & M

Local use: _____ Owner or name: Mrs W.F. Elkas

Owner or name: MRS W F ELKAS Address: Chatham

Ownership: County, Fed Gov't, City, Corp or Co, Private, State Agency, Water Dist _____

Use of water: (A) Air cond, (B) Bottling, (C) Comm, (D) Dewater, (E) Power, (F) Fire, (H) Dom, (I) Irr, (M) Med, (N) Ind, (P) S, (R) Rec, (S) Stock, (T) Instit, (U) Unused, (V) Repressure, (W) Recharge, (X) Desal-P S, (Y) Desal-other, (Z) Other _____

Use of well: (A) Anode, (D) Drain, (G) Seismic, (H) Heat Res, (I) Obs, (F) Oil-gas, (R) Recharge, (T) Test, (U) Unused, (W) Withdraw, (X) Waste, (Z) Destroyed _____

DATA AVAILABLE: Well data _____ Freq. W/L meas.: φ Field aquifer char. _____

Hyd. lab. data: _____

Qual. water data; type: USGS Complete

Freq. sampling: _____ Pumpage inventory: _____

Aperture cards: _____

Log data: _____

WELL-DESCRIPTION CARD

SAME AS ON MASTER CARD Depth well: 60.7 ft 61 Meas. accuracy _____

Depth cased: (first perf.) 55 ft 55 Casing type: iron; Diam. 1/4 in

Finish: porous concrete, gravel w. (perf.), (screen), (H) horiz. open gallery, end, (P) perf., (S) screen, (T) pt., (W) shored, (X) open hole, (Z) other _____

Method Drilled: (A) air rot, (B) bored, (C) cable, (D) dug, (H) hyd jetted, (J) air rot., (P) percussion, (R) rotary, (T) reverse, (U) air driven, (W) wash, (Z) other _____

Date Drilled: _____ Pump intake setting: _____ ft _____

Driller: _____ name _____ address _____

Lift (type): (A) air, (B) bucket, (C) cent, (J) jet, (L) multiple, (M) multiple, (N) none, (P) piston, (R) rot, (S) submerg, (T) turb, other _____ Deep _____ Shallow _____

Power (type): diesel, elec, gas, gasoline, hand, LP gas, wind; H.P. Pitcher Trans. or meter no. _____

Descrip. MP Mouth of pump which is 2.5' above ft below LSD. Alt. MP _____

Alt. LSD: 115 115 Accuracy: (source) Tapo

Water Level 30.67 ft above below MP; Ft. above below LSD 28 Accuracy: Tapo

Date meas: 11-11-54 N54 Yield: _____ gpm _____ Method determined _____

Drawdown: _____ ft _____ Accuracy: _____ Pumping period _____ hrs _____

QUALITY OF WATER DATA: Iron _____ Sulfate _____ Chloride _____ Hard. 296

Sp. Conduct 800 K x 10 4 Temp. _____ °F _____ Date sampled 7-29-65 7.65

Taste, color, etc. iron taste; clear pH = 7.2 HCO₃ = 432 (7-65)

Well No. NW

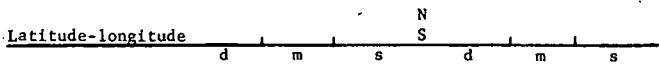

HYDROGEOLOGIC CARD

NAME AS ON MASTER CARD: Physiographic Province: Coastal Plain 03 Section: Miss. River

Local plain E Drainage Basin: 151 Subbasin: 26

of site: (D) depression, stream channel, dunes, flat, hilltop, sink, swamp, (V) offshore, pediment, hillside, terrace, undulating, valley flat

PERIOD: Quaternary, Pleistocene Q1G Miss. River alluvium M1A

Geology: sand - alluvium B1A Origin: Fluvial 2 Aquifer Thickness: ft

Length of well open to: 6 ft 6 Depth to top of: ft

PERIOD:

Geology: Origin: Aquifer Thickness: ft

Length of well open to: ft Depth to top of: ft

Yields: 55 - 60.7 ft

Depth to consolidated rock: ft Source of data:

Depth to cement: ft Source of data:

Hydraulic characteristics: Infiltration characteristics:

Efficient storage: gpd/ft Coefficient Storage:

Efficient storage: gpd/ft²; Spec cap: gpm/ft; Number of geologic cards:

Source: S. T. Kimbrough, Glen Allan

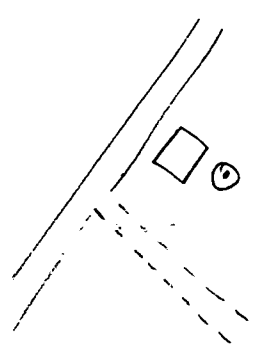

Formerly a school house

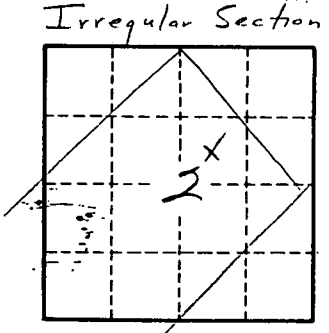

7.6 mi NW Glen Allan

Well No.

R3