

WELL SCHEDULE

167A

U. S. DEPT. OF THE INTERIOR

GEOLOGICAL SURVEY

WATER RESOURCES DIVISION

MASTER CARD

Record by WT. Oakley Source of data Mrs Jones Date 11-2-67 Map Auter

State 28 County (or town) 76

Latitude: 33 10 53 N Longitude: 09 04 16 Sequential number: 1

Lat-long accuracy: 2 T. 15 S. R. 5 Sec. 2, NE 1, NW 1

Local well number: 0033 ABOZ15NOSW Other number: B & M

Local use: _____ Owner or name: Dave Jones

Owner or name: DAVE JONES Address: _____

Ownership: County, Fed Gov't, City, Corp or Co, Private, State Agency, Water Dist P

Use of water: (A) Air cond, Bottling, Comm, Dewater, Power, Fire, Irr, Med, Ind, P S, Rec, (S) Stock, Instit, Unused, Repressure, Recharge, Desal-P S, Desal-other, Other H

Use of well: (A) Anode, Drain, Seismic, Heat Res, Obs, Oil-gas, Recharge, Test, Unused, Withdraw, Waste, Destroyed W

DATA AVAILABLE: Well data Freq. W/L meas.: Original Field aquifer char.

Hyd. lab. data: _____

Qual. water data; type: _____

Freq. sampling: NONE Pumpage inventory: yes, no, period: _____

Aperture cards: _____ yes

Log data: Driller's log to 890 D

WELL-DESCRIPTION CARD

SAME AS ON MASTER CARD Depth well: 881 ft Meas. accuracy 3

Depth cased: 861 ft Casing type: _____; Diam. 4.2 in 4

Finish: (C) porous concrete, (F) gravel w. (screen), (G) gravel w. (green), (H) horiz. gallery, (I) open end, (P) perf., (S) screen, (T) sd. pt., (W) shorec, (X) open hole, (Z) other S

Method Drilled: (A) air rot, (B) bored, (C) cable, (D) dug, (H) hyd rot, (J) jetted, (P) air percussion, (R) reverse, (T) trenching, (V) driven, (W) drive wash, (Z) other H

Date Drilled: Oct 1967 9.6.7 Pump intake setting: _____ ft _____

Driller: Dyar Well Service, Greenville Miss.

Lift (type): (A) air, (B) bucket, (C) cent, (J) jet, (L) multiple, (M) multiple, (N) none, (P) piston, (R) rot, (S) submerg, (T) turb, (Z) other S Deep Shallow

Power (type): (nat) diesel, elec, gas, gasoline, hand, gas, wind; H.P. 2 LP T Trans. or meter no. _____

Descrip. MP _____ ft above LSD. Alt. MP _____

Alt. LSD: 105 1105 Accuracy: topo 3

Water Level: 15.47 ft above MP; 115 ft below LSD Accuracy: taped A

Date meas: 11-2-67 N. 6. 7 Yield: _____ gpm 35 Method determined _____

Drawdown: _____ ft Accuracy: _____ Pumping period _____ hrs _____

QUALITY OF WATER DATA: Iron _____ Sulfate _____ Chloride _____ Hard. _____

Sp. Conduct 425 K x 10⁶ 3 Temp. _____ °F Date sampled 3-4-69

Taste, color, etc. _____

Well No.

033

Latitude-longitude N
S
d m s d m s

GEOLOGIC CARD

NAME AS ON MASTER CARD Physiographic Province: Coastal Plain 03 Section: Miss River

Plain E Drainage Basin: 115H Subbasin: 26

of depression, stream channel, dunes, flat, hilltop, sink, swamp, site: (D) (C) (E) (F) (H) (K) (L) (V) (V)
offshore, pediment, hillside, terrace, undulating, valley flat 27 V

PERIOD: Tertiary, Eocene TIE Sparta Sand SIS
system series aquifer, formation, group

Geology: Unconsolidated sd UIS Origin: Deltaic 3 Aquifer Thickness: _____ ft

05 Length of well open to: _____ ft 20 Depth to top of: _____ ft 785

PERIOD: Quat., Pleist. Miss. River alluvium
system series aquifer, formation, group

Geology: sd-grl alluv. 2 Origin: Fluv. 2 Aquifer Thickness: 161 ft

0 Length of well open to: 0 ft 34 Depth to top of: 34 ft 57 59

Values noted: 861-881 ft 20' x 2" SS

Depth to consolidated rock: _____ ft 60 63 Source of data: _____ 64
Depth to cement: _____ ft 65 68 Source of data: _____ 69
Infiltration characteristics: _____ 70 71 Infiltration characteristics: _____ 72
Efficient storage: _____ gpd/ft 73 75 Coefficient Storage: _____ 76 78
Efficient storage: _____ gpd/ft²; Spec cap: _____ gpm/ft; Number of geologic cards: _____ 79

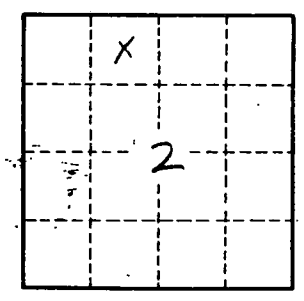
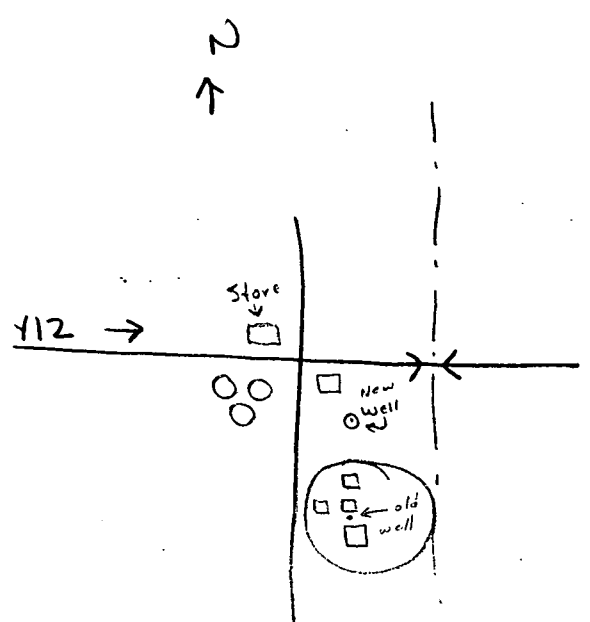

WL 35.00'
- 18.93

16.07
- .60 MP

15.47' GL

Well No. 033