

WELL SCHEDULE

U. S. DEPT. OF THE INTERIOR

GEOLOGICAL SURVEY

WATER RESOURCES DIVISION

MASTER CARD

REA

Record by E.J. Harvey Source of data Mr McCollum Date 12-9-53 Map Auler

State Mississippi County Washington

Latitude: 33 10 58 N Longitude: 090 44 29

Lat-long accuracy: 20 15 S, R 5 Sec 5 NW 1/4, NW 1/4, NW 1/4

Local well number: 0001BB0515N05W

Local use: Owner or name: Wade McCollum

Owner or name: WADE MCCOLLUM Address: Hollandale

Ownership: County, Fed Gov't, City, Corp or Co, Private, State Agency, Water Dist

Use of water: Air cond, Bottling, Comm, Dewater, Power, Fire, Dom, Ref, Med, Ind, P S, Rec

Use of well: Anode, Drain, Seismic, Heat Res, Obs, Oil-gas, Recharge, Test, Unused, Withdraw, Waste, Destroyed

DATA AVAILABLE: Well data, Freq. W/L meas., Field aquifer char.

Hyd. lab. data:

Qual. water data; type:

Freq. sampling: Pumpage inventory: yes no, period:

Aperture cards: yes

Log data:

WELL-DESCRIPTION CARD

SAME AS ON MASTER CARD Depth well: 100 ft

Depth cased: 75 ft Casing type: Diam. 18, 8 in

Finish: porous concrete, gravel w. (perf.), (screen), (horiz. gallery), (open end), (perforated), (screen), (sd. pt.), (shored), (open hole), (other)

Method: air bored, cable, dug, hyd rot, jetted, air percussion, rotary, reverse trenching, driven, drive wash, other

Date Drilled: 1951 9 5 1 Pump intake setting: ft

Driller: Tom Finley Shaw Miss

Lift (type): air, bucket, cent, jet, multiple, multiple, none, piston, rot, submerg, turb, other

Power (type): diesel, nat gas, gasoline, hand, gas, wind; H.P. 50

Descrip. MP Lower side hole in east side 559, 1 ft above LSD. Alt. MP

Alt. LSD: 100 + 100 Accuracy: (source) Tapped

Water Level: 18.40 ft above below MP; Ft. below LSD Accuracy: Tapped

Date meas: 12-9-53 Yield: 1360 gpm 1360 Method determined

Drawdown: ft Accuracy: Pumping period hrs

QUALITY OF WATER DATA: Iron Sulfate Chloride Hard.

Sp. Conduct K x 10 Temp. 65 F Date sampled

Taste, color, etc. T=65 F

Well No.

HYDROGEOLOGIC CARD

NAME AS ON MASTER CARD: Coastal Plain Province: 03 Section: Miss. River

all plain E Drainage Basin: 15H Subbasin: 26

of depression, stream channel, dunes, flat, hilltop, sink, swamp, site: (D) (C) (E) (F) (H) (K) (L) (O) (P) (S) (T) (U) (V) V
offshore, pediment, hillside, terrace, undulating, valley flat

PERIOD: Quaternary, Pleistocene Q.G Miss. River alluvium M.A
system series aquifer, formation, group

Geology: Sand-gravel alluvium 9A Origin: Fluvial 2 Aquifer Thickness: 2 ft

Length of well open to: 25 ft Depth to top of: 25 ft

PERIOD:
system series aquifer, formation, group

Geology: Origin: Aquifer Thickness: ft

Length of well open to: ft Depth to top of: ft

Observations: 75-100 ft 25' x 8"

Height to consolidated rock: ft Source of data:

Height to cement: ft Source of data:

Hydrological characteristics: Infiltration characteristics:

Efficiency: gpd/ft Coefficient Storage:

Efficiency: gpd/ft²; Spec cap: gpm/ft; Number of geologic cards:

M. Turbine AL6817

cell tipped

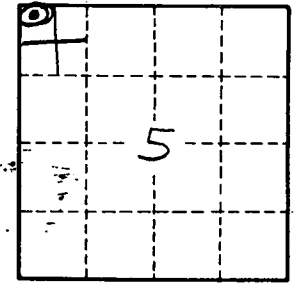
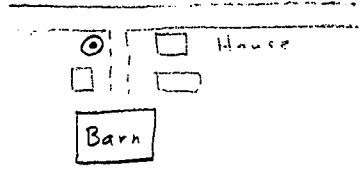
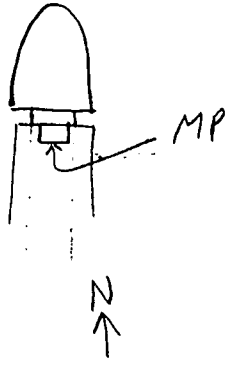

6.4 mi E Hollandale

Well No.

REPRODUCED FROM ORIGINAL