

6/77 WTO

TRANSMITTED FOR ADF

Recorded by WTO  
Date 10/31/78

U.S. GEOLOGICAL SURVEY  
WATER RESOURCES DIVISION  
MISSISSIPPI DISTRICT  
WELL RECORD

JAN 1979

Well No. P90  
E-Log No. \_\_\_\_\_  
County WASHINGTON

Site ID 331026090470701 R=0\* T=A\* 2=W\*

GEN. SITE DATA

Data reliab. 3-U\* Report. agency 4-USGS\* Dist. 6-28\* 7-28\* Co. 8-151\*  
Lat. \_\_\_\_\_ Long. 9-331026090470701\* Well No. 12-P080\*  
Location N13-SESE 02 T 15N R 06W\* Alt. 16-106.\*  
Hyd. Unit (OWDC) 20-\_\_\_\_\_\* Date 21-0312311978\*  
Well use 23-W\* Water Use 24-I\* Hole depth 27-130.\* Well depth 28-130.\*  
WL 30-19.\* Date 31-0312311978\* Source 33-D\*  
Status 273-\_\_\_\_\_\* Project No. 5-\_\_\_\_\_\*

OWNER

R=158\* T=A\* Date 159#0312311978\* Owner No. \_\_\_\_\_  
Owner 161-BILLY R HARRIS\*

FIELD ON

R=192\* T=A\* Date 193# / / \* Temp. 196#00010\* 197- . . . \*  
R=192\* T=A\* Date 193# / / \* Cond. 196#00095\* 197- . . . \*  
R=192\* T=A\* Date 193# / / \* pH 196#00400\* 197- . . . \*

CONSTR.

R=58\* T=A\* 59#1\* Date 60-0312611978\* Remarks \_\_\_\_\_  
Drig. 63-06A\* Name Jayne Method 65-R\* Finish 66-S\*

CASING

R=76\* T=A\* 59#1\*  
Top csgn. 77# 0.\* Bot. csgn. 78# 8.0.\* Diam. 79# 1.6.\*  
R=76\* T=A\* 59#1\*  
Top csgn. 77# . . . \* Bot. csgn. 78# . . . \* Diam. 79# . . . \*

OPENINGS

R=82\* T=A\* 59#1\* Top 83# 8.0.\* Bottom 84# 1.30.\*  
Type 85-L\* Diam. 87-1.6.\* Size 88- . . . \*  
R=82\* T=A\* 59#1\* Top 83# . . . \* Bottom 84# . . . \*  
Type 85- . . . \* Diam. 87- . . . \* Size 88- . . . \*

YIELD

R=146\* T=A\* 147# 1\* Q 150= 1800.\* Q/S 272= . . . \*

134 flows 146 pumped

LIFT

R=42\* T= A \* Lift type 43# T\* Intake 44= \* Power type 45= E\*

Date 38= 03/23/1978\* H.P. 46= 30.\*

LOGS

R=198\* T= A \* Log 199# D\* Top 200= 0.\* Bot 201= 130.\*

R=198\* T= A \* Log 199# \* Top 200= \* Bot 201= \*

R=189\* T= A \* E Log No. 190# \* 191= M I S S D I S T \*

ANAL.

R=114\* T= A \* Year 115# \* Type 120= \*

R=90\* T= A \* 256# 1 \* Top 91= 40.\* Bot 92= 130.\*

Unit ID 93= 12 MRVA \* Name of Unit

R=90\* T= A \* 256# 1 \* Top 91= \* Bot 92= \*

Unit ID 93= \* Name of Unit

HYDRAULICS

R=98\* T= A \* 99# 1 \* Unit tested 100= \* 103= \*

R=105\* T= A \* 99# 1 \* Test No. 106# \*

107= \* Transmissivity (gal/d)/ft

108= \* Hydraul. cond. (gal/d)/ft<sup>2</sup>

110= \* Storage coeff. Boundaries

R=121\* T= \* Yr Begin 122# \*

Water Level Data Collection (1)

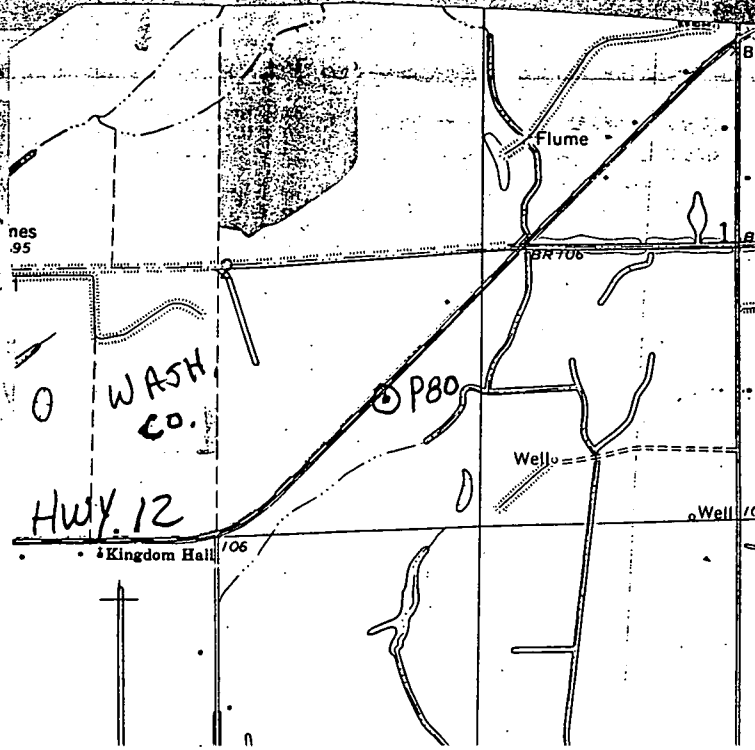

description of fomations encountered	from	to
Clay	0	40
Coarse Sand	40	70
Fine Sand	70	76
Coarse Sand & Pea Gr	76	110
Coarse Sand & Gravel	110	130