

### WELL SCHEDULE

U. S. DEPT. OF THE INTERIOR

GEOLOGICAL SURVEY

WATER RESOURCES DIVISION

#### MASTER CARD

Record by B.E. Wasson Source of data Obs Date 4-27-62 Map Swan Lake

State Mississippi 28 County (or town) Washington 76

Latitude: 33° 09' 57" N Longitude: 090° 49' 47" W Sequential number: 1

Lat-long accuracy: 2 T. 15 S. R. 6 Sec 9, NW NW

Local well number: P 039 B B 09 15 N 06 W Other number: B & M

Local use: \_\_\_\_\_ Owner or name: Owen Barrfield

Owner or name: OWEN BAREFIELD Address: \_\_\_\_\_

Ownership: County, Fed Gov't, City, Corp or Co, Private, State Agency, Water Dist P

Use of water: (A) Air cond, (B) Bottling, (C) Comm, (D) Dewater, (E) Power, (F) Fire, (G) Irr, (H) Med, (I) P S, (J) Rec, (K) Stock, (L) Instit, (M) Unused, (N) Reppure, (O) Recharge, (P) Desal-P S, (Q) Desal-other, (R) Other H

Use of well: (A) Anode, (B) Drain, (C) Seismic, (D) Heat Res, (E) Obs, (F) Oil-gas, (G) Recharge, (H) Test, (I) Unused, (J) Withdraf, (K) Waste, (L) Destroyed W

DATA AVAILABLE: Well data  Freq. W/L meas.:  Field aquifer char.

Hyd. lab. data: \_\_\_\_\_

Qual. water data; type: USGS (field)

Freq. sampling:  Pumpage inventory: no, period: \_\_\_\_\_

Aperture cards: \_\_\_\_\_

Log data: \_\_\_\_\_

#### WELL-DESCRIPTION CARD

SAME AS ON MASTER CARD Depth well: 40 ft 40 Meas. rept. accuracy D

Depth cased: 37 ± ft 37 Casing type: \_\_\_\_\_; Diam. 1 1/4 in 1

Finish: (C) porous concrete, (F) gravel w. (perf.), (G) gravel w. (screen), (H) horiz. gallery, (I) open end, (J) perf., (K) screen, (L) sd. pt., (M) shored, (N) open hole, (O) other T

Method: (A) air rot, (B) bored, (C) cable, (D) dug, (E) hyd jetted, (F) air rot., (G) percussion, (H) rotary, (I) reverse trenching, (J) driven, (K) wash, (L) other Y

Date Drilled: \_\_\_\_\_ Pump intake setting: \_\_\_\_\_ ft \_\_\_\_\_

Driller: \_\_\_\_\_

Lift (type): (A) air, (B) bucket, (C) cent, (D) jet, (E) multiple (cent.), (F) multiple (turb.), (G) none, (H) piston, (I) rot, (J) submerg, (K) turb, (L) other P Deep  Shallow

Power (type): (A) diesel, (B) elec, (C) gas, (D) gasoline, (E) hand, (F) gas, (G) wind, (H) H.P. Pitcher 1 Trans. or meter no. \_\_\_\_\_

Descrip. MP Mouth of pump 1.5 ft above LSD. Alt. MP 112.5

Alt. LSD: 111 11111 Accuracy: Topo 3

Water Level 15.82 ft above MP; Ft above LSD 14 Accuracy: Taped A

Date meas: 4-27-62 462 Yield: \_\_\_\_\_ gpm \_\_\_\_\_ Method determined \_\_\_\_\_

Drawdown: \_\_\_\_\_ ft \_\_\_\_\_ Accuracy: \_\_\_\_\_ Pumping period \_\_\_\_\_ hrs \_\_\_\_\_

QUALITY OF WATER DATA: Iron \_\_\_\_\_ Sulfate \_\_\_\_\_ Chloride 31 2 Hard. 462 7

Sp. Conduct 420 K x 10<sup>6</sup> 3 Temp. 65 °F 65 Date sampled 4-27-62 462

Taste, color, etc. pH = 7.0 Clear

Well No. P 39

Latitude-longitude N  
S  
d m s d m s

HYDROGEOLOGIC CARD

NAME AS ON MASTER CARD Physiographic Province: Coastal Plain 03 Section: Miss. River

19 plain E Drainage Basin: 15H Subbasin: 26

(D) (C) (E) (F) (H) (K) (L) of depression, stream channel, dunes, flat, hilltop, sink, swamp, site: (O) (P) (S) (T) (U) (V) offshore, pediment, hillside, terrace, undulating, valley flat 27 Y

PER: Quaternary, Pleistocene QG Miss. River alluvium MA aquifer, formation, group 30 31

ology: sand - alluvium BA Origin: Fluvial 2 Aquifer Thickness: ft

Length of well open to: 31 ft 38 40 Depth to top of: ft 41 43

PER: system series aquifer, formation, group Aquifer Thickness: ft

ology: Origin: 50

Length of well open to: ft 54 56 Depth to top of: ft 57 59

ervals: 37-40 ft screen length assumed

h to consolidated rock: ft 60 63 Source of data: 64

h to ment: ft 65 68 Source of data: 69

icial rial: 70-71 Infiltration characteristics: 72

efficient s: gpd/ft 73 75 Coefficient Storage: 76 78

efficient gpd/ft<sup>2</sup>; Spec cap: gpm/ft; Number of geologic cards: 79

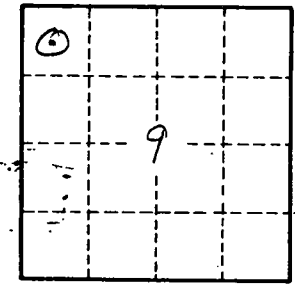
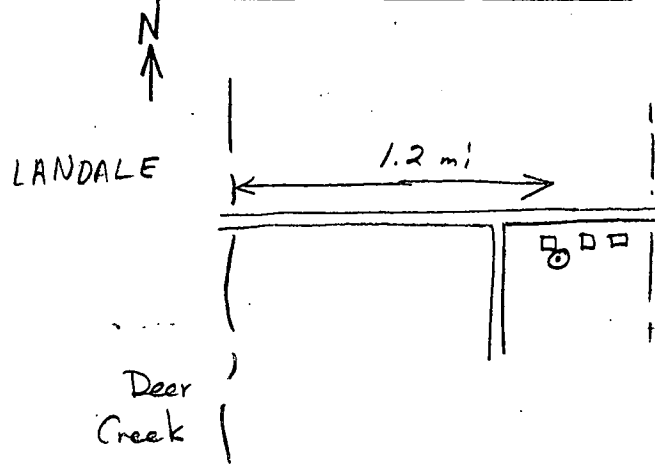

Well No. P39