

### WELL SCHEDULE

U. S. DEPT. OF THE INTERIOR

GEOLOGICAL SURVEY

WATER RESOURCES DIVISION

#### MASTER CARD

Record by W.T. Oakley Source of data Owner Date 11-3-67 Map Swan Lake

State Mississippi 28 County (or town) Washington 76

Latitude: 33° 07' 01" N Longitude: 070° 05' 15" E Sequential number: 2

Lat-long accuracy: 2 T. 15 S. R. 7 W. Sec 25, NE 1/4, SE 1/4, B & M

Local well number: 0018AD2515N07W Other number: \_\_\_\_\_

Local use: \_\_\_\_\_ Owner or name: EG. GANIER

Owner or name: E G GANIER Address: Hollandale, Miss.

Ownership: (C) County, (F) Fed Gov't, (M) City, Corp or Co, (N) Private, (S) State Agency, (W) Water Dist P

Use of water: (A) Air cond, (B) Bottling, (C) Comm, (D) Dewater, (E) Power, (F) Fire, (H) Dom, (I) Irr, (M) Med, (N) Ind, (P) S, (R) Rec, (S) Stock, (T) Instit, (U) Unused, (V) Recharge, (W) Desal-P S, (X) Desal-other, (Y) Other H

Use of well: (A) Anode, (D) Drain, (G) Seismic, (H) Heat Res, (O) Obs, (P) Oil-gas, (R) Recharge, (T) Test, (U) Unused, (W) Withdraw, (X) Waste, (Z) Destroyed W

DATA AVAILABLE: Well data  Freq. W/L meas.: original  Field aquifer char.

Hyd. lab. data: \_\_\_\_\_

Qual. water data; type: USGS Complete

Freq. sampling: original  Pumpage inventory: yes  no, period: \_\_\_\_\_

Aperture cards: \_\_\_\_\_ yes

Log data: \_\_\_\_\_

#### WELL-DESCRIPTION CARD

SAME AS ON MASTER CARD Depth well: 800 ft 800 Meas. rept. accuracy 6

Depth cased; (first perf.) \_\_\_\_\_ ft \_\_\_\_\_ Casing type: \_\_\_\_\_; Diam. 4 in 4

Finish: (C) porous concrete, (F) gravel w. (perf.), (G) gravel w. (screen), (H) horiz. gallery, (O) open end, (P) perf., (S) screen, (T) sd. pt., (W) shored, (X) open hole, (Z) other S

Method Drilled: (A) air rot., (B) bored, (C) cable, (D) dug, (H) hyd rot., (J) jetted, (P) air perc., (R) reverse, (T) trenching, (U) driven, (W) drive wash, (Z) other H

Date Drilled: 1964 964 Pump intake setting: \_\_\_\_\_ ft \_\_\_\_\_

Driller: Bailey Drilling Co. Greenville Miss.

Lift (type): (A) air, (B) bucket, (C) cent, (J) jet, (L) multiple, (M) multiple, (N) none, (P) piston, (R) rot., (S) submerg., (T) turb., (Z) other S Deep  Shallow

Power (type): (nat) diesel  gas, (LP) gasoline, hand, gas, wind; H.P. 2 7 Trans. or meter no. \_\_\_\_\_

Descrip. MP \_\_\_\_\_ above ft below LSD. Alt. MP \_\_\_\_\_

Alt. LSD: 111.05 \_\_\_\_\_ Accuracy: instrument 4

Water Level: 22.90 ft above below MP; 23 ft above below LSD Accuracy: measured A

Date meas: 11-3-67 N:67 Yield: \_\_\_\_\_ gpm \_\_\_\_\_ Method determined \_\_\_\_\_

Drawdown: \_\_\_\_\_ ft \_\_\_\_\_ Accuracy: \_\_\_\_\_ Pumping period \_\_\_\_\_ hrs \_\_\_\_\_

QUALITY OF WATER DATA: Iron 0.30 Sulfate \_\_\_\_\_ Chloride 19 Hard 2

449 Sp. Conduct 755 K x 10<sup>6</sup> 4 Temp. 68 °F 68 Date sampled Feb 19, 1968 268

Taste, color, etc. Field PH: 8.7

Well No. 018

Latitude-longitude N  
S  
d m s d m s

**GEOLOGIC CARD**

NAME AS ON MASTER CARD Physiographic Province: Coastal Plain Section: Miss. River

1 Plain E Drainage Basin: 115 J Subbasin: 03

of depression, stream channel, dunes, flat, hilltop, sink, swamp, site: (D) (C) (E) (F) (H) (K) (L) (P) (S) (T) (U) (V) V

R FER: Tertiary, Eocene TIE Sparta Sand 33

ology: UNCONSOLIDATED SAND U3 Origin: Deltaic 3 Aquifer Thickness: ≥ 51 ft

Length of well open to: 30 ft Depth to top of: 691 ft

R FER: QGMA 9A 2 110 ft

ology: 9A 2 110 ft

Length of well open to: 0 ft Depth to top of: 30 ft

ervals cased: 30' x 2 1/2"

h to consolidated rock: 60-63 ft Source of data: 64

n to cement: 65-68 ft Source of data: 69

icial rial: 70-71 Infiltration characteristics: 72

efficient: 73-75 gpd/ft Coefficient Storage: 76-78

efficient: 79 gpd/ft<sup>2</sup>; Spec cap: 79 gpm/ft; Number of geologic cards: 79

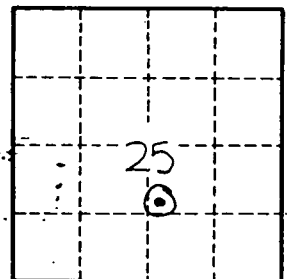
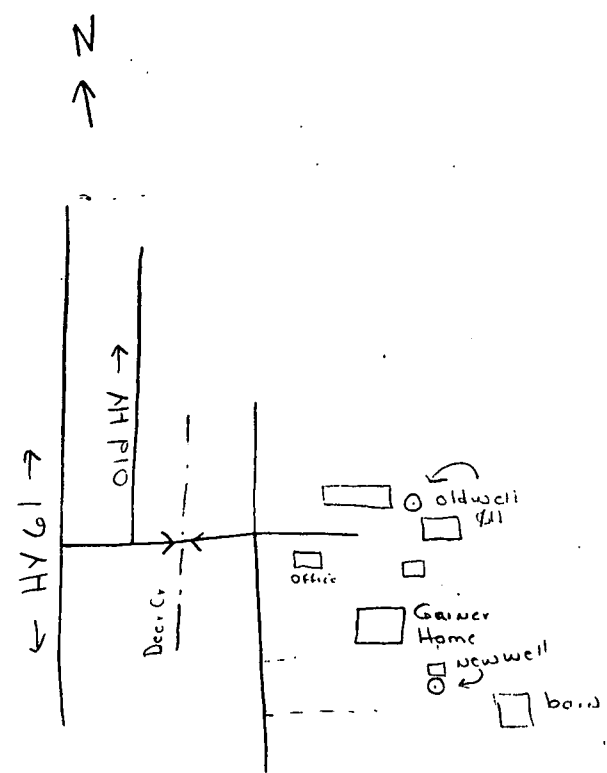

WL 34.00'  
10.40  
23.60  
0.70 MP  
22.90' GL

Well No. 018