

WRD Exp. (GW)
April 1966

Well No. N3

WELL SCHEDULE

U. S. DEPT. OF THE INTERIOR

GEOLOGICAL SURVEY

WATER RESOURCES DIVISION

MASTER CARD

Record by E J. Harvey Source of data _____ Date 11-11-54 Map Readland

State Mississippi County Washington (or town) 76

Latitude: 33° 06' 04" N Longitude: 09° 10' 33" W Sequential number: 7

Lat-long accuracy: 2 T. 15 S. R. 9 Sec 26, SE $\frac{1}{4}$, SW $\frac{1}{4}$, SE $\frac{1}{4}$

Local well number: N003CD2615N09W Other number: _____ B & M

Local use: _____ Owner or name: J. M. Poley

Owner or name: J. M. POLEY Address: Chatham, Miss

Ownership: County, Fed Gov't, City, Corp or Co, Private, State Agency, Water Dist P

Use of water: (A) Air cond, (B) Bottling, (C) Comm, (D) Dewater, (E) Power, (F) Fire, (G) Irr, (H) Med, (I) P S, (M) Rec, (N) P, (R) Stock, (S) Insttit, (T) Unused, (U) Recharge, (V) Desal-P S, (W) Desal-other, (X) Other H

Use of well: (A) Anode, (D) Drain, (G) Seismic, (H) Heat Res, (I) Obs, (J) Oil-gas, (K) Recharge, (L) Test, (M) Unused, (N) Withdraw, (O) Waste, (P) Destroyed W

DATA AVAILABLE: Well data Freq. W/L meas.: Field aquifer char.

Hyd. lab. data: _____

Qual. water data; type: _____

Freq. sampling: _____ Pumpage inventory: yes no period: _____

Aperture cards: _____ yes

Log data: _____

PUNCHED and VERIFIED
ROLLA COMPUTATION BRANCH

WELL-DESCRIPTION CARD

SAME AS ON MASTER CARD Depth well: 33.7 ft 34 ft 0 ft

Depth cased: (first perf.) 30 ft 31 ft Casing type: _____; Diam. 14 in

Finish: porous concrete, gravel w. (perf.), gravel w. (screen), horiz. open gallery, end, other 7

Method: (A) air bored, (B) cable, (C) dug, (D) hyd jetted, (E) air rot., (F) reverse percussion, (G) trenching, (H) driven, (I) wash, (J) other V

Date Drilled: _____ Pump intake-setting: _____ ft

Driller: _____ name _____ address _____

Lift (type): (A) air, (B) bucket, (C) cent, (D) jet, (E) multiple, (F) multiple, (G) none, (H) piston, (I) rot, (J) submerg, (K) turb, (L) other P Deep Shallow

Power (type): diesel, elec, gas, gasoline, (H) hand, gas, wind; H.P. Pitcher 1 Trans. or meter no. _____

Descrip. MP Mouth of Pitcher pump 2.2 ft above below LSD. Alt. MP _____

Alt. LSD: 119.51 ft 120 ft Accuracy: (source) instrument - B.M.

Water Level 28.68 ft above below MP; Ft above below LSD 26 ft Accuracy: _____

Date meas: 11-11-54 N54 Yield: _____ gpm Method determined _____

Drawdown: _____ ft Accuracy: _____ Pumping period _____ hrs

QUALITY OF WATER DATA: Iron _____ ppm Sulfate _____ ppm Chloride _____ ppm Hard. _____ ppm

Sp. Conduct _____ K x 10 6 Temp. _____ °F Date sampled _____

Taste, color, etc. _____

Well No. N3

Well No. N 3

Latitude-longitude N
S
d m s d m s

HYDROGEOLOGIC CARD

SAME AS ON MASTER CARD Physiographic Province: Coastal Plain Section: Miss. River

alluvial plain E Drainage Basin: 157 Subbasin: 26

Topo of well site: (D) (C) (E) (F) (H) (K) (L) (V) V
depression, stream channel, dunes, flat, hilltop, sink, swamp,
(O) (P) (S) (T) (U) offshore, pediment, hillside, terrace, undulating, valley flat

MAJOR AQUIFER: Quaternary, Pleistocene Q6 Miss. River alluvium M1A

Lithology: sand - alluvium B1A Origin: Fluvial 2 Aquifer Thickness: _____ ft

Length of well open to: 31 ft Depth to top of: _____ ft

MINOR AQUIFER: _____ Origin: _____ Aquifer Thickness: _____ ft

Length of well open to: _____ ft Depth to top of: _____ ft

Intervals Screened: 30 - 33 ft

Depth to consolidated rock: _____ ft Source of data: _____

Depth to basement: _____ ft Source of data: _____

Surficial material: _____ Infiltration characteristics: _____

Coefficient Trans: _____ gpd/ft Coefficient Storage: _____

Coefficient Perm: _____ gpd/ft²; Spec cap: _____ gpm/ft; Number of geologic cards: _____

WL 23.92' GL (4-1-55)
Hydrant in yard.

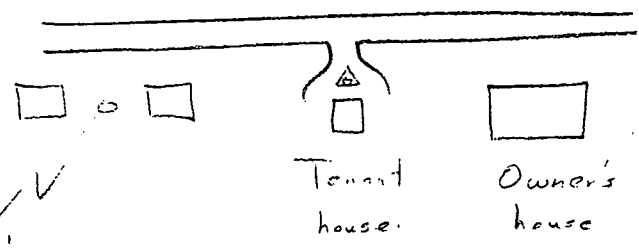
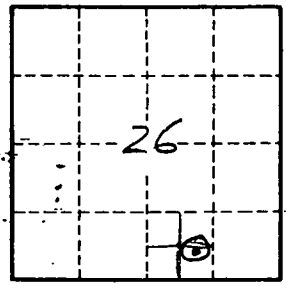

WL 26.06' MP (2.0 ft) MOP
4-1-55

Well No. N 3