

WELL SCHEDULE

U. S. DEPT. OF THE INTERIOR

GEOLOGICAL SURVEY

WATER RESOURCES DIVISION

MASTER CARD

Record by E. J. Harvey Source of data Mr. Jones Date 8-5-54 Map Swan Lake

State Mississippi 28 County (or town) Washington 76

Latitude: 33 15 00 N Longitude: 09 05 14 1 Sequential number: 1

Lat-long accuracy: 2 T. 16 S. R. 6 Sec 7, SW $\frac{1}{4}$, SW $\frac{1}{4}$, NW $\frac{1}{4}$

Local well number: M006CB0716N06W Other well number: S. well #1

Local use: _____ Owner or name: J. T. Manning

Owner or name: J T MANNING Address: E-till

Ownership: County, Fed Gov't, City, Corp or Co, Private, State Agency, Water Dist P

Use of water: (S) (T) (U) (V) (W) (X) (Y) (Z) Row crops I

Use of well: (A) (D) (G) (H) (I) (P) (R) (T) (U) (W) (X) (Z) W

DATA AVAILABLE: Well data Freq. W/L meas.: Field aquifer char.

Hyd. lab. data: _____

Qual. water data; type: _____

Freq. sampling: _____ Pumpage inventory: no; period: _____

Aperture cards: _____

Log data: Driller's log D

WELL-DESCRIPTION CARD

SAME AS ON MASTER CARD Depth well: 107 ft 107 Meas. accuracy 3

Depth cased: (first perf.) 77 ft 77 Casing type: _____; Diam. 8 in 8

Finish: porous concrete, gravel w. (perf.), gravel w. (screen), horiz. open gallery, end, perf., screen, sd. pt., shored, open hole, other F

Method Drilled: (A) (B) (C) (D) (E) (F) (G) (H) (I) (J) (K) (L) (M) (N) (O) (P) (Q) (R) (S) (T) (U) (V) (W) (X) (Y) (Z) H

Date Drilled: July 54 954 Pump intake setting: 60 ft 60

Driller: Merlin Jones Hollandale

Lift (type): (A) (B) (C) (J) multiple, multiple, none, piston, rot, submerg, turb, other T Deep Shallow

Power (type): diesel, elec, gas, gasoline, hand, gas, wind; H.P. Gas 40 B Trans. or meter no. _____

Descrip. MP _____ ft above _____ ft below LSD. Alt. MP _____

Alt. LSD: 114 Accuracy: (source) 3

Water Level 15.5 ft above MP; Ft below LSD 116 Accuracy: Reported D

Date meas: July 1954 754 Yield: 600 gpm 600 Method R_p determined 61

Drawdown: _____ ft _____ Accuracy: _____ Pumping period _____ hrs _____

QUALITY OF WATER DATA: Iron _____ ppm Sulfate _____ ppm Chloride _____ ppm Hard. _____ ppm

Sp. Conduct _____ K x 10⁶ Temp. _____ °F _____ Date sampled _____

Taste, color, etc. _____

Well No. 176

Latitude-longitude N
S
d m s d m s

HYDROGEOLOGIC CARD

NAME AS ON MASTER CARD Physiographic Province: Coastal Plain 03 Section: Miss. River

Drainage Basin: 15H Subbasin: 26

Site: (D) (C) (E) (F) (H) (K) (L) depression, stream channel, dunes, flat, hilltop, sink, swamp, (V) offshore, pediment, hillside, terrace, undulating, valley flat 27

Quaternary, Pleistocene QG Miss. River alluvium MA

Geology: sand-gravel alluvium 9A Origin: Fluvial 2 Aquifer Thickness: 77 ft

Length of well open to: 30 ft 30 Depth to top of: 30 ft 30

System, series, aquifer, formation, group

Origin, Aquifer Thickness

Length of well open to, Depth to top of

Interval: 77-107 ft

Consolidated rock, Source of data, Infiltration characteristics, Coefficient Storage, Spec cap, gpm/ft, Number of geologic cards

Bark Turbine, 6" discharge
3 stage, 8" bowls

50 ft setting
10 ft tailpipe

30' Buckshot
107' Sand & gravel (30-40 fine sand)
107' Hard shale in bottom

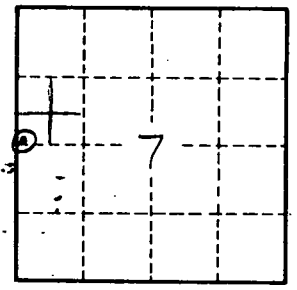

1.6 mi SE Arcola

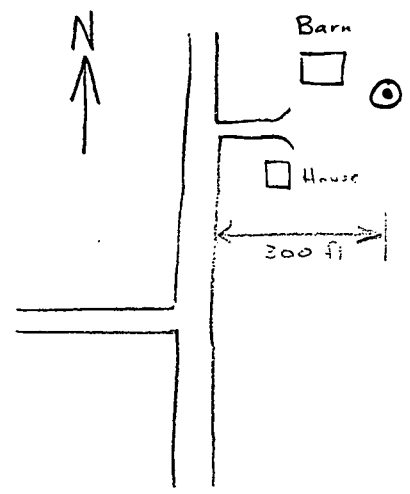

Well No. 116