

6/77 WTO

TRANSMITTED FOR ADP

Recorded by WTO - BEW

3178

Well No. 170

Date 4/8/77 7/6/77

U.S. GEOLOGICAL SURVEY
WATER RESOURCES DIVISION
MISSISSIPPI DISTRICT

E-Log No. 92

County WASH.

WELL RECORD

Site ID 331619090522203 ³
R=0* T=A* 2=W* ARCOLA 1460 QUAD

GEN. SITE DATA
Data reliab. 3=C* Report. agency 4=USGS* Dist. 6=28* 7=28* Co. 8=151*
Lat. 9=331619* 10=0905222* Well No. 12=L070*
Location 13=NENW S 01 T 16 N R 07 W* Alt. 16=120*
Hyd. Unit (OWDC) 20= Date 21=04/08/1977*
Well use 23=W* Water Use 24=P* Hole depth 27=1072* Well depth 28=976*
WL 30=28* Date 31=06/22/1977* Source 33=S* *by tank*
Status 273=Y* Project No. 5=

OWNER
R=158* T=A* Date 159# 08/01/1977* Owner No. 11/14/80
Owner 161=ARCOLA
WL ↓ MP - 33.29
MP - top of pipe from base
2.4' ↑ LSD
WL ↓ LSD - 30.89'

FIELD ON
R=192* T=A* Date 193# 06/22/1977* Temp. 196#00010* 197=27.0*
R=192* T=A* Date 193# 06/22/1977* Cond. 196#00095* 197=710*
R=192* T=A* Date 193# / / pH 196#00400* 197=.

CONSTR.
R=58* T=A* 59# 1* Date 60=08/01/1977* Remarks
Drig. 63=330* Name Herndon Method 65=H* Finish 66=S*

CASING
R=76* T=A* 59# 1*
Top csgn. 77# 0* Bot. csgn. 78=922* Diam. 79# 10*
R=76* T=A* 59# 1*
Top csgn. 77# Bot. csgn. 78=922* Diam. 79# 6*

OPENINGS
R=82* T=A* 59# 1* Top 83# 922* Bottom 84=972*
Type 85=S* Diam. 87=6* Size 88=.025*
R=82* T=A* 59# 1* Top 83# Bottom 84=
Type 85= Diam. 87= Size 88=

YIELD
R=146* T=A* 147# 1* Q 150=400* Q/S 272=
134 flows 146 pumped Q#

R=42* T= A * Lift type 43# T* Intake 44= 120.* Power type 45= E*

DATE 38= 08/01/1977* H.P. 46= 30.*

R=198* T= A * Log 199# D* Top 200= 0.* Bot 201= 990.*

R=198* T= A * Log 199# E* Top 200= 215.* Bot 201= 1072.*

R=189* T= A * E Log No. 190# 09.2* 191= M I S S D I S T *

R=114* T= A * Year 115# * Type 120= *

R=90* T= A * 256# 1 * Top 91= 830.* Bot 92= 1010.*

Unit ID 93= 124 SPRT * Name of Unit

R=90* T= A * 256# 1 * Top 91= * Bot 92= *

Unit ID 93= * Name of Unit

R=98* T= A * 99# 1 * Unit tested 100= * 103= *

R=105* T= A * 99# 1 * Test No. 106# *

107= * Transmissivity (gal/d)/ft

108= * Hydraul. cond. (gal/d)/ft²

110= * Storage coeff. Boundaries

R=121* T= * Yr Begin 122# *

Clay	0	12
Sand	12	15
Clay	15	20
Sand/Coarse	20	115
Gravel	115	135
Clay	135	175
Streaked Clay	175	220
Sand/Clay Streaks	220	360
Sand/Rock @ 350	360	430
Clay	430	433
Sand	433	450
Clay	450	460
Sand/Clay Streaks	460	610
Sand	610	630
Clay	630	663
Sand	663	681
Clay	681	692
Sandy Clay	692	693
Sand/Clay Streaks	693	725
Clay	725	810
Sand	810	880
Clay	880	890

Water Level Data Collection (1)

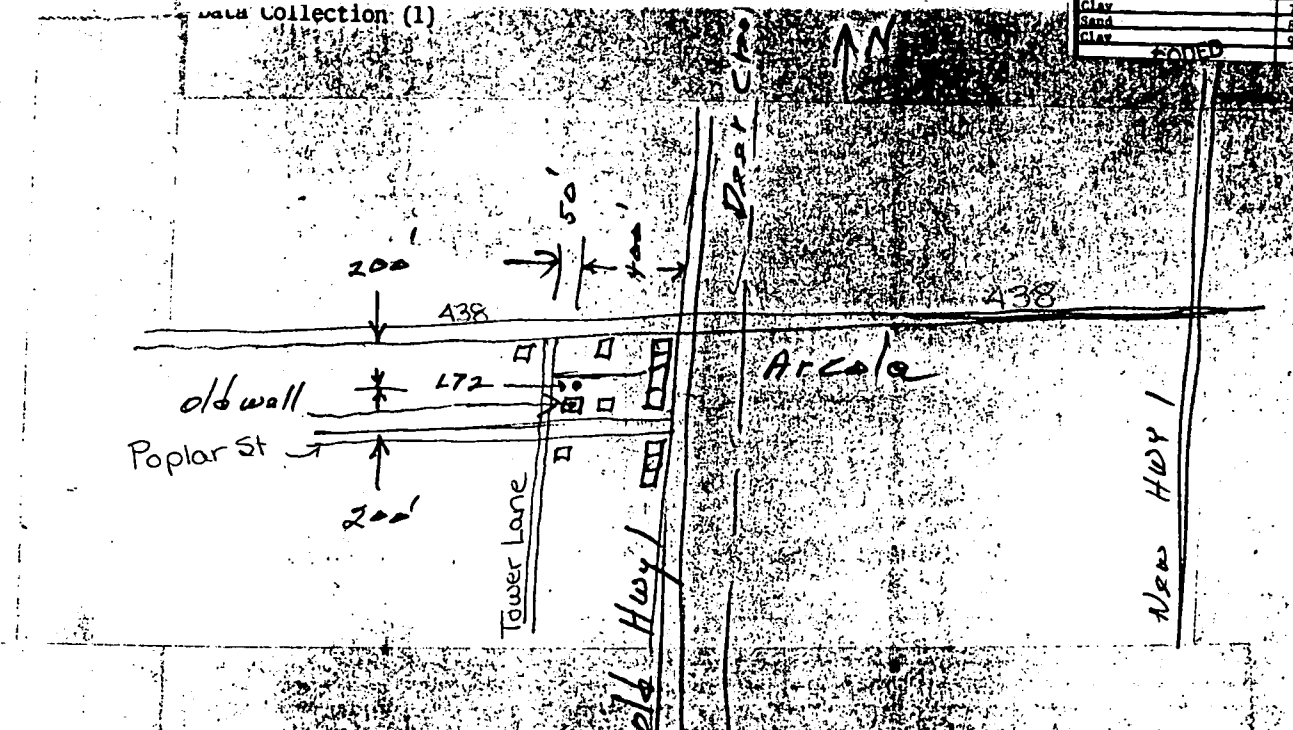

3/21/79
Sp. Cond.
725
11/01/89
37.55
11/4/80
30.89
6/6/95
36.90