

WELL SCHEDULE

U. S. DEPT. OF THE INTERIOR

GEOLOGICAL SURVEY

WATER RESOURCES DIVISION

MASTER CARD

Record by E. J. Harvey Source of data H. E. Bennett Date 1-15-54 Map Swan Lake

State Mississippi County (or town) Washington

Latitude: 33° 14' 01" N Longitude: 090° 52' 46" W Sequential number: 1

Lat-long accuracy: 2 T. 16 S, R 7 Sec 13, NE $\frac{1}{4}$, NW $\frac{1}{4}$, SW $\frac{1}{4}$

Local well number: L024BC1316N07W Other number: 440000 B & M

Local use: _____ Owner or name: McCUTCHEON Estate

Owner or name: CROWE BROTHERS Address: McCUTCHEON, Miss. Holladale

Ownership: County, Fed Gov't, City, Corp or Co, Private, State Agency, Water Dist P

Use of water: (A) Air cond, (B) Bottling, (C) Comm, (D) Dewater, (E) Power, (F) Fire, (G) Dom, (H) Irr, (I) Med, (J) Ind, (K) P S, (L) Rec, (M) Stock, (N) Instit, (O) Unused, (P) Recharge, (Q) Recharge, (R) Desal-P S, (S) Desal-other, (T) Other H

Use of well: (A) Anode, (B) Drain, (C) Seismic, (D) Heat Res, (E) Obs, (F) Oil-gas, (G) Recharge, (H) Test, (I) Unused, (J) Withdraw, (K) Waste, (L) Destroyed W

DATA AVAILABLE: Well data Freq. W/L meas.: Field aquifer char.

Hyd. lab. data: _____

Qual. water data; type: _____ K

Freq. sampling: _____ Pumpage inventory: yes, no, period: _____

Aperture cards: _____ yes

Log data: Driller's log D

WELL-DESCRIPTION CARD

SAME AS ON MASTER CARD Depth well: 510 ft Meas. 6

Depth cased: 470 ft Casing type: _____; Diám. 6,3 in accuracy 6

Finish: (A) porous concrete, (B) gravel w. (perf.), (C) gravel w. (screen), (D) horiz. gallery, (E) open end, (F) perf., (G) screen, (H) sd. pt., (I) shored, (J) open hole, (K) other G

Method: (A) air, (B) bored, (C) cable, (D) dug, (E) hyd, (F) jetted, (G) air, (H) reverse, (I) trenching, (J) driven, (K) wash, (L) other H

Date Drilled: _____ Pump intake setting: _____ ft _____

Driller: H. E. Bennett, Holladale, Miss.

Lift (type): (A) air, (B) bucket, (C) cent, (D) jet, (E) multiple, (F) multiple, (G) none, (H) piston, (I) rot, (J) submers, (K) turb, (L) other S Deep Shallow

Power (type): (A) diesel, (B) elec, (C) gas, (D) gasoline, (E) hand, (F) gas, (G) wind; H.P. 1 S Trans. or meter no. _____

Descrip. MP _____ ft above below LSD. Alt. MP _____

Alt. LSD: _____ Accuracy: (source) 3

Water Level: 21 ft above below MP; Ft. above below LSD 21 Accuracy: Reported

Date meas: Jan 54 154 Yield: _____ gpm Method determined _____

Drawdown: _____ ft Accuracy: _____ Pumping period _____ hrs _____

QUALITY OF WATER DATA: Iron _____ ppm Sulfate _____ ppm Chloride _____ ppm Hard. _____ ppm

Sp. Conduct 1300 K x 10 5 Temp. °F 73 Date sampled 568

Taste, color, etc. Colored water

Well No. 124

Latitude-longitude N
S
d m s d m s

HYDROGEOLOGIC CARD

NAME AS ON MASTER CARD Physiographic Province: Coastal Plain 03 Section: Miss. River

all plain E Drainage Basin: 15J Subbasin: 26

(D) depression, stream channel, dunes, flat, hilltop, sink, swamp, site: (V) offshore, pediment, hillside, terrace, undulating, valley flat 27

FORMATION: Tertiary, Eocene TE Cockfield CΦ

Geology: unconsolidated sand US Origin: Deltaic 3 Aquifer Thickness: ≥24 ft

Length of well open to: 40 ft Depth to top of: 486 ft 486

FORMATION: system series aquifer, formation, group

Geology: Origin: Aquifer Thickness: ft

Length of well open to: ft Depth to top of: ft

Interval: 470 - 510

Depth to consolidated rock: ft Source of data:

Depth to cement: ft Source of data:

Hydraulic: Infiltration characteristics:

Efficient: gpd/ft Coefficient Storage:

Efficient: gpd/ft²; Spec cap: gpm/ft; Number of geologic cards:

- 80 ft of 6" pipe 8 3/4" hole
- 90 3" pipe
- 40 3" Wesco galv. GP,

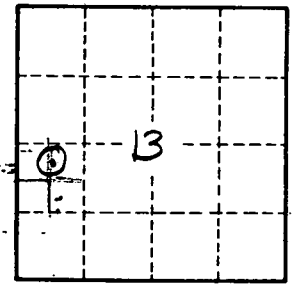

- 70' Buckshot & fine sand
- 170' Sand and gravel
- 486' Hard shale
- 494' Water sand
- 496' Hard shale, some sticky
- 510' Water sand, gravel at top

Tenant
Frank McVey
5-13-68 - could not free plug - needed in.

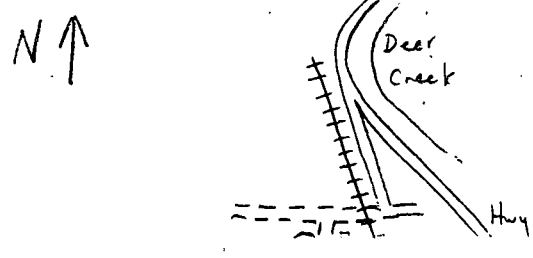

Well No. 424