

### WELL SCHEDULE

U. S. DEPT. OF THE INTERIOR

GEOLOGICAL SURVEY

WATER RESOURCES DIVISION

#### MASTER CARD

Record by G F Brown Source of data WB Ware Date 3-7-39 Map Swan Lake

State Mississippi 28 County Washington 76

Latitude: 33 12 5 2 N Longitude: 09 05 21 9 Sequential number: 1

Lat-long accuracy: 30 T. 16 S. R. 7 Sec 24, SW SE

Local well number: L020E D2416 N07W Other number: B & M

Local use: \_\_\_\_\_ Owner or name: Bolin

Owner or name: M. R. BILIN Address: Estill, Miss.

Ownership: County, Fed Gov't, City, Corp or Co, Private, State Agency, Water Dist P

Use of water: (A) Air cond, Bottling, Comm, Dewater, Power, Fire, Dom, Irr, Med, Ind, P S, Rec, (S) Stock, Instit, (U) Unused, Repressure, Recharge, Desal-P S, Desal-other, Other sand in water U

Use of well: (A) Anode, Drain, Seismic, Heat Res, Obs, Oil-gas, Recharge, Test, (U) Unused, Withdraw, Waste, Destroyed U

DATA AVAILABLE: Well data I Freq. W/L meas.: irregular I Field aquifer char. I

Hyd. lab. data: \_\_\_\_\_

Qual. water data; type: USGS

Freq. sampling: \_\_\_\_\_ Pumpage inventory: no period: \_\_\_\_\_

Aperture cards: \_\_\_\_\_

Log data: \_\_\_\_\_

#### WELL-DESCRIPTION CARD

SAME AS ON MASTER CARD Depth well: 1700 Meas. 6 rept

Depth cased: \_\_\_\_\_ Casing type: \_\_\_\_\_; Diam. 6 in 6

Finish: (C) porous concrete, (F) gravel w. (perf.), (G) gravel w. (screen), (H) horiz. gallery, (P) open end, (S) perf., (T) screen, (W) sd. pt., (X) shored, (Z) open hole, other S

Method Drilled: (A) air rot., (B) bored, (C) cable, (D) dug, (H) hyd. rot., (J) jetted, (P) air percussion, (R) reverse, (T) rotary, (U) trenching, (W) driven, (Z) drive wash, other H

Date Drilled: 1915? 915 Pump intake setting: \_\_\_\_\_ ft. \_\_\_\_\_

Driller: T. B. Minyard Greenwood, Miss.

Lift (type): (A) air, (B) bucket, (C) cent., (J) jet, (L) multiple, (M) multiple, (N) none, (P) piston, (R) rot., (S) submerg., (T) turb., (Z) other N Deep 0 Shallow 40

Power (type): (nat) diesel, elec, gas, gasoline, hand, gas, wind; H.P. \_\_\_\_\_ LP \_\_\_\_\_ Trans. or meter no. \_\_\_\_\_

Descrip. MP X on tee which is 1.5 ft above below LSD. Alt. MP 119.90

Alt. LSD: 118.40 118 Accuracy: Instrument 0

Water Level: +57 ft above below MP, +59 ft above below LSD Accuracy: gaged H

Date meas: 11-2-67 N:67 Yield: \_\_\_\_\_ gpm \_\_\_\_\_ Method determined \_\_\_\_\_

Drawdown: \_\_\_\_\_ ft \_\_\_\_\_ Accuracy: \_\_\_\_\_ Pumping period \_\_\_\_\_ hrs \_\_\_\_\_

QUALITY OF WATER DATA: Iron \_\_\_\_\_ Sulfate \_\_\_\_\_ Chloride \_\_\_\_\_ Hard. \_\_\_\_\_

Sp. Conduct 1650  $\times 10^6$  5 Temp. 82.5 F 83 Date sampled 11-19-63 N:63

Taste, color, etc. Field deter. - Nov 67. Formerly T=94°F and pH=8.6

Well No. L 20

Latitude-longitude d m s N S d m s

**GEOLOGIC CARD**

NAME AS ON MASTER CARD \_\_\_\_\_ Physiographic Province: Coastal Plain 03 Section: Miss. River

Local Plain E Drainage Basin: \_\_\_\_\_ 15J Subbasin: \_\_\_\_\_

of depression, stream channel, dunes, flat, hilltop, sink, swamp, site: (D) (C) (E) (F) (H) (K) (L) (S) (P) (S) (T) (U) (V) Y

PER: Tertiary, Eocene TIE Meridian - upper Wilcox MW

ology: unconsolidated sand U3 Origin: Deltaic 3 Aquifer Thickness: \_\_\_\_\_ ft

Length of well open to: \_\_\_\_\_ ft Depth to top of: \_\_\_\_\_ ft

PER: \_\_\_\_\_ system \_\_\_\_\_ series \_\_\_\_\_ aquifer, formation, group \_\_\_\_\_

ology: \_\_\_\_\_ Origin: \_\_\_\_\_ Aquifer Thickness: \_\_\_\_\_ ft

Length of well open to: \_\_\_\_\_ ft Depth to top of: \_\_\_\_\_ ft

ervals \_\_\_\_\_

to \_\_\_\_\_ ft Source of data: \_\_\_\_\_

to \_\_\_\_\_ ft Source of data: \_\_\_\_\_

ical \_\_\_\_\_ Infiltration characteristics: \_\_\_\_\_

icient \_\_\_\_\_ Coefficient Storage: \_\_\_\_\_

icient \_\_\_\_\_ Spec cap: \_\_\_\_\_ gpm/ft; Number of geologic cards: \_\_\_\_\_

nerly - DeHa & Pine Land Co.

Well 25 ft W. of road

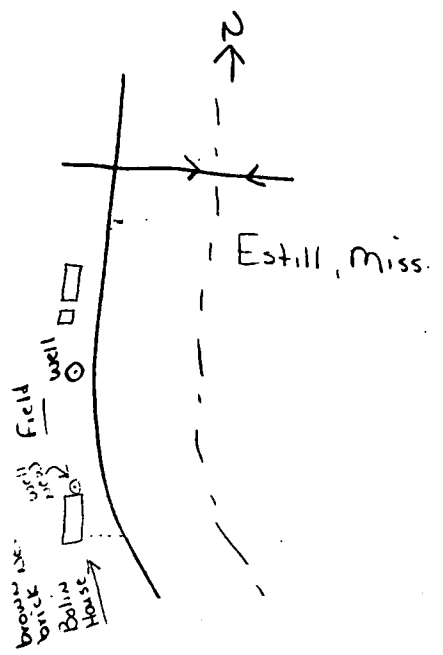
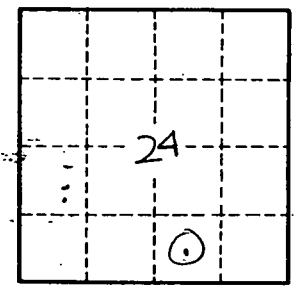

3-7-39  
WL +84.6' MP  
1.5  
+86.1' GL

Well abandoned because of sand

Formation selected by  
GPO 857-700

Well No. L 20