

WELL SCHEDULE

U. S. DEPT. OF THE INTERIOR

GEOLOGICAL SURVEY

WATER RESOURCES DIVISION

MASTER CARD

Record by Brown & Reed Source of data R.N. Aldridge Date 3-8-39 Map Swan Lake **HOLLANDAILE**

State Mississippi 03 County Washington 76

Latitude: 33 12 55 N Longitude: 09 05 22 W Sequential number: 1

Lat-long accuracy: 2 T. 16 S. R. 7 E. Sec. 24, NE, SE, SW, SWNWSE

Local well number: 1019CD2416707W Other number: \_\_\_\_\_

Local use: \_\_\_\_\_ Owner or name: R.N. Aldridge

Owner or name: R. N. ALDRIDGE Address: Estill Miss

Ownership: County, Fed Gov't, City, Corp or Co, Private, State Agency, Water Dist P

Use of water: (A) Air cond, Bottling, Comm, Dewater, Power, Fire, (H) Irr, (I) Med, (M) Ind, (N) P S, (P) Rec, (S) Stock, (T) Inactit, (U) Unused, (V) Recharge, (W) Desal-P S, (X) Desal-other, (Y) Other H

Use of well: (A) Anode, (D) Drain, (G) Seismic, (H) Heat Res, (I) Obs, (P) Oil-gas, (R) Recharge, (T) Test, (U) Unused, (W) Withdraw, (X) Waste, (Z) Destroyed W

DATA AVAILABLE: Well data  Freq. W/L meas.: none Field aquifer char. N

Hyd. lab. data: \_\_\_\_\_

Qual. water data; type: \_\_\_\_\_ K

Freq. sampling: φ Pumpage inventory: yes  no  period: \_\_\_\_\_

Aperture cards: \_\_\_\_\_ yes

Log data: \_\_\_\_\_ 78 79

WELL-DESCRIPTION CARD

4.40 5mg SAME AS ON MASTER CARD Depth well: 1228 ft Meas. 1228 Meas. accuracy 6

Depth cased: 1208 ft Casing type: \_\_\_\_\_; Diam. 4, 2 in 4

Finish: porous concrete, gravel v. concrete, (F) gravel v. concrete, (G) gravel v. concrete, (H) horiz. open perf., (I) screen, (J) gallery, (K) open perf., (L) screen, (M) sd. pt., (N) shored, (O) open hole, (P) other S

Method: (A) air bored, (B) cable, (C) dug, (D) jetted, (E) air reverse, (F) trenching, (G) driven, (H) drive wash, (I) other H

Date Drilled: 1908 908 Pump intake setting: \_\_\_\_\_ ft \_\_\_\_\_

Driller: Ball

Lift (type): (A) air, (B) bucket, (C) cent, (D) jet, (E) multiple, (F) multiple, (G) none, (H) piston, (I) rot, (J) submerg, (K) turb, (L) other S Deep  Shallow

Power (type): (A) diesel, (B) gas, (C) gasoline, (D) hand, (E) gas, (F) wind, (G) H.P. S Trans. or meter no. \_\_\_\_\_

Descrip. MP Ground surface ft above/below LSD. Alt. MP 119.32

Alt. LSD: 119.32 Accuracy: (source) instrument 0

Water Level: 1 ft above/below MP; Ft below LSD 9 Accuracy: \_\_\_\_\_ 6

Date meas: 39 Yield: \_\_\_\_\_ gpm 40 Method determined 41

Drawdown: \_\_\_\_\_ ft Accuracy: \_\_\_\_\_ Pumping period \_\_\_\_\_ hrs \_\_\_\_\_

QUALITY OF WATER DATA: Iron \_\_\_\_\_ ppm Sulfate \_\_\_\_\_ ppm Chloride \_\_\_\_\_ ppm Hard. \_\_\_\_\_

Sp. Conduct 2150 K x 10<sup>6</sup> 6 Temp. °F 72 Date sampled 568

Taste, color, etc. Very soft, amber color. From faucet across

Well No. L19

Latitude-longitude N  
S  
d m s d m s

**HYDROGEOLOGIC CARD**

NAME AS ON MASTER CARD: Physiographic Province: Coastal Plain 03 Section: Miss River  
 Drainage Basin: 15J Subbasin: 26

of site: (D) depression, stream channel, dunes, flat, hilltop, sink, swamp, (E) offshore, pediment, hillside, terrace, undulating, valley flat (V) V

Age (FER): Tertiary system, Eocene series, TE aquifer, formation, group, Sparta S5

Lithology: unconsolidated white sand US Origin: Deltaic 3 Aquifer Thickness: \_\_\_\_\_ ft  
 Length of well open to: 20 ft 20 Depth to top of: \_\_\_\_\_ ft

Age (FER): \_\_\_\_\_ system, \_\_\_\_\_ series, \_\_\_\_\_ aquifer, formation, group, \_\_\_\_\_ \_\_\_\_\_  
 Lithology: \_\_\_\_\_ Origin: \_\_\_\_\_ Aquifer Thickness: \_\_\_\_\_ ft  
 Length of well open to: \_\_\_\_\_ ft \_\_\_\_\_ Depth to top of: \_\_\_\_\_ ft

Observations: 1208 - 1228  
 Depth to consolidated rock: \_\_\_\_\_ ft \_\_\_\_\_ Source of data: \_\_\_\_\_  
 Depth to cement: \_\_\_\_\_ ft \_\_\_\_\_ Source of data: \_\_\_\_\_  
 Piezometric head: \_\_\_\_\_ Infiltration characteristics: \_\_\_\_\_  
 Specific yield: \_\_\_\_\_ gpd/ft \_\_\_\_\_ Coefficient Storage: \_\_\_\_\_  
 Specific capacity: \_\_\_\_\_ gpd/ft<sup>2</sup>; Spec cap: \_\_\_\_\_ gpm/ft; Number of geologic cards: \_\_\_\_\_

Observations: 10 ft well never flowed.  
and head 4 ft above surface - 18-20 gpm  
ft underground.  
noticeable seasonal variation in adq. & permanence  
drawdown 4-5 feet after 5 min. pumping  
inhibits Mor Typhoon 5"x5" 1 1/2 hp

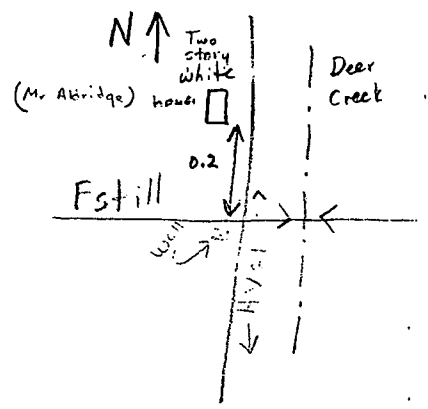
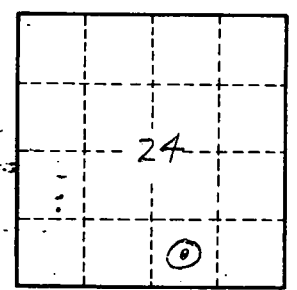

5-15-68  
Sub. pump installed  
by Bailey Drill  
Co about 4 years  
ago.