

WELL SCHEDULE

1653

331351091024101
U. S. DEPT. OF THE INTERIOR

GEOLOGICAL SURVEY

WATER RESOURCES DIVISION

MASTER CARD

Record by WT. Oakley Source of data Mv Morris Date 11-2-67 Map _____

State Mississippi 28 County Washington 76

Latitude: 33 13 54 N Longitude: 09 10 24 W Sequential number: 1

Lat-long accuracy: 2 T. 16 S. 8 E. 4 SE. SE (NW, SE 17) B & M

Local well number: K 015 D D 0416 N 08 W Other number: _____

Local use: 064 568 30 Owner or name: Riverside Water Assoc

Owner or name: RIVERSIDE WA Address: Avon Miss.

Ownership: (C) County, (F) Fed Gov't, (M) City, (N) Corp or Co, (P) Private, (S) State Agency, (W) Water Dist N

Use of water: (A) Air cond, (B) Bottling, (C) Comm, (D) Dewater, (E) Power, (F) Fire, (G) Dom, (H) Irr, (I) Med, (J) Ind, (K) P S, (L) Rec, (M) Stock, (N) Insatit, (O) Unused, (P) Reppure, (Q) Recharge, (R) Desal-P S, (S) Desal-other, (T) Other 60 customers P

Use of well: (A) Anode, (B) Drain, (C) Seismic, (D) Heat Res, (E) Obs, (F) Oil-gas, (G) Recharge, (H) Test, (I) Unused, (J) Withdraw, (K) Waste, (L) Destroyed W

DATA AVAILABLE: Well data Freq. W/L meas.: original Field aquifer char. Z

Hyd. lab. data: _____

Qual. water data; type: USGS 4-4-72

Freq. sampling: _____ Pumpage inventory: yes, no, period: _____

Aperture cards: _____ yes

Log data: _____ D

WELL-DESCRIPTION CARD

SAME AS ON MASTER CARD Depth well: 1171 w/41 ft 1164 Meas. rep'd accuracy 3

Depth cased; (first perf.) ft 109 Casing type: _____; Diam. 8.4 in 8

Finish: (C) porous concrete, (F) gravel w. (perf.), (G) gravel w. (screen), (H) horiz. gallery, (I) open end, (J) perf., (K) screen, (L) sd. pt., (M) shcred, (N) open hole, (O) other S

Method Drilled: (A) air rot, (B) bored, (C) cable, (D) dug, (E) hyd rot, (F) jetted, (G) air percussion, (H) reverse, (I) trenching, (J) driven, (K) drive wash, (L) other H

Date Drilled: 7-1966 966 Pump intake setting: _____ ft _____

3.95 Driller: Layne Central Cleveland, Miss.

7.5e Lift (type): (A) air, (B) bucket, (C) cent, (D) jet, (E) multiple (cent.), (F) multiple (turb.), (G) none, (H) piston, (I) rot, (J) submerg, (K) turb, (L) other S Deep Shallow

2.95 Power (type): (A) diesel, (B) elec, (C) gas, (D) gasoline, (E) hand, (F) gas, (G) wind, (H) H.P. 5 Trans. or meter no. _____

Descrip. MP air vent at 10 ft above LSD. Alt. MP _____

Alt. LSD: 113 113 Accuracy: topo 3

Water Level 27.16 ft above belcw MP; Ft below LSD 27 Accuracy: measured A

3. Date meas: 11-1-67 N 67 Yield: 184 gpm 184 Method determined 1

7. Drawdown: _____ ft _____ Accuracy: _____ Pumping period _____ hrs _____

7. QUALITY OF WATER DATA: Iron _____ Sulfate _____ Chloride _____ Hard. _____

Sp. Conduct 1490 K x 10⁶ 5 Temp. 78 °F 26 Date sampled N 67

Taste, color, etc. pH=8.7

Well No. K 15

Latitude-longitude N
S

GEOLOGIC CARD

NAME AS ON MASTER CARD Physiographic Province: Coastal Plains Section: Miss. River

Drainage Basin: E 151 Subbasin: 26

of depression, stream channel, dunes, flat, hilltop, sink, swamp, site: (D) (C) (E) (F) (H) (K) (L) (V) valley flat V

Age: Tertiary Eocene TE Sparta Sand 55

Geology: Unconsolidated Sand U3 Origin: 1 2 Aquifer Thickness: 41 ft

Length of well open to: 57 ft Depth to top of: 117? ft

Age:

Geology: Origin: Aquifer Thickness: ft

Length of well open to: ft Depth to top of: ft

Values noted: 1109-1164 ft 55' x 4" 7'-4" blank

Thickness to consolidated rock: ft Source of data:

Thickness to cement: ft Source of data:

Infiltration characteristics:

Specific capacity: 363 gpd/ft Coefficient Storage:

Specific capacity: 400 gpd/ft²; Spec cap: 3.0 gpm/ft; Number of geologic cards:

omene present

1-6P
30.00
3.04
26.96=MP

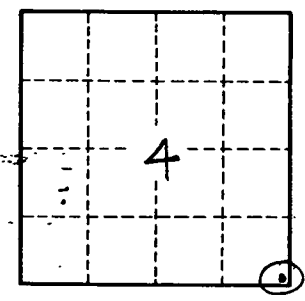
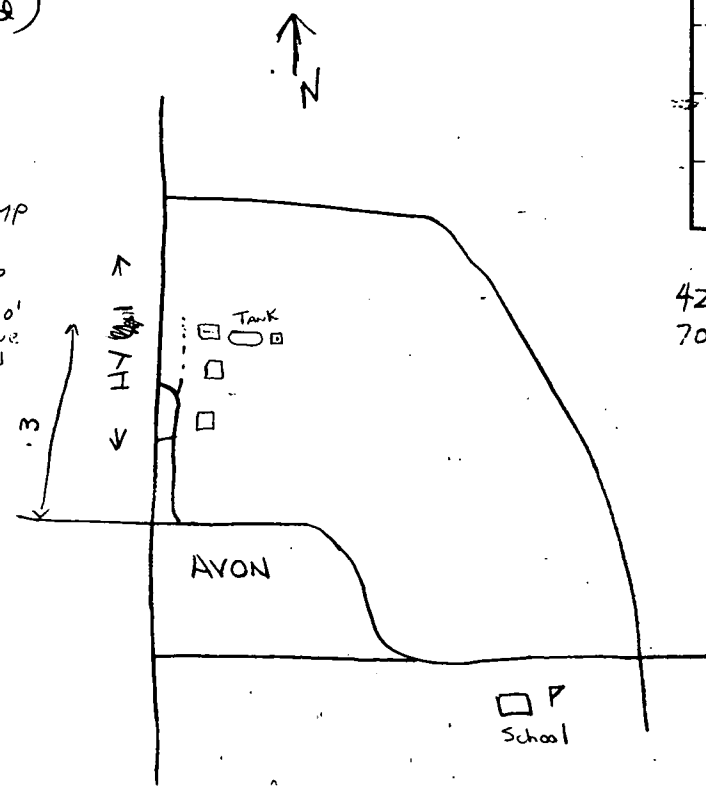
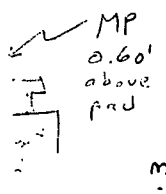

42' of 8"
70' of 4"
1'-5" 8'x9' swage
about 22' lap

Well No. K15

