

WELL SCHEDULE

U. S. DEPT. OF THE INTERIOR

GEOLOGICAL SURVEY

WATER RESOURCES DIVISION

MASTER CARD

Record by Brown + Reed Source of data J.C. McKewen Date 3-8-39 Map Trailake

State Mississippi 28 County Washington 76
(or town)

Latitude: 33¹16²25³N⁴ Longitude: 090⁵47⁶46⁷ Sequential number: 1
5 deg 7 min 9 sec 11 E 12 degrees 15 min sec 18 19

Lat-long accuracy: 3 T. 17⁸ S. R 6⁹ Sec 35 SW $\frac{1}{4}$, SW $\frac{1}{4}$, B & M
20 21 22 23 24 25 26 27 28 29 30 31 32 33 34

Local well number: J0072C3517N06W Other number: _____
21 22 23 24 25 26 27 28 29 30 31 32 33 34

Local use: _____ Owner or name: Trail Lake Inc.
35 36 37 38 39 40 41 42 43 44 45 46 47 48 49 50 51

Owner or name: TRAIL LAKE INC. Address: Trailake Miss.
52 53 54 55 56 57 58 59 60 61 62 63 64 65 66

Ownership: County, Fed Gov't, City, Corp or Co, Private, State Agency, Water Dist N
(C) (F) (M) (N) (P) (S) (W) 67

Use of water: Air cond, Bottling, Comm, Dewater, Power, Fire, Irr, Med, Ind, P S, Rec, Stock, Instit, Unused, Repressure, Recharge, Desal-P S, Desal-other, Other H
(A) (B) (C) (D) (E) (F) (H) (I) (M) (N) (P) (R) (S) (T) (U) (V) (W) (X) (Y) (Z) 68

Use of well: Anode, Drain, Seismic, Heat Res, Obs, Oil-gas, Recharge, Test, Unused, Withdraw, Waste, Destroyed W
(A) (D) (G) (H) (I) (P) (R) (T) (U) (V) (W) (X) (Z) 69

DATA AVAILABLE: Well data Freq. W/L meas.: Original Field aquifer char.
70 71 72

Hyd. lab. data: _____ 73

Qual. water data; type: USGS Complete 74 C

Freq. sampling: Original Pumpage inventory: _____ yes no, period: _____ 76

Aperture cards: _____ yes 77

Log data: _____ 78 79

WELL-DESCRIPTION CARD

SAME AS ON MASTER CARD Depth well: 1917 ft 1917 Meas. 6
19 (first perf.) 20 21 22 23 24 25 26 27 28 29 30 accuracy rept

Depth cased; _____ ft _____ Casing type: _____; Diam. _____ in _____
25 26 27 28 29 30

Finish: porous concrete, gravel w. (perf.), gravel w. (screen), horiz. gallery, open end, perf., screen, sd. pt., shored, open hole, other _____
(C) (F) (G) (H) (I) (P) (S) (T) (W) (X) (Z) 31

Method Drilled: air rot, bored, cable, dug, hyd rot, jetted, air percussion, reverse rotary, trenching, driven, wash, other _____
(A) (B) (C) (D) (H) (J) (P) (R) (T) (V) (W) (Z) 32

Date Drilled: 1917 917 Pump intake setting: _____ ft _____
33 34 35 36 37 38

Driller: T. B. Minyard, Greenwood Miss. address
39

Lift (type): air, bucket, cent, jet, multiple, multiple, none, piston, rot, submerg, turb, other N Deep _____ Shallow _____
(A) (B) (C) (J) (M) (N) (P) (R) (S) (T) (Z) 39 40

Power (type): diesel, elec, gas, gasoline, hand, gas, wind; H.P. _____ Trans. or meter no. _____
nat LP 41

Descrip. MP X on Tee, which is 2.0 ft above _____ below LSD. Alt. MP 11193
42 43 44

Alt. LSD: 109.93 1110 Accuracy: instrument _____
45 46 47 48

Water Level +34.6 ft above _____ below MP; Ft below LSD +37 Accuracy: pressure gage _____
49 50 51 52

Date meas: 3-8-39 339 Yield: _____ gpm _____ Method determined _____
53 54 55 56 57 58 59 60 61

Drawdown: _____ ft _____ Accuracy: _____ Pumping period _____ hrs _____
62 63 64 65 66 67 68

QUALITY OF WATER DATA: Iron _____ Sulfate _____ Chloride _____ Hard. _____
69 70 71 72

Sp. Conduct 1900 K x 10⁶ 5 Temp. 77 °F Date sampled Feb. 20, 1968 268
73 74 75 76 77 78 79

Taste, color, etc. reported Na. Field deter. from tank - Nov 67
80 81

Well No.

IT7

Latitude-longitude N S
d m s d m s

DROGEOLOGIC CARD

NAME AS ON MASTER CARD _____ Physiographic Province: Coastal Plain 03 Section: Miss. River

Drainage Basin: 1:5:H Subbasin: _____

of depression, stream channel, dunes, flat, hilltop, sink, swamp, site: (D) (C) (E) (F) (H) (K) (L) (V) (V)
offshore, pediment, hillside, terrace, undulating, valley flat _____

OR Tertiary, Eocene T E Meridian - upper Wilcox M W
system series aquifer, formation, group

Geology: UNconsolidated Sand U S Origin: Deltaic 3 Aquifer Thickness: _____ ft

Length of well open to: _____ ft Depth to top of: _____ ft

OR system series aquifer, formation, group

Geology: _____ Origin: _____ Aquifer Thickness: _____ ft

Length of well open to: _____ ft Depth to top of: _____ ft

Interval: _____

Depth to consolidated rock: _____ ft Source of data: _____

Depth to cement: _____ ft Source of data: _____

Efficient: _____ Infiltration characteristics: _____

Efficient: _____ Coefficient Storage: _____

Efficient: _____ Spec cap: _____ gpm/ft; Number of geologic cards: _____

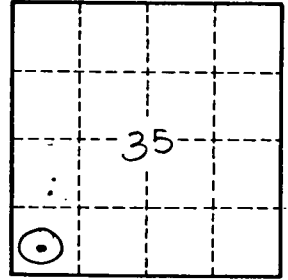
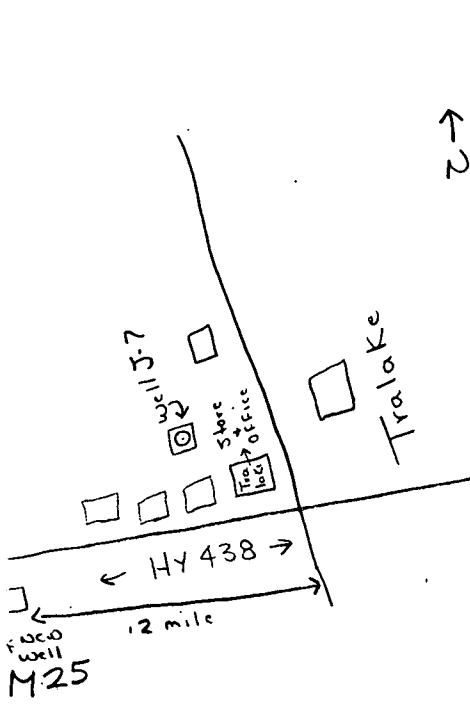

Nov 67
Head about +1 ft
Pumped from tank to shore.
5-13.68 unable to obtain WL

Well No. J 7