

WRD Exp. (GW)
April 1966

Well No. H 101

PUNCHED

WELL SCHEDULE

U. S. DEPT. OF THE INTERIOR

GEOLOGICAL SURVEY

WATER RESOURCES DIVISION

MASTER CARD

Record by E.H. Boswell Source of data Per. Interview Date 2-2-54 Map Tralake Quad

State Mississippi 28 County Washington 76

Latitude: 33 18 08 N Longitude: 09 05 32 9 Sequential number: 1

Lat-long accuracy: 1 T. 17 S, R 7 Sec 23, SW 1/4, SE 1/4, B & M

Local well number: H 101 C D 23 17 N 0 7 W Other number: _____

Local use: _____ Owner or name: J.A. Aldridge

Owner or name: J. A. ALDRIDGE Address: Wilmot, Miss

Ownership: County, Fed Gov't, City, Corp or Co, Private, State Agency, Water Dist P

Use of water: (A) Air cond, Bottling, Comm, Dewater, Power, Fire, Dom, Irr, Med, Ind, P, Rec, (P) (R) 4

Use of well: (S) Stock, Instit, Unused, Repressure, Recharge, Desal-P S, Desal-other, Other (A) (D) (G) (H) (P) (R) (T) (U) (W) (X) (Z) W

DATA AVAILABLE: Well data Freq. W/L meas.: semi-annually 5 Field aquifer char.

Hyd. lab. data: _____

Qual. water data; type: USGS COMPLETE State Board of Health 1954(?) C

Freq. sampling: Original φ Pumpage inventory: no period: _____

Aperture cards: _____

Log data: _____

WELL-DESCRIPTION CARD

SAME AS ON MASTER CARD Depth well: 1935 ft 1935 Meas. accuracy 6

Depth cased: 1895 ft 1895 Casing type: black iron; Diam. 4 in 4

Finish: (C) porous concrete, (F) gravel w. (G) gravel w. (H) horiz. open (P) perf., (S) screen, (T) sd. pt., (W) shored, (X) open hole, (Z) other S

Method Drilled: (A) air rot, (B) bored, (C) cable, (D) dug, (H) hyd rot, (J) jetted, (P) air percussion, (R) reverse, (T) trenching, (V) driven, (W) wash, (Z) other H

Date Drilled: Nov-Dec 1953 953 Pump intake setting: _____ ft

Driller: Bailey Drilling Co, Greenville Miss.

Lift (type): (A) air, (B) bucket, (C) cent, (J) multiple, (L) multiple, (M) multiple, (N) multiple, (P) piston, (R) submerg, (S) turb, (T) other, (Z) other N Deep Shallow

Power (type): nat, diesel, elec, gas, gasoline, hand, gas, wind, H.P. LP Trans. or meter no. _____

Descrip. MP T at well head, which is 1.8 ft above LSD. Alt. MP 121

Alt. LSD: 120 ± 120 Accuracy: topo 5' 3

Water Level + 52.82 above MP. Ft below LSD + 54 Accuracy: Pressure gag, 22" H

Date meas: Feb 1954 254 Yield: _____ gpm Method determined _____

Drawdown: _____ ft Accuracy: _____ Pumping period _____ hrs

QUALITY OF WATER DATA: Iron _____ Sulfate _____ Chloride _____ Hard. _____

Sp. Conduct 1695 K x 10⁶ 5 Temp. 77 °F Date sampled Feb 19, 1968 268

Taste, color, etc. Field meas - Nov 67, Former T = 75.5°F

Field PH = 8.5 → 2-68

TRANSMITTED FOR ADP

Well No. H 101

DS-988

Well No. H 101

Latitude-longitude 33 18 08 ^N 89 53 29 ^W

HYDROGEOLOGIC CARD

SAME AS ON MASTER CARD Physiographic Province: Coastal Plain Section: Miss. River

alluvial plain Drainage Basin: 15 J Subbasin:

Topo of well site: (D) depression, stream channel, dunes, flat, hilltop, sink, swamp, (E) offshore, pediment, hillside, terrace, undulating, valley flat (V)

MAJOR AQUIFER: Tertiary system, Eocene series, TE Meridian-upper Wilcox aquifer, formation, group, M:W

Lithology: unconsolidated sand U.S Origin: Deltaic 3 Aquifer Thickness: ft

Length of well open to: 40 ft Depth to top of: 40 ft

MINOR AQUIFER: system, series, aquifer, formation, group, Aquifer Thickness: ft

Lithology: Origin: Aquifer Thickness: ft

Length of well open to: ft Depth to top of: ft

Intervals Screened: 1895-1935 ft 40' x 9" SS screen

Depth to consolidated rock: ft Source of data:

Depth to basement: ft Source of data:

Surficial material: Infiltration characteristics:

Coefficient Trans: gpd/ft Coefficient Storage:

Coefficient Perm: gpd/ft²; Spec cap: gpm/ft; Number of geologic cards:

Conflict in depth data, driller

Other sands 500 ft.
1400 ft. (will not surface)

Pressure same as nearby well had when completed about 1902 (?)
Reports no hard rock, although previous nearby wells struck hard rock.
Bottom into black mud

11-1-67

WL = +40.50' GL
Owner reports noticeable pressure drop

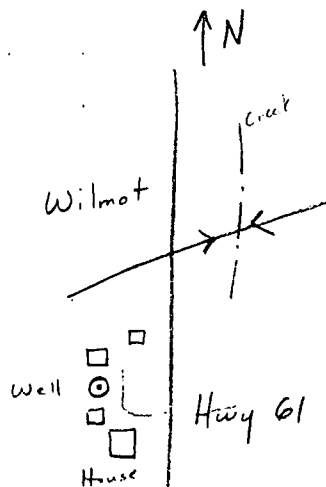
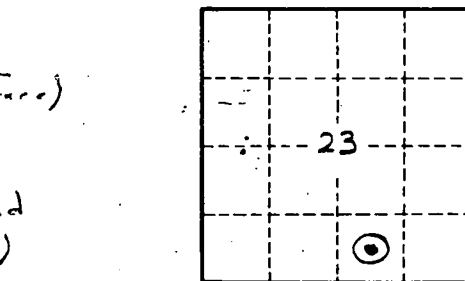

Well No. H 101