

6/78 WTO

Recorded by \_\_\_\_\_

Date \_\_\_\_\_

Irrigation

U.S. GEOLOGICAL SURVEY  
WATER RESOURCES DIVISION  
MISSISSIPPI DISTRICT  
WELL RECORD

Well No. 5174  
E-Log No. \_\_\_\_\_  
County Wash.

Site ID 33.1722.09.1004.001 R=0\* T=A\* 2=W\*  
5 19

# 11  
Washington

GEN. SITE DATA

Data reliab. 3=C\*<sup>C</sup> Report. agency 4=USGS\* Dist. 6=28\* 7=28\* Co. 8=15.1\*  
Lat. \_\_\_\_\_  
Long. 9=33.1722\* 10=09.10040\* Well No. 12=5174\*  
NE 4  
Location 13=NW, SE, S, 3, 2, T, 1, 2, N, R, 2, 8, W\* Alt. 16=115.\*  
Hyd. Unit (OWDC) 20= \_\_\_\_\_ Date 21=09.10.11.1980\*  
Well use 23=W\* Water Use 24=I\* Hole depth 27= \_\_\_\_\_ Well depth 28=110.\*  
WL 30=31.\* Date 31=09.10.11.1980\* Source 33=S\*  
Status 273= \_\_\_\_\_ Project No. 5= \_\_\_\_\_

OWNER

R=158\* T=A\* Date 159# 0.10.11.1980\* Owner No. \_\_\_\_\_  
Owner 16=UNKNOWN\*

FIELD LOG

R=192\* T=A\* Date 193# \_\_\_\_\_ Temp. 196#00010\* 197= \_\_\_\_\_  
R=192\* T=A\* Date 193# \_\_\_\_\_ Cond. 196#00095\* 197= \_\_\_\_\_  
R=192\* T=A\* Date 193# \_\_\_\_\_ pH 196#00400\* 197= \_\_\_\_\_

CONSTR.

50.0 13.7  
8.2  
2.5  
3.1  
R=58\* T=A\* 59# 1\* Date 60=0.10.11.1980\* Remarks \_\_\_\_\_  
Drig. 63= \_\_\_\_\_ Name \_\_\_\_\_ Method 65=R\* Finish 66= \_\_\_\_\_

CASING

R=76\* T=A\* 59# 1\*  
Top csgn. 77# 0.\* Bot. csgn. 78= \_\_\_\_\_ Diam. 79# 10.0\*  
R=76\* T=A\* 59# 1\*  
Top csgn. 77# \_\_\_\_\_ Bot. csgn. 78= \_\_\_\_\_ Diam. 79# \_\_\_\_\_

OPENINGS

R=82\* T=A\* 59# 1\* Top 83# \_\_\_\_\_ Bottom 84= \_\_\_\_\_  
Type 85= \_\_\_\_\_ Diam. 87= \_\_\_\_\_ Size 88= \_\_\_\_\_  
R=82\* T=A\* 59# 1\* Top 83# \_\_\_\_\_ Bottom 84= \_\_\_\_\_  
Type 85= \_\_\_\_\_ Diam. 87= \_\_\_\_\_ Size 88= \_\_\_\_\_

YIELD

R= \_\_\_\_\_ T=A\* 147# 1\* Q 150= \_\_\_\_\_ Q/S 272= \_\_\_\_\_  
134 flows 146 pumped

LIFT

R=42\* T= A \* Lift type 43# \* Intake 44= \* Power type 45= \*

Date 38= / / H.P. 46= \*

LOGS

R=198\* T= A \* Log 199# \* Top 200= \* Bot 201= \*

R=198\* T= A \* Log 199# \* Top 200= \* Bot 201= \*

R=189\* T= A \* E Log No. 190# \* 191= M I S S D I S T \*

ANAL.

R=114\* T= A \* Year 115# \* Type 120= \*

AQUIFERS

R=90\* T= A \* 256# 1 \* Top 91= \* Bot 92= \*

Unit ID 93= 1.2 M.R.V.A. \* Name of Unit

R=90\* T= A \* 256# 1 \* Top 91= \* Bot 92= \*

Unit ID 93= \* Name of Unit

HYDRAULICS

R=98\* T= A \* 99# 1 \* Unit tested 100= \* 103= \*

R=105\* T= A \* 99# 1 \* Test No. 106# \*

107= \* Transmissivity (gal/d)/ft

108= \* Hydraul. cond. (gal/d)/ft<sup>2</sup>

110= \* Storage coeff. Boundaries

R=121\* T= \* Yr Begin 122# \* Network 258= \*

Water Level Data Collection (1)

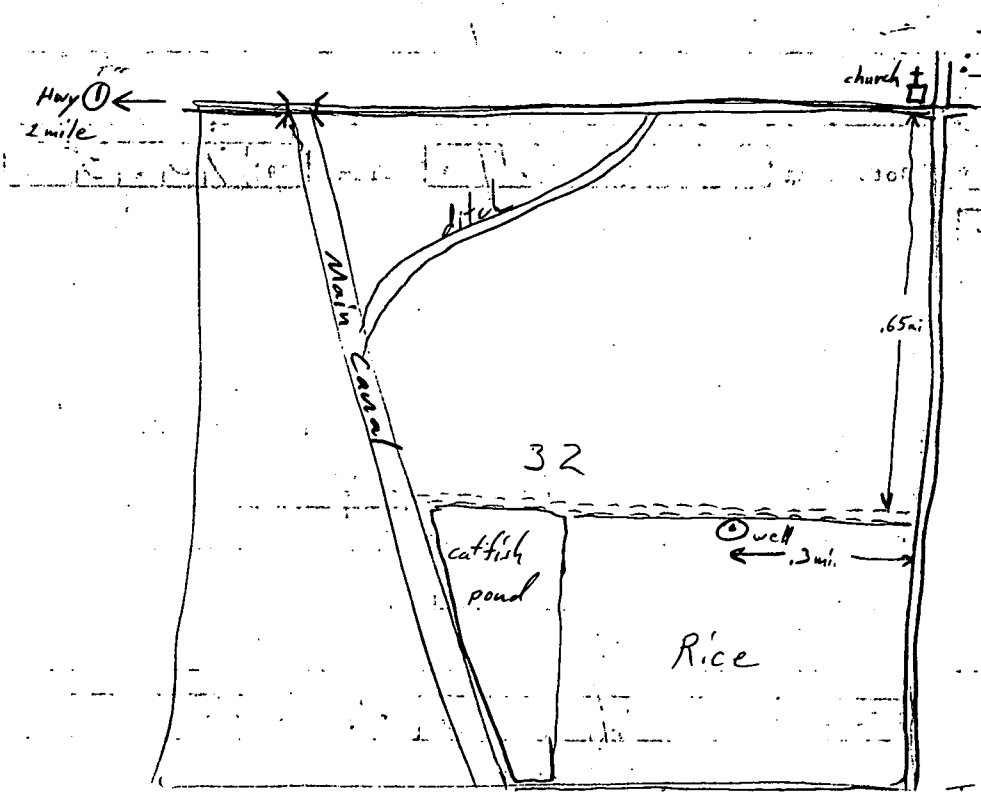

HW 438