

WELL SCHEDULE

145 D WAYSIDE

U. S. DEPT. OF THE INTERIOR

GEOLOGICAL SURVEY

WATER RESOURCES DIVISION

MASTER CARD

Record by J.S. Source of data Bowc Date 10/69 Map \_\_\_\_\_

State 07 28 County (or town) Washington 76

Latitude: 33<sup>deg</sup> 18<sup>min</sup> 10<sup>sec</sup> N Longitude: 09<sup>deg</sup> 10<sup>min</sup> 23<sup>sec</sup> W Sequential number: 1

Lat-long accuracy: 3 T. 17 S. R. 8 Sec 25 NE SE

Local well number: G104AD2517N08W Other number: \_\_\_\_\_ B & M

Local use: 193 Owner or name: Epitist Church

Owner or name: SWIFT WATER BAPT C Address: Greenville, Ms.

Ownership: (C) County, Fed Gov't, (M) City, Corp or Co, Private, (S) State Agency, Water Dist \_\_\_\_\_ P

Use of water: (A) Air cond, (B) Bottling, (C) Comm, (D) Dewater, (E) Power, (F) Fire, (G) Dom, (H) Irr, (I) Med, (M) Ind, (N) P, (P) Rec, (S) Stock, (T) Instit, (U) Unused, (V) Repressure, (W) Recharge, (X) Desal-P S, (Y) Desal-other, (Z) Other \_\_\_\_\_ H

Use of well: (A) Anode, (D) Drain, (G) Seismic, (H) Heat Res, (I) Obs, (P) Oil-gas, (R) Recharge, (T) Test, (U) Unused, (W) Withdraw, (X) Waste, (Z) Destroyed \_\_\_\_\_ W

DATA AVAILABLE: Well data  Freq. W/L meas.:  Field aquifer char.

Hyd. lab. data: \_\_\_\_\_

Qual. water data; type: \_\_\_\_\_

Freq. sampling: \_\_\_\_\_ Pumpage inventory:  yes,  no, period: \_\_\_\_\_

Aperture cards: \_\_\_\_\_ yes

Log data: \_\_\_\_\_ D

WELL-DESCRIPTION CARD

SAME AS ON MASTER CARD Depth well: \_\_\_\_\_ ft 414 Meas. rept accuracy \_\_\_\_\_ 3

Depth cased: (first perf.) \_\_\_\_\_ ft 399 Casing type: Galv. Diam. 4X2 in \_\_\_\_\_ 4

Finish: (C) porous concrete, (F) gravel w. (perf.), (G) gravel w. (screen), (H) horiz. gallery, (I) open end, (P) perf., (S) screen, (T) sd. pt., (W) shored, (X) open hole, (Z) other \_\_\_\_\_ S

Method: (A) air rot, (B) bored, (C) cable, (D) dug, (H) hyd jetted, (J) air rot., (P) percussion, (R) rotary, (T) reverse, (U) trenching, (V) driven, (W) drive wash, (Z) other \_\_\_\_\_ H

Date Drilled: 9/6/9 Pump intake setting: \_\_\_\_\_ ft \_\_\_\_\_ 36 38

Driller: \_\_\_\_\_ name \_\_\_\_\_ address \_\_\_\_\_

Lift (type): (A) air, (B) bucket, (C) cent, (J) jet, (L) multiple, (M) multiple, (N) none, (P) piston, (R) rot, (S) submerg, (T) turb, (Z) other \_\_\_\_\_ Deep \_\_\_\_\_ Shallow \_\_\_\_\_

Power (type): diesel, elec. nat gas, gasoline, hand, gas, wind; H.P. \_\_\_\_\_ LP \_\_\_\_\_ Trans. or meter no. \_\_\_\_\_ S

Descrip. MP \_\_\_\_\_ ft above \_\_\_\_\_ below LSD, Alt. MP \_\_\_\_\_

Alt. LSD: \_\_\_\_\_ Accuracy: (source) \_\_\_\_\_ 3

Water Level: 36 ft above \_\_\_\_\_ below MP; Ft below LSD \_\_\_\_\_ Accuracy: \_\_\_\_\_ D

Date meas: \_\_\_\_\_ Yield: 869 gpm \_\_\_\_\_ Method determined \_\_\_\_\_ 40

Drawdown: \_\_\_\_\_ ft \_\_\_\_\_ Accuracy: \_\_\_\_\_ Pumping period \_\_\_\_\_ hrs \_\_\_\_\_ 60

QUALITY OF WATER DATA: Iron \_\_\_\_\_ ppm Sulfate \_\_\_\_\_ ppm Chloride \_\_\_\_\_ ppm Hard. \_\_\_\_\_ ppm

Sp. Conduct \_\_\_\_\_ K x 10<sup>6</sup> \_\_\_\_\_ Temp. \_\_\_\_\_ °F \_\_\_\_\_ Date sampled \_\_\_\_\_ 74 76 77 79

Taste, color, etc. \_\_\_\_\_

Well No.

G 104

PUNCHED

Latitude-longitude N  
S  
d m s d m s

**HYDROGEOLOGIC CARD**

AS ON MASTER CARD 03 Section: \_\_\_\_\_  
Province: \_\_\_\_\_

E Drainage Basin: 15I Subbasin: \_\_\_\_\_

(D) (C) (E) (F) (H) (K) (L)  
of depression, stream channel, dunes, flat, hilltop, sink, swamp,  
site: (Ø) (P) (S) (T) (U) (V)  
offshore, pediment, hillside, terrace, undulating, valley flat \_\_\_\_\_

ER: \_\_\_\_\_ aquifer, formation, group CØ

logy: US Origin: 2 Aquifer Thickness: 270 ft??

Length of well open to: \_\_\_\_\_ ft 15 Depth to top of: \_\_\_\_\_ ft 150 ??

ER: \_\_\_\_\_ aquifer, formation, group \_\_\_\_\_

logy: \_\_\_\_\_ Origin: \_\_\_\_\_ Aquifer Thickness: \_\_\_\_\_ ft

Length of well open to: \_\_\_\_\_ ft \_\_\_\_\_ Depth to top of: \_\_\_\_\_ ft \_\_\_\_\_

vals ned: 2" ss

to lidated rock: \_\_\_\_\_ ft \_\_\_\_\_ Source of data: \_\_\_\_\_

to ant: \_\_\_\_\_ ft \_\_\_\_\_ Source of data: \_\_\_\_\_

cial ial: \_\_\_\_\_ Infiltration characteristics: \_\_\_\_\_

icient: \_\_\_\_\_ gpd/ft \_\_\_\_\_ Coefficient Storage: \_\_\_\_\_

icient: \_\_\_\_\_ gpd/ft; Spec cap: \_\_\_\_\_ gpm/ft; Number of geologic cards: \_\_\_\_\_

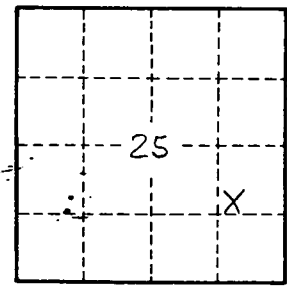
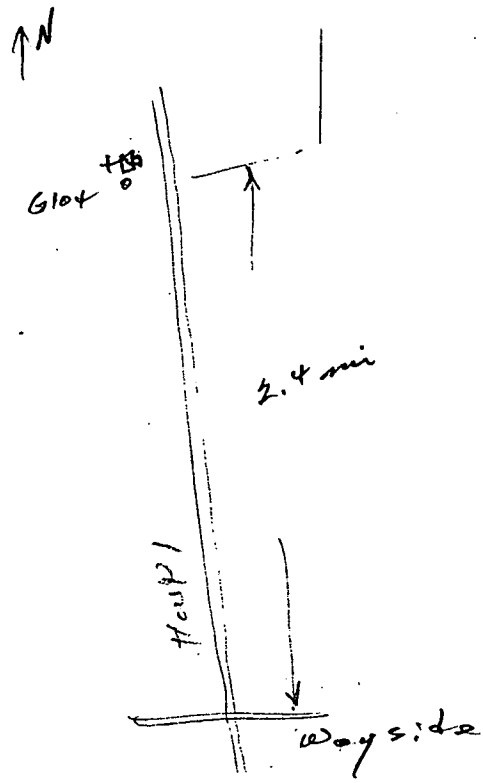

Well No. G 104

