

TRANSMITTED FOR ADP

MASTER CARD

Record by RE. Grantham Source of data Driv. & E Log Date 1-22-69 Map _____

State Mississippi 28 County (or town) Washington 76

Latitude: 33 21 09 N Longitude: 09 02 10 Sequential number: 1

Lat-long accuracy: 2 17 S, R 8 W Sec. 9, SE 1, NW 1, NW 1 (NW NW, 4)

Local well number: 6093880917N08W Other number: _____

Local use: 064 Owner or name: Greenville Country Club

Owner or name: GREENVILLE CC Address: Greenville Miss

Ownership: County, Fed Gov't, City, Corp or Co, Private, State Agency, Water Dist Country Club N

Use of water: (A) Air cond, (B) Bottling, (C) Comm, (D) Dewater, (E) Power, (F) Fire, (G) Dom, (H) Irr, (I) Med, (J) P S, (K) Rec, (L) Stock, (M) Instit, (N) Unused, (O) Reppure, (P) Recharge, (Q) Desal-P S, (R) Desal-other, (S) Other Dom-Rec H

Use of well: (A) Anode, (B) Drain, (C) Seismic, (D) Heat Res, (E) Obs, (F) Oil-gas, (G) Recharge, (H) Test, (I) Unused, (J) Withdraw, (K) Waste, (L) Destroyed W

DATA AVAILABLE: Well data Freq. W/L meas.: Field aquifer char.

Hyd. lab. data: _____

Qual. water data; type: _____

Freq. sampling: Pumpage inventory: yes no, period: _____

Aperture cards: _____ yes

Log data: E. Log D E

WELL-DESCRIPTION CARD

SAME AS ON MASTER CARD Depth well: 499.7 w/4.1/2" pipe ft 49.4 Meas. rept. accuracy 3

Depth cased; (first perf.) ft 46.4 Casing type: Steel; Diam. 6x4 in 6

Finish: porous concrete, gravel w. concrete, (perf.), (C) gravel w. (screen), (H) horiz. gallery, (J) open end, (K) perf., (L) screen, sd. pt., (M) shored, (N) open hole, (O) other S

Method Drilled: (A) air rot, (B) bored, (C) cable, (D) dug, (E) hyd jetted, (F) air rot., (G) percussion, (H) rotary, (I) air reverse, (J) reverse trenching, (K) driven, (L) drive wash, (M) other H

Date Drilled: 1-69 969 Pump intake setting: _____ ft _____

Driller: Layne Central Co. Cleveland Miss

Lift (type): (A) air, (B) bucket, (C) cent., (D) jet, (E) multiple, (F) multiple, (G) none, (H) piston, (I) rot, (J) submerg, (K) turb, (L) other Deep Shallow 40

Power (type): (A) diesel, (B) elec, (C) gas, (D) gasoline, (E) hand, (F) gas, (G) wind; H.P. 5 Trans. or meter no. _____

Descrip. MP _____ ft above below LSD, Alt. MP _____

Alt. LSD: 120 120 Accuracy: (source) Topo 3

Water Level _____ ft above below MP; Ft below LSD 45 Accuracy: _____ D

Date mess: 169 Yield: _____ gpm 50 Method determined A

Drawdown: _____ ft _____ Accuracy: _____ Pumping period _____ hrs _____

QUALITY OF WATER DATA: Iron _____ ppm Sulfate _____ ppm Chloride _____ ppm Hard. _____ ppm

Sp. Conduct _____ K x 10⁶ Temp. _____ °F Date sampled _____

Taste, color, etc. _____

Well No. G 93

DROGEOLOGIC CARD

NAME AS ON MASTER CARD

Physiographic Province: 03 Section: _____

D Drainage Basin: _____

151 Subbasin: _____

Site of: (D) depression, stream channel, dunes, flat, hilltop, sink, swamp, (C) _____ (E) _____ (F) _____ (H) _____ (K) _____ (L) _____
offshore, pediment, hillside, terrace, undulating, valley flat _____

OR

IFER: _____

system _____

series: TE

aquifer, formation, group Cφ

ology: _____

US Origin: _____

2 Aquifer Thickness: _____

30 Length of well open to: _____

ft _____

30 Depth to top of: _____

ft _____

459 _____

OR

IFER: _____

system _____

series _____

aquifer, formation, group Q6MA

ology: sd + gal

Origin: _____

Aquifer Thickness: 68 ft

Length of well open to: _____

ft 0

Depth to top of: _____

ft 26

ervals

ended: _____

h to

olidated rock: _____

ft _____

Source of data: _____

h to

ment: _____

ft _____

Source of data: _____

icial

rial: _____

Infiltration characteristics: _____

efficient

is: _____

gpd/ft _____

Coefficient Storage: _____

efficient

is: _____

gpd/ft²; Spec cap: _____

gpm/ft; Number of geologic cards: _____

Greenville Miss

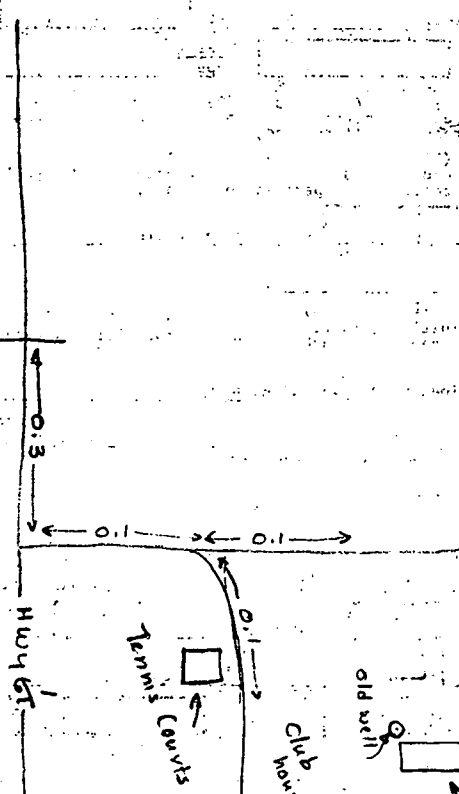

Well No.

693