

### WELL SCHEDULE

U. S. DEPT. OF THE INTERIOR

GEOLOGICAL SURVEY

WATER RESOURCES DIVISION

#### MASTER CARD

Record by RET Source of data MBOWC Date 3-20-6 Map \_\_\_\_\_

State 28 County (or town) Washington 76

Latitude: 33<sup>5</sup> 19<sup>7</sup> 12<sup>11</sup> N<sup>11</sup> Longitude: 09<sup>12</sup> 10<sup>13</sup> 27<sup>18</sup> Sequential number: 1<sup>19</sup>

Lat-long accuracy: 2<sup>2</sup> T. 17<sup>7</sup> S. R. 8<sup>8</sup> Sec 22<sup>10</sup> SE<sup>14</sup> NE<sup>15</sup> (SE, NE, 17)<sup>18</sup>

Local well number: G062DA2217NO8W Other number: \_\_\_\_\_

Local use: \_\_\_\_\_ Owner or name: Washington County - Bus Shop

Owner or name: WASH. COUNTY Address: Swiftwater, Miss

Ownership: County, Fed Gov't, City, Corp or Co, Private, State Agency, Water Dist C

Use of water: (A) Air cond, (B) Bottling, (C) Comm, (D) Dewater, (E) Power, (F) Fire, (G) Dom, (H) Irr, (I) Med, (J) P S, (K) Rec, (L) Stock, (M) Instit, (N) Unused, (O) Repressure, (P) Recharge, (Q) Desal-P S, (R) Desal-other, (S) Other C

Use of well: (A) Anode, (B) Drain, (C) Seismic, (D) Heat Res, (E) Obs, (F) Oil-gas, (G) Recharge, (H) Test, (I) Unused, (J) Withdraw, (K) Waste, (L) Destroyed W

DATA AVAILABLE: Well data  Freq. W/L meas.:  Field aquifer char.

Hyd. lab. data: \_\_\_\_\_

Qual. water data; type: \_\_\_\_\_ 1968

Freq. sampling: \_\_\_\_\_ Pumpage inventory:  yes  no; period: \_\_\_\_\_

Aperture cards: \_\_\_\_\_ yes

Log data: \_\_\_\_\_ D

#### WELL-DESCRIPTION CARD

SAME AS ON MASTER CARD Depth well: \_\_\_\_\_ ft 470 Meas. 3

Depth cased: (first perf.) \_\_\_\_\_ ft 450 Casing type: \_\_\_\_\_; Diam. 4.2 in 4

Finish: (C) porous concrete, (F) gravel w. (perf.), (G) gravel w. (screen), (H) horiz. gallery, (I) open end, (J) percuss, (K) rotary, (L) air reverse, (M) driven, (N) wash, (O) other 5

Method drilled: (A) air rot, (B) bored, (C) catle, (D) dug, (E) hyd jetted, (F) air rot., (G) percussion, (H) rotary, (I) reverse, (J) trenching, (K) driven, (L) wash, (M) other H

Date drilled: 4-64 964 Pump intake setting: \_\_\_\_\_ ft 8.4

Driller: Bailey Drlg Co Greenville

Lift (type): (A) air, (B) bucket, (C) cent, (D) jet, (E) multiple, (F) multiple, (G) none, (H) piston, (I) rot, (J) submerg, (K) turb, (L) other 5 Deep  Shallow

Power (type): nat LP diesel, elec, gas, gasoline, hand, gas, wind; H.P. 1 5 Trans. or meter no. \_\_\_\_\_

21 Descrip. MP 1/4" plug at 0.3' above LSD ft above below LSD, Alt. MP \_\_\_\_\_

20.5  
1.95  
1.3  
1.65  
Alt. LSD: \_\_\_\_\_ Accuracy: (source) 3

Water Level: \_\_\_\_\_ ft above below MP; Ft above below LSD 30 Accuracy: \_\_\_\_\_

Date meas: 4-16-64 464 Yield: \_\_\_\_\_ gpm \_\_\_\_\_ Method determined \_\_\_\_\_

Drawdown: \_\_\_\_\_ ft \_\_\_\_\_ Accuracy: \_\_\_\_\_ Pumping period \_\_\_\_\_ hrs \_\_\_\_\_

QUALITY OF WATER DATA: Iron \_\_\_\_\_ ppm \_\_\_\_\_ Sulfate \_\_\_\_\_ ppm \_\_\_\_\_ Chloride 393 ppm \_\_\_\_\_ Hard. \_\_\_\_\_ ppm \_\_\_\_\_

50 Sp. Conduct 1880 K x 10<sup>6</sup> 5 Temp. \_\_\_\_\_ °F 69 Date sampled \_\_\_\_\_

Taste, color, etc. \_\_\_\_\_

Well No. 962

Latitude-longitude N  
S  
d m s d m s

ROGEOLOGIC CARD

MEAS ON MASTER CARD Physiographic Province: 03 Section: \_\_\_\_\_

E Drainage Basin: 15I Subbasin: \_\_\_\_\_

(D) (C) (E) (F) (H) (K) (L)  
of depression, stream channel, dunes, flat, hilltop, sink, swamp,  
site: (Ø) (P) (S) (T) (U) (V)  
offshore, pediment, hillside, terrace, undulating, valley flat \_\_\_\_\_

R  
FER: TE Cockfield CØ  
system series aquifer, formation, group

ology: 45 Origin: 3 Aquifer Thickness: ≥ 80 ft

Length of well open to: \_\_\_\_\_ ft Depth to top of: 390 ft

R  
FER: Quat. Pluist. Miss. River alluvium  
system series aquifer, formation, group

ology: sd alluv Origin: Fluv. Aquifer Thickness: 20 ft

Length of well open to: 0 ft Depth to top of: 30 ft

ervals 450-470 ft 20' x 2"  
ened:

to \_\_\_\_\_ ft Source of data: \_\_\_\_\_

to \_\_\_\_\_ ft Source of data: \_\_\_\_\_

icial \_\_\_\_\_ Infiltration characteristics: \_\_\_\_\_

icient \_\_\_\_\_ gpd/ft \_\_\_\_\_ Coefficient Storage: \_\_\_\_\_

icient \_\_\_\_\_ gpd/ft<sup>2</sup>; Spec cap: \_\_\_\_\_ gpm/ft; Number of geologic cards: \_\_\_\_\_

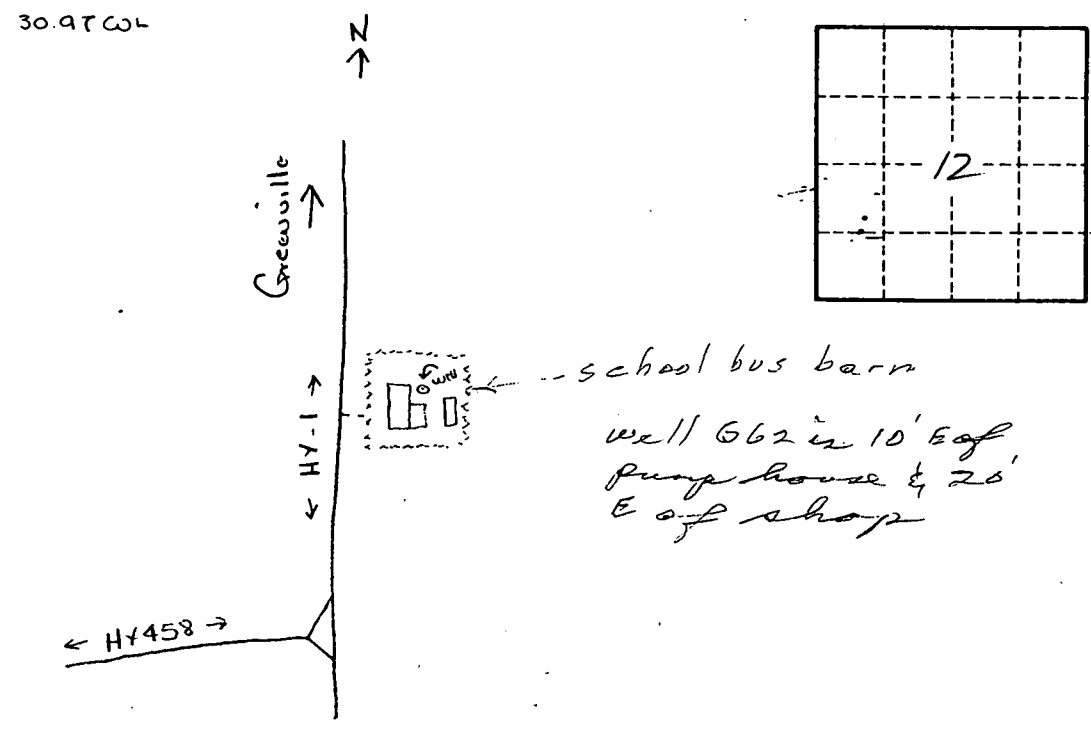

WELL NO. G-62

LOCATION WASH. Co. BUS BARN

WELL IS OUT SIDE  
WELL HOUSE

AH. 113

USE elec tape

DATE	HOLD	CUT	MP	LSD	COND
4-16-64				30	
7-14-81	44	9.05	34.95 .30	34.65	✓
4-17-91	could NOT GET GOOD MMT				
10-25-91	44.00	4.93	39.09 .30	38.77	✓

Updated  
5-12-92  
JPL