

WELL SCHEDULE

Log # 58

U. S. DEPT. OF THE INTERIOR

GEOLOGICAL SURVEY

WATER RESOURCES DIVISION

MASTER CARD

Record by P.E. Grantham Source of data Driv. + E Log Date 9-15-67 Map Refuge Quad

State Mississippi 28 County Washington Co 76
(or town)

Latitude: 33 20 36 N Longitude: 09 10 43 8 Sequential number: 2
deg min sec N S 12 degrees 15 min sec W

Lat-long accuracy: 2 T. 17 S. 9 Sec 14, NE, SE, SE (NE, SE, SE, 1)
20 30 40 50 60 70 80 90 100

Local well number: G040D01417N09W Other number: _____
21 25 30 34

Local use: 064058 Owner or name: National Packing Co.
35 40 45 51

Owner or name: NAT. PACKING CO. Address: Greenville, Miss
52 56 60 66 70 74

Ownership: County, Fed Gov't, City, Corp or Co, Private, State Agency, Water Dist N
(C) (F) (M) (N) (P) (S) (W)

Use of Air cond, Bottling, Comm, Dewater, Power, Fire, Dom, Irr, Med, Ind, P S, Rec, water: _____
(A) (B) (C) (D) (E) (F) (H) (I) (M) (N) (P) (R)

Stock, Instit, Unused, Repressure, Recharge, Desal-P S, Desal-other, Other Dog Food Co. N
(S) (T) (U) (V) (W) (X) (Y) (Z)

Use of well: Anode, Drain, Seismic, Heat Res, Obs, Oil-gas, Recharge, Test, Unused, Withdraw, Waste, Destroyed W
(A) (D) (G) (H) (I) (P) (R) (T) (U) (W) (X) (Z)

DATA AVAILABLE: Well data Freq. W/L meas.: Field aquifer char.
70 71 72

Hyd. lab. data: _____ 73

Qual. water data; type: _____ 74

Freq. sampling: _____ Pumpage inventory: yes no; period: _____ 75 76

Aperture cards: _____ yes 77

Log data: E Log 10-517, D (mbaunc) D
78 79

WELL-DESCRIPTION CARD

SAME AS ON MASTER CARD Depth well: 572' w/blank ft 561 Meas. accuracy 3
19 23 24

Depth cased; (first perf.) 521 ft 521 Casing type: Steel; Diam. 10.6 in 10
25 28 29 30

Finish: porous concrete, gravel w. screen, gravel w. screen, horiz. gallery, open end, perf., screen, sd. pt., shored, open hole, other G
(C) (F) (G) (H) (I) (P) (S) (T) (W) (X) (Z)

Method Drilled: air rot., bored, cable, dug, hyd jetted, air percussion, reverse rotary, trenching, driven, drive wash, other H
(A) (B) (C) (D) (H) (J) (P) (R) (T) (V) (W) (Z)

Date Drilled: 9-67 967 Pump intake setting: _____ ft _____
33 35 36 38

Driller: Layne Control, Cleveland, Miss
name address

Lift (type): air, bucket, cent, jet, multiple, multiple, nose, piston, rot, submerg, turb, other T Deep Shallow
(A) (B) (C) (J) (L) (M) (N) (P) (R) (S) (T) (Z)

Power (type): diesel, elec, gas, gasoline, hand, gas, wind; H.P. 40 V Trans. or meter no. _____
nat LP

Descrip. MP 122 ft above LSD. Alt. MP _____
above below

Alt. LSD: 115 115 Accuracy: Topo 3
42 45 47

Water Level _____ ft above MP; Ft. below LSD 63 Accuracy: _____ 52 D
48 51 52

Date meas: 10-67 067 Yield: 500 gpm 5:00 Method determined
53 55 56 60 61

Drawdown: _____ ft _____ Accuracy: _____ Pumping period _____ hrs _____ 62 63 64 65 66 68

QUALITY OF WATER DATA: Iron _____ Sulfate _____ Chloride _____ Hard. _____
ppm 69 ppm 70 ppm 71 ppm 72

Sp. Conduct _____ K x 10 6 Temp. _____ °F _____ Date sampled _____
73 74 76 77 79

Taste, color, etc. _____

Well No. G40

Latitude-longitude _____ N
_____ S
d m s d m s

HYDROGEOLOGIC CARD

SAME AS ON MASTER CARD
Physiographic Province: 03 Section: _____
Drainage Basin: E Subbasin: 15I

Top of well site: (D) depression, stream channel, dunes, flat, hilltop, sink, swamp, (E) offshore, pediment, hillside, terrace, undulating, valley flat
Type: V

JOB: _____
AQUIFER: _____ system _____ series TE Cockfield aquifer, formation, group Cφ

Geology: US Origin: 3 Aquifer Thickness: _____ ft
Length of well open to: _____ ft Depth to top of: 507 ft

NOR: Quat. Pleist. _____ Miss. River alluvium _____
AQUIFER: _____ system _____ series _____ aquifer, formation, group _____

Geology: sd-grl alluv Origin: Fluv Aquifer Thickness: 58 ft
Length of well open to: 0 ft Depth to top of: 26 ft

Intervals screened: 40' shutter screen x 6" - 521-561' - 6" SS.

Depth to consolidated rock: _____ ft Source of data: _____
Depth to cement: _____ ft Source of data: _____
Official serial: _____ Infiltration characteristics: _____
Efficient discharge: _____ gpd/ft Coefficient Storage: _____
Efficient discharge: _____ gpd/ft²; Spec cap: _____ gpm/ft; Number of geologic cards: _____

SEW of Greenville
" casing (lap),
V. 4" 3" space
ring & screen.

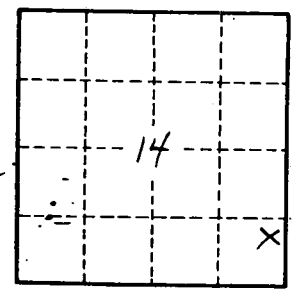
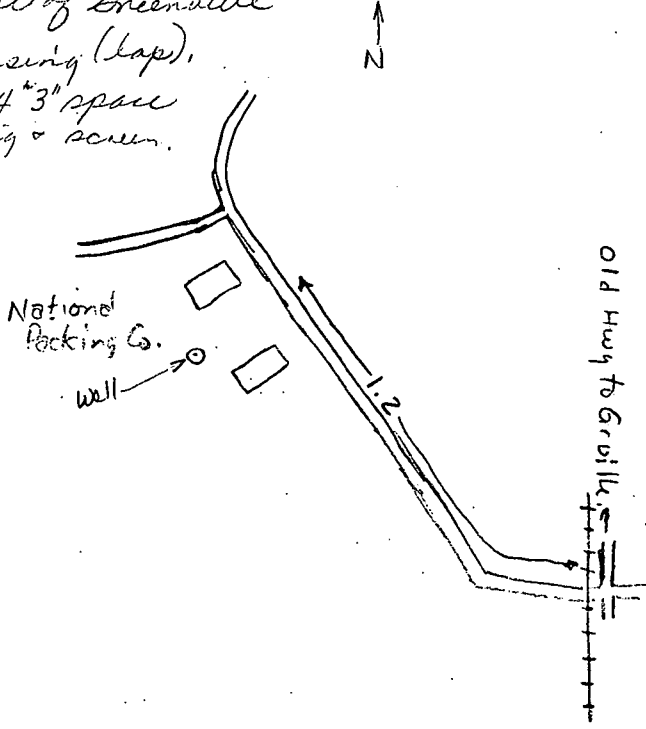

Well No. 940

