

WELL SCHEDULE E-Log #47
GEOLOGICAL SURVEY WATER RESOURCES DIVISION

U. S. DEPT. OF THE INTERIOR

MASTER CARD

Record by P.E. Grantham Source of data Drl & obs Date 9-5-63 Map Refuge Quad

State Mississippi County (or town) Washington Sequential number: 1

Latitude: 33 deg 16 min 15 sec N Longitude: 09 deg 10 min 29 sec W

Lat-long accuracy: 2 T. 17 S, R. 8 Sec 5, Irregular (SE, SE, 33)

Local well number: 5038 3517 N08W Other number: _____

Local use: _____ Owner or name: Dow Chemical Co Address: Wayside, Miss

Ownership: County, Fed Gov't, City, Comp or Co, Private, State Agency, Water Dist _____

Use of water: Air cond, Bottling, Comm, Dewater, Power, Fire, Dom, Irr, Med, Ind, P S, Rec, Stock, Instit, Unused, Repressure, Recharge, Desal-P S, Desal-other, Other _____

Use of well: Anode, Drain, Seismic, Heat Res, Obs, Oil-gas, Recharge, Test; Unused, Withdraw, Waste, Destroyed _____

DATA AVAILABLE: Well data Freq. W/L meas.: Field aquifer char.

Hyd. lab. data: _____

Qual. water data; type: USGS Complete

Freq. sampling: Pumpage inventory: yes no, period: _____

Aperture cards: _____ yes

Log data: E log 4-1976' - Widco, Driller's DE

WELL-DESCRIPTION CARD

SAME AS ON MASTER CARD Depth well: 1930 ft Meas. accuracy 3

Depth cased; (first perf.) 1860 ft Casing type: _____; Diam. 4, 3 in

Finish: porous concrete, gravel v. concrete, (perf.), gravel v. (screen), horiz. gallery, end, open perf., screen, sd.-pt., shored, open hole, other _____

Method Drilled: air bored, cable, dug, hyd jetted, air reverse, percussion, rotary, trenching, driven, drive wash, other _____

Date Drilled: 10-1963 963 Pump intake setting: _____ ft

Driller: Bailey Drilling Co, Greenville Miss

Lift (type): air, bucket, cent, jet, multiple, multiple, (cent.), noise, piston, rot, submerg, turb, other _____ Deep _____

Power (type): diesel, elec, nat gas, gasoline, hand, gas, wind; H.P. 1/2 Trans. or meter no. _____

Descr. MP _____ ft above below LSD. Alt. MP _____

Alt. LSD: 115 Accuracy: (source) topo 5ft

Water Level: 450 ft above below MP; Ft below LSD +50 Accuracy: reported

Date meas: 10-63 063 Yield: _____ gpm Method determined _____

Drawdown: _____ ft Accuracy: _____ Pumping period _____ hrs

QUALITY OF WATER DATA: Iron 2.1 ppm Sulfate 0.2 ppm Chloride 144 ppm Hard. 4 ppm

Sp. Conduct 1740 K x 10⁶ 5 Temp. 66 °F 66 Date sampled 11-1-63 N63

Taste, color, etc. Sample from start - Nov 67 Sp. Cond. = 1700 T = 66°F

Well No. G38

Latitude-longitude N
S
d m s d m s

HYDROGEOLOGIC CARD

NAME AS ON MASTER CARD: Physiographic Province: Coastal Plain 03 Section: Miss. River

Drainage Basin: 15I Subbasin:

of depression, stream channel, dunes, flat, hilltop, sink, swamp, site: (V)

offshore, pediment, hillside, terrace, undulating, valley flat

IR FER: Tertiary, Eocene TE Meridian - upper Wilcox MW

geology: Unconsolidated sand US Origin: Deltaic 3 Aquifer Thickness: ≥ 71 ft

Length of well open to: ft 70 Depth to top of: 1859 ft A86

IR FER: ,

geology:

Length of well open to: ft Depth to top of: ft

Observations:

Height to consolidated rock: ft Source of data:

Height to cement: ft Source of data:

Infiltration characteristics:

Efficient: gpd/ft Coefficient Storage:

Efficient: gpd/ft²; Spec cap: gpm/ft; Number of geologic cards:

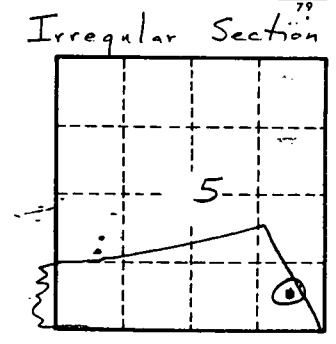
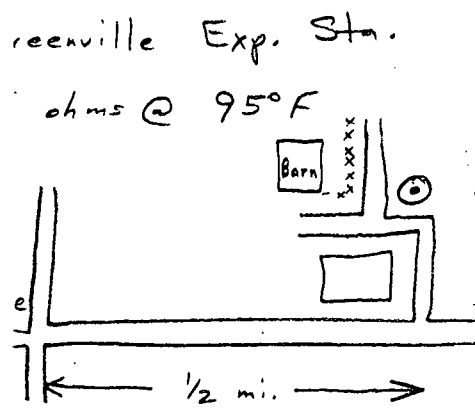

measured WL 25 psi = +57.80 ft ≈ +60 ft GL

on PW sheet WL = +92 ft above GL

-17-68 Sampled for
Discarded solids
5 lbs psi

Well No. 638