

WELL SCHEDULE

U. S. DEPT. OF THE INTERIOR

GEOLOGICAL SURVEY

WATER RESOURCES DIVISION

MASTER CARD

Record by B. E. Wasson Source of data \_\_\_\_\_ Date 4-27-62 Map Refuge

State Mississippi 28 County (or town) Washington 76

Latitude: 33 18 42 N Longitude: 09 10 34 7 Sequential number: 1

Lat-long accuracy: 2 17 2 24 NW NE (NW, NE, 19)

Local well number: G029BA2417NOPW Other number: \_\_\_\_\_

Local use: \_\_\_\_\_ Owner or name: Mrs Sweet

Owner or name: MRS SWEET Address: Greenville, Miss

Ownership: (C) County, (F) Fed Gov't, (M) City, Corp or Co, (N) Private, (S) State Agency, (W) Water Dist. P

Use of water: (A) Air cond, (B) Bottling, (C) Comm, (D) Dewater, (E) Power, (F) Fire, (G) Irr, (H) Med, (I) P S, (J) Rec, (K) Stock, (L) Instat, (M) Unused, (N) Repressure, (O) Recharge, (P) Desal-P S, (Q) Desal-other, (R) Other. H

Use of well: (A) Anode, (B) Drain, (C) Seismic, (D) Heat Res, (E) Obs, (F) Oil-gas, (G) Recharge, (H) Test, (I) Unused, (J) Withdraw, (K) Waste, (L) Destroyed. W

DATA AVAILABLE: Well data  Freq. W/L meas.:  Field aquifer char.

Hyd. lab. data: \_\_\_\_\_

Qual. water data; type: USGS partial (field)

Freq. sampling:  Pumpage inventory: yes  no, period: \_\_\_\_\_

Aperture cards: \_\_\_\_\_

Log data: \_\_\_\_\_

WELL-DESCRIPTION CARD

SAME AS ON MASTER CARD Depth well: 41 ft 41 Meas. rept. 1

Depth cased; (first perf.) \_\_\_\_\_ ft \_\_\_\_\_ Casing type: \_\_\_\_\_; Diam. 1/4 in \_\_\_\_\_

Finish: (C) porous concrete, (F) gravel w. (perf.), (G) gravel w. (screen), (H) horiz. gallery, (I) open perf., (J) screen, (K) shored, (L) open hole, (M) other. 7

Method Drilled: (A) air rot, (B) bored, (C) cable, (D) dug, (E) hyd rot., (F) jetted, (G) air rot., (H) percussion, (I) rotary, (J) reverse, (K) trenching, (L) driven, (M) drive wash, (N) other. Y

Date Drilled: \_\_\_\_\_ Pump intake setting: \_\_\_\_\_ ft \_\_\_\_\_

Driller: \_\_\_\_\_ name \_\_\_\_\_ address \_\_\_\_\_

Lift (type): (A) air, (B) bucket, (C) cent, (D) jet, (E) multiple, (F) multiple, (G) none, (H) none, (I) none, (J) none, (K) none, (L) none, (M) none, (N) none, (O) none, (P) none, (Q) none, (R) none, (S) none, (T) none, (U) none, (V) none, (W) none, (X) none, (Y) none, (Z) none. P Deep  Shallow

Power (type): (A) diesel, (B) elec, (C) gas, (D) gasoline, (E) hand, (F) gas, (G) wind, (H) H.P. 1 Trans. or meter no. \_\_\_\_\_

Descrip. MP Month of pitcher pump 1.0 ft above below LSD. Alt. MP \_\_\_\_\_

Alt. LSD: 116 Accuracy: (source) 1000

Water Level 4.63 ft above below MP; Ft above below LSD 4 Accuracy: typical

Date meas: 4-27-62 Yield: \_\_\_\_\_ gpm Method determined \_\_\_\_\_

Drawdown: \_\_\_\_\_ ft Accuracy: \_\_\_\_\_ Pumping period \_\_\_\_\_ hrs \_\_\_\_\_

QUALITY OF WATER DATA: Iron \_\_\_\_\_ ppm Sulfate \_\_\_\_\_ ppm Chloride 22 Hard. 376

Sp. Conduct 390 K x 10<sup>6</sup> 3 Temp. 64.5 °F 64 Date sampled 4-27-62 462

Taste, color, etc. pH = 7.0

Well No. G29

Latitude-longitude N  
S  
d m s d m s

**HYDROGEOLOGIC CARD**

NAME AS ON MASTER CARD: Coastal Plain Physiographic Province: 03 Section: Miss. River

Drainage Basin: E Subbasin: 15I

of site: (D) depression, stream channel, dunes, flat, hilltop, sink, swamp, (E) offshore, pediment, hillside, terrace, undulating, valley flat (V)

PERIOD: Quaternary system, Pleistocene series, Q.G aquifer, formation, group, Miss. River alluvium aquifer, formation, group

Geology: sand & gravel alluvium Origin: Fluvial Aquifer Thickness: 2 ft

Length of well open to: 37 ft Depth to top of: 41 ft

Length of well open to: 33 ft Depth to top of: 50 ft

Interval: 60-63 ft Source of data: 64

Interval: 65-68 ft Source of data: 69

Interval: 70-71 ft Infiltration characteristics: 72

Efficient: 73 gpd/ft<sup>2</sup> Coefficient Storage: 76

Efficient: 73 gpd/ft<sup>2</sup>; Spec cap: 75 gpm/ft; Number of geologic cards: 79

L 8.91 ft (MP). 5/18/62

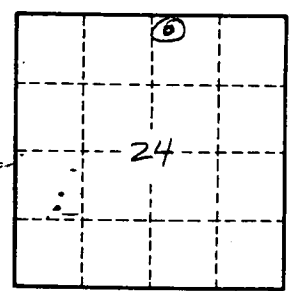
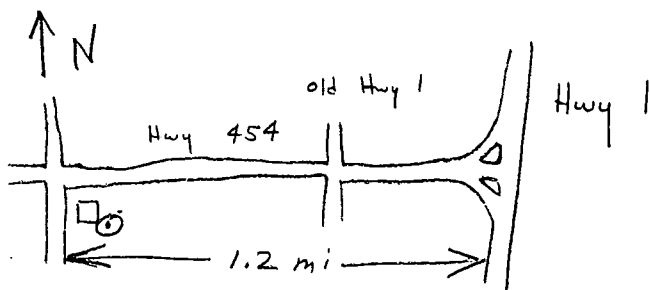

Well No. 629