

6/78 WTO

Recorded by \_\_\_\_\_

Date \_\_\_\_\_

U.S. GEOLOGICAL SURVEY  
WATER RESOURCES DIVISION  
MISSISSIPPI DISTRICT  
WELL RECORD

Well No. 516  
E-Log No. \_\_\_\_\_  
County Wash.

*Irrigation Well*

Site ID 331929091004302 R=0\* T=A\* 19

2=W\* #5 Washington

Data reliab. 3=C\* Report. agency 4=USGS\* Dist. 6=28\* 7=28\* Co. 8=151\*

Lat. Long. 9=331929\* 10=0910043\* Well No. 12=5016\*

Location 13=NWNW S 20 T 17 N R 0.8 W\* Alt. 16=117.\*

Hyd. Unit (OWDC) 20= \_\_\_\_\_ Date 21=0911111980\*

Well use 23=W\* Water Use 24=I\* Hole depth 27= \_\_\_\_\_ Well depth 28=110.\*

WL 30=21.\* Date 31=0911111980\* Source 33=S\*

Status 273= \_\_\_\_\_ Project No. 5= \_\_\_\_\_

R=158\* T=A\* Date 159# 0110111980\* Owner No. \_\_\_\_\_

Owner 16=HOMERWOOD FARMS\*

R=192\* T=A\* Date 193# \_\_\_\_\_ Temp. 196#00010\* 197= \_\_\_\_\_

R=192\* T=A\* Date 193# \_\_\_\_\_ Cond. 196#00095\* 197= \_\_\_\_\_

R=192\* T=A\* Date 193# \_\_\_\_\_ pH 196#00400\* 197= \_\_\_\_\_

R=58\* T=A\* 59#1\* Date 60=0110111980\* Remarks \_\_\_\_\_

Drig. 63= \_\_\_\_\_ Name \_\_\_\_\_ Method 65=R\* Finish 66= \_\_\_\_\_

R=76\* T=A\* 59#1\* Top csgn. 77# 0.\* Bot. csgn. 78= \_\_\_\_\_ Diam. 79# 18.0\*

R=76\* T=A\* 59#1\* Top csgn. 77# \_\_\_\_\_ Bot. csgn. 78= \_\_\_\_\_ Diam. 79# \_\_\_\_\_

R=82\* T=A\* 59#1\* Top 83# \_\_\_\_\_ Bottom 84= \_\_\_\_\_

Type 85= \_\_\_\_\_ Diam. 87= \_\_\_\_\_ Size 88= \_\_\_\_\_

R=82\* T=A\* 59#1\* Top 83# \_\_\_\_\_ Bottom 84= \_\_\_\_\_

Type 85= \_\_\_\_\_ Diam. 87= \_\_\_\_\_ Size 88= \_\_\_\_\_

R= \_\_\_\_\_ T=A\* 147# 1\* Q 150= \_\_\_\_\_ Q/S 272= \_\_\_\_\_

134 flows 146 mmoed

GEN. SITE DATA

OWNER

FIELD OR

CONSTR.

CASING

OPENINGS

YIELD

**LIFT**  
 R=42\* T= A \* Lift type 43# \* Intake 44= \* Power type 45= \*  
 Date 38= / / \* H.P. 46= . \* \*

**LOGS**  
 R=198\* T= A \* Log 199# \* Top 200= \* Bot 201= \*  
 R=198\* T= A \* Log 199# \* Top 200= \* Bot 201= \*  
 R=189\* T= A \* E Log No. 190# \* 191= M I S S D I S T \*

**ANAL.**  
 R=114\* T= A \* Year 115# \* Type 120= \* \*

**AQUIFERS**  
 R=90\* T= A \* 256# 1 \* Top 91= \* Bot 92= \*  
 Unit ID 93= 112MRVA \* Name of Unit \_\_\_\_\_  
 R=90\* T= A \* 256# 1 \* Top 91= \* Bot 92= \*  
 Unit ID 93= \* Name of Unit \_\_\_\_\_

**HYDRAULICS**  
 R=98\* T= A \* 99# 1 \* Unit tested 100= \* 103= \*  
 R=105\* T= A \* 99# 1 \* Test No. 106# \*  
 107= \* Transmissivity (gal/d)/ft \_\_\_\_\_  
 108= \* Hydraul. cond. (gal/d)/ft<sup>2</sup> \_\_\_\_\_  
 110= \* Storage coeff. Boundaries \_\_\_\_\_

R=121\* T= \* Yr Begin 122# \* Network 258= \* \*

Water Level Data Collection (1)

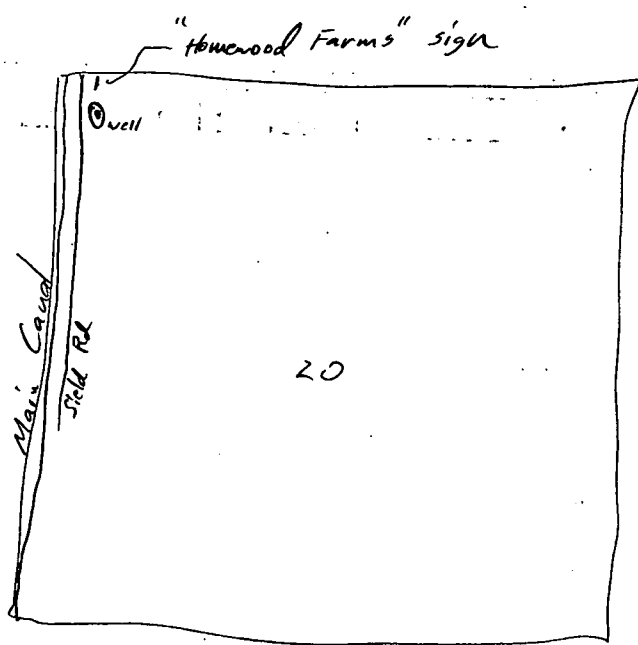

12/14/82  
 36  
 6.44  
 29.56  
 14  
 15.56  
 Surveyed 5/13/83 to  
 top of NE pump base  
 Plunge corner (ELV=117.0')  
 LSD ELV=113.33'