

### WELL SCHEDULE

U. S. DEPT. OF THE INTERIOR

GEOLOGICAL SURVEY

WATER RESOURCES DIVISION

#### MASTER CARD

Record by E.J. Harvey Source of data R.E.A. Date 1-26-54 Map Refuge Quad

State Mississippi County Washington Sequential number: 716

Latitude: 33 deg 17 min 46 sec N Longitude: 09 deg 10 min 04 sec W

Lat-long accuracy: 2 T. 17 S, R. 8 E Sec 32, NW & NE & (NW, NE, 27)

Local well number: G007BA3217N08W Other number: \_\_\_\_\_

Local use: \_\_\_\_\_ Owner or name: H.B. Sunkel

Owner or name: HAROLD B SUNKEL Address: Greenville, Miss.

Ownership: County, Fed Gov't, City, Corp or Co, Private, State Agency, Water Dist P

Use of Air cond, Bottling, Comm, Dewater, Power, Fire, Dom, Irr, Med, Ind, P S, Rec, water: \_\_\_\_\_

Stock, Instit, House, Repressure, Recharge, Desal-P S, Desal-other, Other Rice

Use of well: Anode, Drain, Seismic, Heat Res, Obs, Oil-gas, Recharge, Test, Unused, Withdraw, Waste, Destroyed U

DATA AVAILABLE: Well data  Freq. W/L meas.: original  Field aquifer char.

Hyd. lab. data: \_\_\_\_\_

Qual. water data; type: \_\_\_\_\_

Freq. sampling: none  Pumpage inventory: no, period: \_\_\_\_\_ yes

Aperture cards: \_\_\_\_\_ yes

Log data: \_\_\_\_\_

#### WELL-DESCRIPTION CARD

SAME AS ON MASTER CARD Depth well: 105 ft Meas. 105 Meas. 6

Depth cased; (first perf.) 65 ft Casing type: \_\_\_\_\_; Diám. 12 in

Finish: porous gravel w. concrete, (perf.), gravel w. (screen), (H) horiz. gallery, end, (P) perf., (S) screen, (T) sd. pt., (W) shored, (X) open hole, (Z) other S

Method (A) (B) (C) (D) (E) (F) (G) (H) (J) (K) (L) (M) (N) (P) (R) (S) (T) (V) (W) (Z) H

Drilled: air bored, cable, dug, hyd rot., jetted, air percussion, rotary, reverse trenching, driven, drive wash, other

Date Drilled: Jan 1953 9 5 3 Pump intake setting: \_\_\_\_\_ ft

Driller: Delta Well Service

Lift (type): air, bucket, cent, jet, multiple, multiple, (cent.), none, piston, rot, submerg, turb, other N Deep  Shallow

Power (type): diesel, elec, gas, gasoline, hand, gas, wind; H.P. \_\_\_\_\_ Trans. or meter no. \_\_\_\_\_

Descrip. MP \_\_\_\_\_ ft above LSD. Alt. MP \_\_\_\_\_

Alt. LSD: 116 Accuracy: (source) 3

Water Level 25 ft above below MP; Ft below LSD 25 Accuracy: 6

Date meas: 1 5 4 Yield: \_\_\_\_\_ gpm Method determined 61

Drawdown: \_\_\_\_\_ ft Accuracy: \_\_\_\_\_ Pumping period \_\_\_\_\_ hr

QUALITY OF WATER DATA: Iron \_\_\_\_\_ ppm Sulfate \_\_\_\_\_ ppm Chloride \_\_\_\_\_ ppm Hard. \_\_\_\_\_ ppm

Sp. Conduct \_\_\_\_\_ K x 10<sup>6</sup> Temp. \_\_\_\_\_ °F Date sampled \_\_\_\_\_

Taste, color, etc. \_\_\_\_\_

Well No. 67

Latitude-longitude N  
S  
d m s d m s

**HYDROGEOLOGIC CARD**

NAME AS ON MASTER CARD \_\_\_\_\_ Physiographic Province: Coastal Plain 03 Section: Miss. River

Drainage Basin: E 157 Subbasin: \_\_\_\_\_

of site: (D) depression, stream channel, dunes, flat, hilltop, sink, swamp, (E) offshore, pediment, hillside, terrace, undulating, valley flat (V) \_\_\_\_\_

SYSTEM: Quaternary Pleistocene Q1G Miss. River alluvium M1A

Geology: sand & gravel alluvium 9A Origin: Fluvial 2 Aquifer Thickness: \_\_\_\_\_ ft

Length of well open to: 40 ft Depth to top of: \_\_\_\_\_ ft

SYSTEM: \_\_\_\_\_ series \_\_\_\_\_ aquifer, formation, group \_\_\_\_\_ Aquifer Thickness: \_\_\_\_\_ ft

Length of well open to: \_\_\_\_\_ ft Depth to top of: \_\_\_\_\_ ft

Intervals screened: 65 - 105 ft 40 ft 0.06 99% screen

Height to consolidated rock: \_\_\_\_\_ ft Source of data: \_\_\_\_\_

Height to cement: \_\_\_\_\_ ft Source of data: \_\_\_\_\_

Hydraulic characteristics: \_\_\_\_\_ Infiltration characteristics: \_\_\_\_\_

Efficient storage: \_\_\_\_\_ gpd/ft<sup>2</sup> Coefficient Storage: \_\_\_\_\_

Efficient storage: \_\_\_\_\_ gpd/ft<sup>2</sup>; Spec cap: \_\_\_\_\_ gpm/ft; Number of geologic cards: \_\_\_\_\_

Driller: J.V. Thompson  
 Owner: Bill Jobe

Well was abandoned in Spring 1954  
 on account of faulty construction  
 replaced by well G9  
 Well drilled to 135 ft, pulled back to 105'  
 and well about 50 ft away abandoned  
 well to have Johnston Turbine w/8" discharge (JC6123)

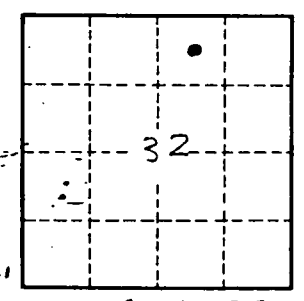

7.9 mi SE  
 Greenville

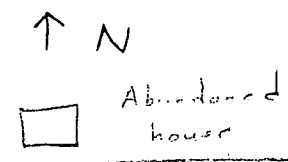

Well No. G7