

PUNCHED and VERIFIED
ROLLA COMPUTATION BRANCH

WRD Ex., (GW)
April 1966

Well No. E 22

WELL SCHEDULE

U. S. DEPT. OF THE INTERIOR

GEOLOGICAL SURVEY

WATER RESOURCES DIVISION

MASTER CARD

Record by G.F. Brown Source of data _____ Date 5-16-39 Map Tralake Quad

State Mississippi 28 County Washington 76
(or town)

Latitude: 33 23 54 N Longitude: 090 57 13 Sequential number: 1
deg 7 min 11 sec 12 degrees 15 min sec 18

Lat-long accuracy: 2 T. 18 S, R 7 Sec 20, NW 1/4, NW 1/4, _____
Local well number: E022BB2018N07W Other number: _____ B & M

Local use: _____ Owner or name: Mrs J.P. Hammond

Owner or name: J P HAMMOND Address: _____

Ownership: (C) County, (F) Fed Gov't, (M) City, (N) Corp or Co, (P) Private, (S) State Agency, (W) Water Dist _____ P

Use of water: (A) Air cond, (B) Bottling, (C) Comm, (D) Dewater, (E) Power, (F) Fire, (G) Irr, (H) Med, (I) P S, (J) Rec, (K) Stock, (L) Instit, (M) Unused, (N) Recharge, (O) Desal-P S, (P) Desal-other, (Q) Other _____ H

Use of well: (A) Anode, (B) Drain, (C) Seismic, (D) Heat Res, (E) Obs, (F) Oil-gas, (G) Recharge, (H) Test, (I) Unused, (J) Withdraw, (K) Waste, (L) Destroyed _____ W

DATA AVAILABLE: Well data Freq. W/L meas.: original Field aquifer char. _____

Hyd. lab. data: _____

Qual. water data; type: _____

Freq. sampling: none Pumpage inventory: yes _____ no, period: _____

Aperture cards: _____ yes _____

Log data: _____

WELL-DESCRIPTION CARD

SAME AS ON MASTER CARD Depth well: 540 ft 540 Meas. accuracy: G
Depth cased: 500 ft 500 Casing type: BI; Diam. 3-2 in _____

Finish: (C) porous concrete, (F) gravel w. (perfor.), (G) gravel w. (screen), (H) horiz. gallery, (I) open end, (J) perf., (K) screen, (L) sd. pt., (M) shored, (N) open hole, (O) other _____ S

Method: (A) air bored, (B) cable, (C) dug, (D) hyd rot, (E) jetted, (F) percussion, (G) rotary, (H) reverse, (I) trenching, (J) driven, (K) drive wash, (L) other _____ H

Date Drilled: Summer 1933 9 3 3 Pump intake setting: _____ ft _____

Driller: L.S. Journey name Carrollton Miss. address

Lift (type): (A) air, (B) bucket, (C) cent., (D) jet, (E) multiple, (F) multiple, (G) none, (H) piston, (I) rot., (J) submerg, (K) turb., (L) other _____ P Deep _____ Shallow _____

Power (type): (A) diesel, (B) elec, (C) gas, (D) gasoline, (E) hand, (F) gas, (G) wind, (H) H.P. 1/3 _____ S Trans. or meter no. _____

Descrip. MP top of 1" pipe, which is 1.3 ft above below LSD. Alt. MP 118.68

Alt. LSD: 117.38 117 Accuracy: (source) instrument _____

Water Level 14.26 ft above below MP; ft above below LSD 13 Accuracy: typed _____

Date meas: 5-16-39 5 3 9 Yield: 250 gph 4 gpm _____ 4 Method determined _____

Drawdown: _____ ft _____ Accuracy: _____ Pumping period _____ hrs _____

QUALITY OF WATER DATA: Iron _____ ppm Sulfate _____ ppm Chloride _____ ppm Hard. _____ ppm

Sp. Conduct. _____ K x 10⁶ _____ Temp. _____ °F _____ Date sampled _____

Taste, color, etc. reported soft; slightly yellow

Well No. E 22

Well No. E22

Latitude-longitude _____
d m s d m s

HYDROGEOLOGIC CARD

SAME AS ON MASTER CARD Physiographic Province: Coastal Plain 03 Section: Miss. River

Alluvial plain E Drainage Basin: 15I Subbasin: _____

Topo of well site: (D) depression, stream channel, dunes, flat, hilltop, sink, swamp, (C) (E) (F) (H) (K) (L) (V) (V) offshore, pediment, hillside, terrace, undulating, valley flat 27

MAJOR AQUIFER: Tertiary system Eocene series TE Cockfield aquifer, formation, group C 0

Lithology: unconsolidated sand US Origin: Deltaic 3 Aquifer Thickness: _____ ft
Length of well open to: 40 ft 40 Depth to top of: 500 ft

MINOR AQUIFER: _____ system _____ series _____ aquifer, formation, group _____ Aquifer Thickness: _____ ft

Lithology: _____ Origin: _____ Depth to top of: _____ ft
Length of well open to: _____ ft _____ Depth to top of: _____ ft

Intervals Screened: 500 - 540 ft

Depth to consolidated rock: _____ ft _____ Source of data: _____

Depth to basement: _____ ft _____ Source of data: _____

Surficial material: _____ Infiltration characteristics: _____

Coefficient Trans: _____ gpd/ft _____ Coefficient Storage: _____

Coefficient Perm: _____ gpd/ft²; Spec cap: _____ gpm/ft; Number of geologic cards: _____

Formation reported: Lisbon 500-540'

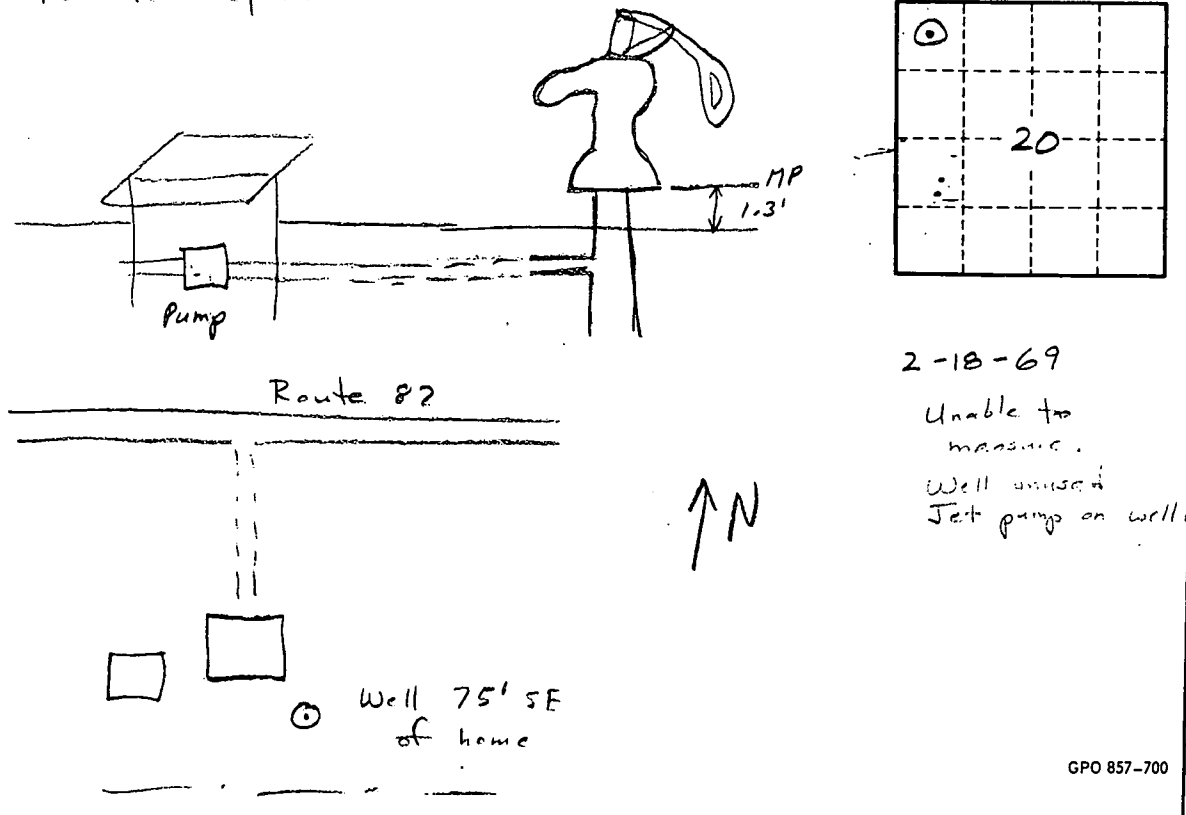

2-18-69
Unable to measure.
Well unused
Jet pump on well.

Well No. E22