

WRD Exp. (GW)  
April 1966

Well No. D 80

### WELL SCHEDULE

U. S. DEPT. OF THE INTERIOR

GEOLOGICAL SURVEY

WATER RESOURCES DIVISION

#### MASTER CARD

Record by W.T. OAKLEY Source of data OWNER Date 1-29-68 Map \_\_\_\_\_

State MISSISSIPPI 28 County (or town) WASHINGTON 76

Latitude: 33 25 27 N Longitude: 09 05 29 Sequential number: 1

Lat-long accuracy: 2 T. 18 S. R. 8 Sec 13 SE NE (SE, NE 11)

Local well number: D 080 D A 13 18 N 08 W Other number: \_\_\_\_\_

Local use: \_\_\_\_\_ Owner or name: H.K. HAMMETT

Owner or name: H. K. HAMMETT Address: GREENVILLE MISS

Ownership: County, Fed Gov't, City, Corp or Co, Private, State Agency, Water Dist P

Use of water: (A) Air cond, (B) Bottling, (C) Comm, (D) Dewater, (E) Power, (F) Fire, (G) Dom, (H) Irr, (I) Med, (J) P S, (K) Rec, (L) Stock, (M) Instit, (N) Unused, (O) Repressure, (P) Recharge, (Q) Desal-P S, (R) Desal-other, (S) Other D

Use of well: (A) Anode, (B) Drain, (C) Seismic, (D) Heat Res, (E) Obs, (F) Oil-gas, (G) Recharge, (H) Test, (I) Unused, (J) Withdraw, (K) Waste, (L) Destroyed W

DATA AVAILABLE: Well data  Freq. W/L meas.: original  Field aquifer char.

Hyd. lab. data: \_\_\_\_\_

Qual. water data; type: USGS COMPLETE

Freq. sampling: original  Pumpage inventory: yes  no; period: \_\_\_\_\_

Aperture cards: \_\_\_\_\_ yes

Log data: \_\_\_\_\_

#### WELL-DESCRIPTION CARD

SAME AS ON MASTER CARD Depth well: 1800 ft 1800 Meas. accuracy 6

Depth cased: \_\_\_\_\_ ft Casing type: Black Iron; Diam. 4 in 4

Finish: (C) porous concrete, (F) gravel w. (perf.), (G) gravel w. (screen), (H) horiz. gallery, (I) open end, (J) perf., (K) screen, (L) sd-pt., (M) shored, (N) open hole, (O) other S

Method Drilled: (A) air rot, (B) bored, (C) cable, (D) dug, (E) hyd rot, (F) jetted, (G) air percussion, (H) reverse, (I) trenching, (J) driven, (K) wash, (L) other H

Date Drilled: 1940 940 Pump intake setting: \_\_\_\_\_ ft

Driller: C.M. Jounney GREENWOOD MISS.

Lift (type): (A) air, (B) bucket, (C) cent, (D) jet, (E) multiple, (F) multiple, (G) none, (H) piston, (I) rot, (J) submerg, (K) turb, (L) other N Deep  Shallow

Power (type): diesel, elec, gas, gasoline, hand, gas, wind; H.P. flow  Trans. or meter no. \_\_\_\_\_

Descrip. MP \_\_\_\_\_ ft above \_\_\_\_\_ ft below LSD, Alt. MP \_\_\_\_\_

Alt. LSD: 121 Accuracy: (source) 3

Water Level: 52.10 ft above MP; Ft below LSD +5.2 Accuracy: gaged

Date meas: 1-29-68 168 Yield: \_\_\_\_\_ gpm Method determined 61

Drawdown: \_\_\_\_\_ ft Accuracy: \_\_\_\_\_ Pumping period \_\_\_\_\_ hrs

QUALITY OF WATER DATA: Iron \_\_\_\_\_ Sulfate \_\_\_\_\_ Chloride \_\_\_\_\_ Hard. \_\_\_\_\_

Sp. Conduct 1305 K x 10 5 Temp. 76 °F Date sampled Feb. 19, 1968 268

Taste, color, etc. water brown color Field PH = 8.3

PUNCHED AND VERIFIED  
ROLLA MISSOURI BRANCH

DS = 786

Well No. D 80

Well No. D 80

Latitude-longitude N  
S  
d m s d m s

HYDROGEOLOGIC CARD

SAME AS ON MASTER CARD Physiographic Province: Coastal Plain 0:3 Section: Miss River

Alluvial Plain E 15:1 Subbasin: 26

(D) (C) (E) (P) (R) (K) (L)  
Topo of depression, stream channel, dunes, flat, hilltop, sink, swamp,  
well site: (Ø) (P) (S) (T) (U) (V)  
offshore, pediment, hillside, terrace, undulating, valley flat 27  V

MAJOR AQUIFER: Tertiary Eocene T E Tallahatta T A  
system series aquifer, formation, group

Lithology: Unconsolidated sand U S Origin: Alluvial 3 Aquifer Thickness: ft

Length of well open to: 30 ft 30 Depth to top of: ft

MINOR AQUIFER: 44 45 aquifer, formation, group 46 47

Lithology: 48 49 Origin: 50 Aquifer Thickness: ft

Length of well open to: ft 54 56 Depth to top of: ft 57 59

Intervals Screened:

Depth to consolidated rock: ft 60 63 Source of data: 64

Depth to basement: ft 65 68 Source of data: 69

Surficial material: 70 71 Infiltration characteristics: 72

Coefficient Trans: gpd/ft 73 75 Coefficient Storage: 76 78

Coefficient Perm: gpd/ft<sup>2</sup> ; Spec cap: gpm/ft; Number of geologic cards: 79

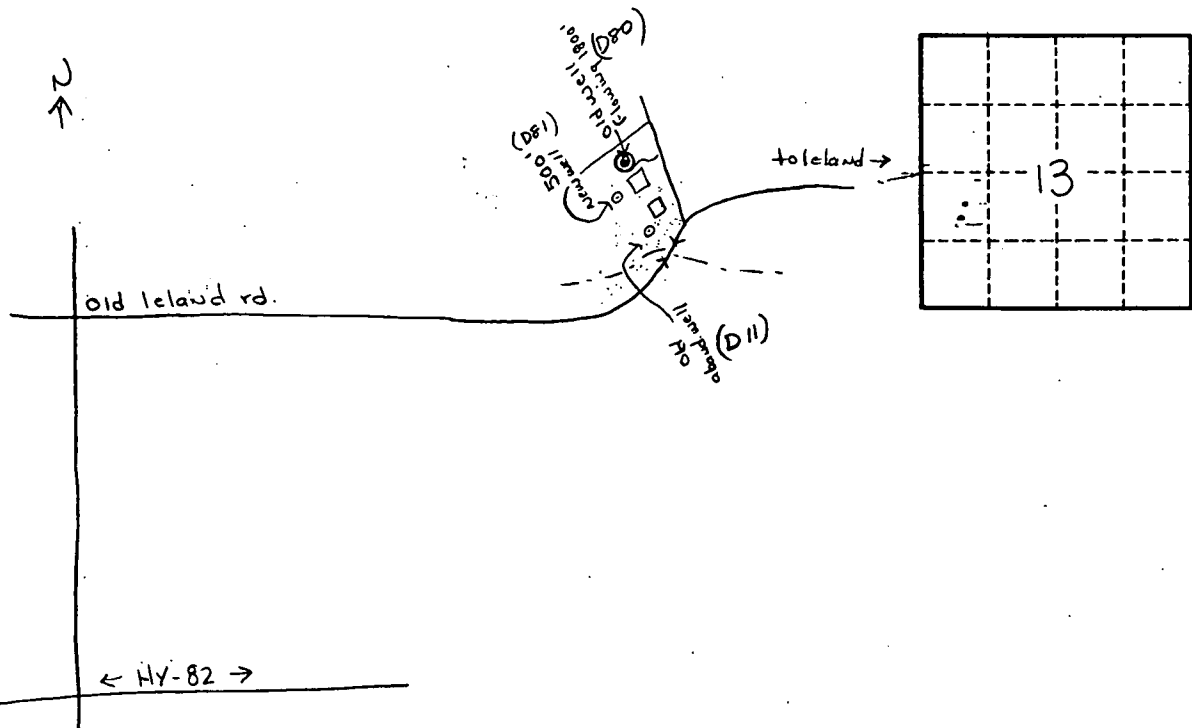

Well No. D 80