

WELL SCHEDULE

West Well

U. S. DEPT. OF THE INTERIOR

GEOLOGICAL SURVEY

WATER RESOURCES DIVISION

MASTER CARD

Record by WF POWELL Source of data Plant Eng. Date 7-13-55 Map _____

State Mississippi County Washington Sequential number: 2

Latitude: 33° 24' 45" N Longitude: 091° 01' 40" W

Lat-long accuracy: 2 T. 18 S. R. 8 Sec 18, Irregular (NW, NE, NE, 16)

Local well number: D0351818N08W Other number: #1 (West well)

Local use: 064 Owner or name: Greenville Mills Inc.

Owner or name: GREENVILLE MILL Address: Greenville, Miss.

Ownership: County, Fed Gov't, City, Corp or Co, Private, State Agency, Water Dist D

Use of water: (A) Air cond, Bottling, Comm, Dewater, Power, Fire, Dom, Irr, Med, P S, Rec, (N) P S, Rec, (P) Stock, Instit, Unused, Repressure, Recharge, Desal-P S, Desal-other, Other D

Use of well: (A) Anode, Drain, Seismic, Heat Res, Obs, Oil-gas, Recharge, Test, Unused, W Withdraw, Waste, Destroyed.

DATA AVAILABLE: Well data Freq. W/L meas.: original Field aquifer char.

Hyd. lab. data: _____

Qual. water data; type: Private Co analysis - 1-23-53 USGS K

Freq. sampling: Pumpage inventory: no, period: _____

Aperture cards: _____

Log data: driller's log D

WELL-DESCRIPTION CARD

SAME AS ON MASTER CARD Depth well: 461 ft Meas. 461 Meas. accuracy 3

Depth cased: 401 ft Casing type: _____; Diam. 16, 10 in 1.6

Finish: (C) porous concrete, (F) gravel w. (perf.), (G) gravel w. (screen), (H) horiz. gallery, end, (I) open end, (J) screen, (K) other G

Method Drilled: (A) air rot, (B) bored, (C) cable, (D) dug, (E) hyd rot, (F) jetted, (G) air percussion, (H) reverse, (I) rotary, (J) reverse trenching, (K) driven, (L) drive wash, (M) other H

Date Drilled: June 1951 951 Pump intake setting: _____ ft _____

Driller: Jayne Central Memphis Tenn.

Lift (type): (A) air, (B) bucket, (C) cent, (D) jet, (E) multiple, (F) multiple, (G) none, (H) piston, (I) rot, (J) submerg, (K) turb, (L) other T Deep Shallow

Power (type): diesel, elec, gas, gasoline, hand, gas, wind; H.P. 75 Trans. or meter no. V

Descrip. MP _____ ft above _____ ft below LSD, Alt. MP _____

Alt. LSD: _____ Accuracy: 3

Water Level: 83.4 ft above _____ ft below LSD 83 Accuracy: A

Date meas: 7-18-67 767 Yield: 1200 gpm 1200 Method determined 61

Drawdown: 29.10' ft 2.9 Accuracy: 6 Pumping period _____ hrs _____

QUALITY OF WATER DATA: Iron _____ Sulfate _____ Chloride _____ Hard. _____

Sp. Conduct 560 K x 10⁶ 4 Temp. 71 °F 71 Date sampled 168

Taste, color, etc. D.S. = 286 ppm (from well)

Well No.

D35

Latitude-longitude N
S
d m s d m s

HYDROGEOLOGIC CARD

NAME AS ON MASTER CARD: Physiographic Province: Coastal Plain Section: Miss. River

Drainage Basin: E Subbasin: 151

of depression, stream channel, dunes, flat, hilltop, sink, swamp, site: (V) offshore, pediment, hillside, terrace, undulating, valley flat

COCKFIELD aquifer, formation, group

Geology: Unconsolidated Sand Origin: Deltaic Aquifer Thickness: 123 ft

Length of well open to: 60 ft Depth to top of: 333 ft

Geology: sd alluvium Origin: Fluvial Aquifer Thickness: 56 ft

Length of well open to: 0 ft Depth to top of: 40 ft

Intervals: 401' - 461' 60' ss

Depth to consolidated rock: _____ ft Source of data: _____

Depth to cement: _____ ft Source of data: _____

Infiltration characteristics: _____

Coefficient of Storage: _____

Specific Capacity: _____ gpm/ft; Number of geologic cards: _____

into and clay and shale clay shale and w/shale streaks sand sand shale rock

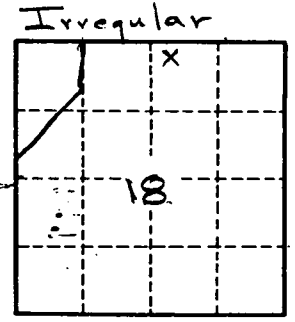
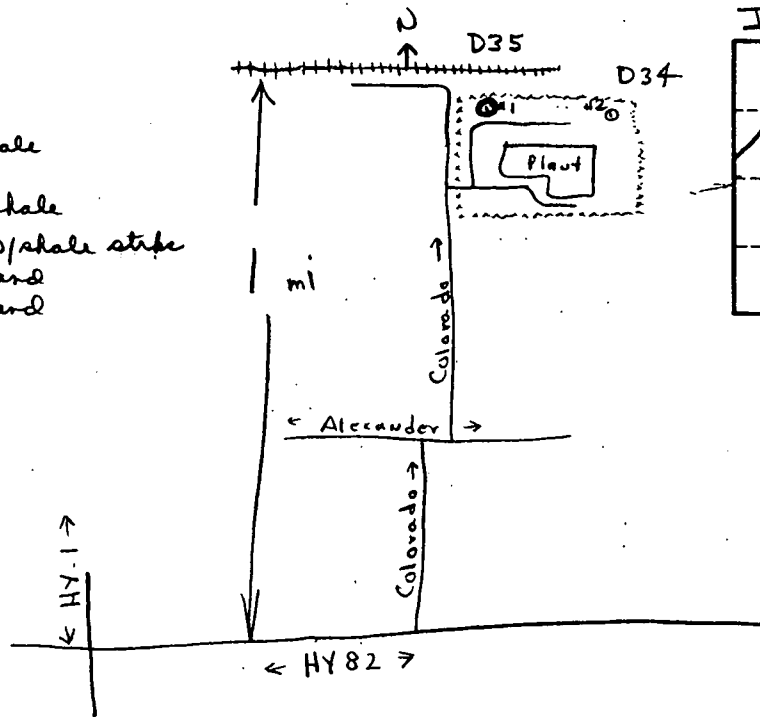

Well No. D35