

WELL SCHEDULE

U. S. DEPT. OF THE INTERIOR

GEOLOGICAL SURVEY

WATER RESOURCES DIVISION

MASTER CARD

Record by BE WASSON Source of data Plant Supt Hollaman Date 5-18-60 Map _____

State Mississippi 28 County (or town) Washington 76

Latitude: 33 24 38 N Longitude: 09 10 31 1 Sequential number: 1

Lat-long accuracy: 2 T. 18 S. R. 8 Sec 4, Irregular (NE, NW 17)

Local well number: 0029 1918 008W Other number: _____

Local use: 064 Owner or name: Southern Cotton Oil

Owner or name: SOUTHERN COTTON Address: Greenville, Miss.

Owship: County, Fed Gov't, City, Corp or Co, Private, State Agency, Water Dist _____

Use of water: (S) (T) (U) (V) (W) (X) (Y) (Z) (N) (P) (R)

Stock, Instit, Unused, Repressure, Recharge, Desal-P S, Desal-other, Other cooling

Use of well: (A) (D) (G) (H) (I) (J) (K) (L) (M) (N) (O) (P) (Q) (R) (S) (T) (U) (V) (W) (X) (Y) (Z) (W)

Anode, Drain, Seismic, Heat Res, Obs, Oil-gas, Recharge, Test, Unused, Withdraw, Waste, Destroyed.

DATA AVAILABLE: Well data Freq. W/L meas.: Irregular Field aquifer char.

Hyd. lab. data: _____

Qual. water data; type: Miss State U. 6-28-52 Partial; USGS

Freq. sampling: φ Pumpage inventory: no, period: _____

Aperture cards: _____

Log data: _____

WELL-DESCRIPTION CARD

SAME AS ON MASTER CARD Depth well: 500 ft Meas. 500 accuracy 6

Depth cased: _____ ft Casing Type: _____; Diam. 12 in 12

Finish: (C) (F) (G) (H) (I) (J) (K) (L) (M) (N) (O) (P) (Q) (R) (S) (T) (U) (V) (W) (X) (Y) (Z) (S)

porous concrete, gravel w. (perf.), (screen), gravel w. (screen), horiz. gallery, open end, perf., screen, sd. pt., shored, open hole, other

Method Drilled: (A) (B) (C) (D) (E) (F) (G) (H) (I) (J) (K) (L) (M) (N) (O) (P) (Q) (R) (S) (T) (U) (V) (W) (X) (Y) (Z) (H)

air bored, cable, dug, hyd rot, jetted, air percussion, rotary, reverse trenching, driven, wash, other

Date Drilled: 1952 9 5 2 Pump intake setting: _____ ft

Driller: Layne Central, Memphis, Tenn.

Lift (type): (A) (B) (C) (D) (E) (F) (G) (H) (I) (J) (K) (L) (M) (N) (O) (P) (Q) (R) (S) (T) (U) (V) (W) (X) (Y) (Z) (T) Deep Shallow

Power (type): diesel, (elec), gas, gasoline, hand, gas, wind; H.P. 75 Trans. or meter no. V

Descrip. MP _____ ft above _____ ft below LSD, Alt. MP _____

Alt. LSD: 125 Accuracy: 3

Water Level: 86.57 ft above _____ ft below MP; 87 ft above _____ ft below LSD Accuracy: meas.

Date meas: 5-18-60 560 Yield: 700 gpm 700 Method R_{pt} determined

Drawdown: _____ ft Accuracy: _____ Pumping period: _____ hrs

QUALITY OF WATER DATA: Iron _____ Sulfate _____ Chloride _____ Hard. _____

Sp. Conduct 650 K x 10⁶ 4 Temp. 70 °F Date sampled 168

Taste, color, etc. _____

Well No. D29

Latitude-longitude _____
d m s N S d m s

HYDROGEOLOGIC CARD

NAME AS ON MASTER CARD _____ Physiographic Province: Coastal Plain Section: Miss. River

Coastal Plain E Drainage Basin: 151 Subbasin: _____

(D) depression, stream channel, dunes, flat, hilltop, sink, swamp, site: (V) Y
offshore, pediment, hillside, terrace, undulating, valley flat

Age: Tertiary system, Eocene series, TE aquifer, formation, group, Cockfield C O

Geology: Unconsolidated Sand U S Origin: Deltaic 3 Aquifer Thickness: _____ ft
Length of well open to: _____ ft Depth to top of: _____ ft

Age: _____ system, _____ series, _____ aquifer, formation, group, _____
Geology: _____ Origin: _____ Aquifer Thickness: _____ ft
Length of well open to: _____ ft Depth to top of: _____ ft

Observations:
Depth to consolidated rock: _____ ft Source of data: _____
Depth to cement: _____ ft Source of data: _____
Infiltration characteristics: _____
Coefficient of storage: _____ gpd/ft² Coefficient Storage: _____
Coefficient of storage: _____ gpd/ft²; Spec cap: _____ gpm/ft; Number of geologic cards: _____

73' (9-55) from MP (rpt).

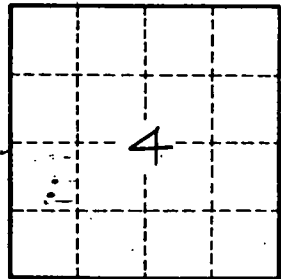
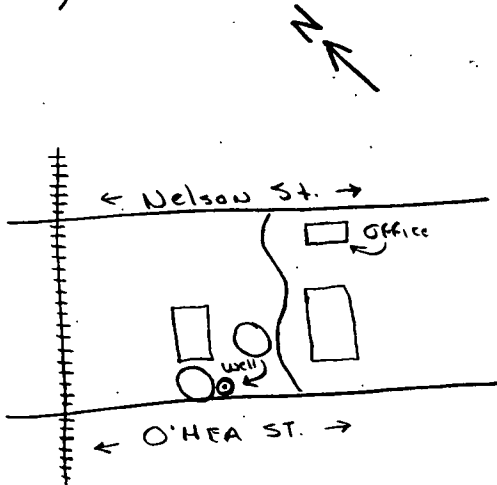

Runs 24 hr for 9 months (1960)

Elev. tank in bldg 10' D, 20' L

pump 24 hours a day
pgh 3 3/4" orifice at
base.

Well No. D29