

1/81 WTO

Recorded by MLP

Date 9-17-81

U.S. GEOLOGICAL SURVEY
WATER RESOURCES DIVISION
MISSISSIPPI DISTRICT
WELL RECORD

Well No. A-119

E-Log No. _____

County WASHINGTON

Site ID 3.3.3.1.08.09.1.0.75.7.0.1 R=0* T=A* 2=W*

Data reliab. 3=C* Report. agency 4=USGS* Dist. 6=28* 7=28* Co. 8=1.5.1*

Lat. _____ Long. 9=3.3.3.1.08* 10=09.1.0.75.7* Well No. 12=A.1.1.9*

Location 13=N.W.S.E.S 30 T 19 N R 09 W* Alt. 16=1.34.*

Hyd. Unit (OWDC) 20= Date 21=09.1.17.1.1981*

Well use 23=W* Water Use 24=I* Hole depth 27= Well depth 28=110.*

WL 30=1.6.* Date 31=09.1.17.1.1981* Source 33=S*

Status 273= Project No. 5=

R=158* T=A* Date 159#09.1.17.1.1981* Owner No. _____

Owner 161#UNK.N.O.W.N.

R=192* T=A* Date 193# Temp. 196#00010* 197=

R=192* T=A* Date 193# Cond. 196#00095* 197=

R=192* T=A* Date 193# pH 196#00400* 197=

R=58* T=A* 59# 1* Date 60=01.10.11.1976* Remarks _____

Drilg. 63= Name _____ Method 65=R* Finish 66=S*

R=76* T=A* 59#1*
Top. csgn. 77# Bot. csgn. 78= Diam. 79#1.6.0*

R=76* T=A* 59#1*
Top csgn. 77# Bot. csgn. 78= Diam. 79#

R=82* T=A* 59#1* Top 83# Bottom 84=

Type 85= Diam. 87= Size 88=

R=82* T=A* 59#1* Top 83# Bottom 84=

Type 85= Diam. 87= Size 88=

R= T=A* 147# 1* Q 150= Q/S 272=

134 flows 146 pumped

GEN. SITE DATA

OWNER

FIELD ON

CONSTR.

CASING

OPENINGS

YIELD

LIFT

R=42* T= A * Lift type 43# 7* Intake 44= * Power type 45= *

Date 38= 09/17/1981* H.P. 46= *

LOGS

R=198* T= A * Log 199# * Top 200= * Bot 201= *

R=198* T= A * Log 199# * Top 200= * Bot 201= *

R=189* T= A * E Log No. 190# * 191= M I S S D I S T *

ANAL.

R=114* T= A * Year 115# * 117= * 120= *

AQUIFERS

R=90* T= A * 256# 1 * Top 91= * Bot 92= *

Unit ID 93= * Name of Unit

R=90* T= A * 256# 1 * Top 91= * Bot 92= *

Unit ID 93= * Name of Unit

HYDRAULICS

R=98* T= A * 99# 1 * Unit tested 100= * 103= *

R=105* T= A * 99# 1 * Test No. 106# *

107= * Transmissivity (gal/d)/ft

108= * Hydraul. cond. (gal/d)/ft²

110= * Storage coeff. Boundaries

R=121* T= * Yr Begin 122# * Network 258# *

Water Level Data Collection (1) *MP is top of 2" pipe for air vent valve on disc pipe*
MP = 4.5

30
 - 9.18
 - 20.82
 - 34.50
 1673-24
 9/17/81 MLP

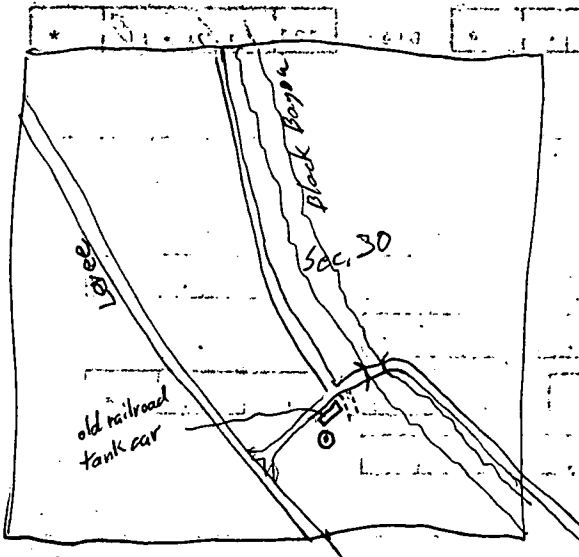

well hasn't been used in several years.

