

WRD Exp. (GW)
April 1966

Well No. A4

WELL SCHEDULE

U. S. DEPT. OF THE INTERIOR

GEOLOGICAL SURVEY

WATER RESOURCES DIVISION
ROLLA COMPUTATION BRANCH

MASTER CARD

Record by EJ Harvey Source of data Layne Central Date 1955 Map County - Lament Quad.

State Miss County (or town) Washington 76

Latitude: 33 30 50 N Longitude: 09 10 44 W Sequential number: 1

Lat-long accuracy: 3 T. 19 S. R. 9 Sec 26, NE $\frac{1}{4}$, NE $\frac{1}{4}$

Local well number: A004A A2619 N09W Other number: B & M

Local use: _____ Owner or name: Delta & Pine Land

Owner or name: DELTA-PINE LAND Tenant Carson Plantation Address: Scott, Miss

Ownership: County, Fed Gov't, City, Corp or Co, Private, State Agency, Water Dist N

Use of water: (A) Air cond, (B) Bottling, (C) Comm, (D) Dewater, (E) Power, (F) Fire, (G) Dom, (H) I Med, (I) Ind, (J) P S, (K) Rec, (L) Stock, (M) Instit, (N) Unused, (O) Repressure, (P) Recharge, (Q) Desal-P S, (R) Desal-other, (S) Other I

Use of well: (A) Anode, (B) Drain, (C) Seismic, (D) Heat Res, (E) Obs, (F) Oil-gas, (G) Recharge, (H) Test, (I) Unused, (J) Withdraw, (K) Waste, (L) Destroyed W

DATA AVAILABLE: Well data 0 Freq. W/L meas.: original 0 Field aquifer char. 0

Hyd. lab. data: _____

Qual. water data; type: _____

Freq. sampling: none Pumpage inventory: no period: _____

Aperture cards: _____

Log data: _____

WELL-DESCRIPTION CARD

SAME AS ON MASTER CARD Depth well: 112 ft Meas. accuracy: 2

Depth cased; (first perf.): 62 ft Casing type: _____; Diam. 16-12 in

Finish: (C) porous concrete, (F) gravel w. (G) gravel w. (H) horiz. (I) open (J) perf., (K) screen, (L) sd.-pt., (M) ghored, (N) open hole, (O) other S

Method Drilled: (A) air rot, (B) bored, (C) cable, (D) dug, (E) hyd rot., (F) jetted, (G) air percussion, (H) rotary, (I) reverse, (J) trenching, (K) driven, (L) drive wash, (M) other R

Date Drilled: Aug 1954 954 Pump intake setting: _____ ft

Driller: Layne Central

Lift (type): (A) air, (B) bucket, (C) cent, (D) jet, (E) multiple, (F) multiple, (G) none, (H) piston, (I) rot, (J) submerg, (K) curb, (L) other T Deep 0 Shallow 40

Power (type): diesel, elec, gas, gasoline, hand, gas, wind; H.P. 30 Trans. or meter no. V

Descrip. MP Top of casing, which is 1 ft above LSD Alt. MP _____

Alt. LSD: 132 Accuracy: (source) 3

Water Level: 22.25 ft above below MP. Ft below LSD 21 Accuracy: Reported

Date meas: 8-24-54 854 Yield: 1965 gpm 1965 Method determined ?

Drawdown: _____ ft Accuracy: _____ Pumping period: _____ hrs

QUALITY OF WATER DATA: Iron _____ ppm Sulfate _____ ppm Chloride _____ ppm Hard. _____ ppm

Sp. Conduct _____ K x 10⁶ Temp. _____ °F Date sampled _____

Taste, color, etc. _____

Well No. A4

Well No. **A4**

Latitude-longitude N
S
d m s d m s

HYDROGEOLOGIC CARD

SAME AS ON MASTER CARD Physiographic Province: **Coastal Plain** **03** Section: **Miss. River**

alluvial plain **E** Drainage Basin: **15I** Subbasin: 26

Topo of well site: (D) depression, stream channel, dunes, flat, hilltop, sink, swamp, (E) (F) (H) (K) (L) (V) **(V)** offshore, pediment, hillside, terrace, undulating, valley flat 27

MAJOR AQUIFER: **Quaternary** **Pleistocene** **Q6** **Miss. River alluvium** **M1A**
system series aquifer, formation, group

Lithology: **sand-gravel alluvium** **9A** Origin: **Fluvial** **2** Aquifer Thickness: ft
Length of well open to: **50** ft **50** Depth to top of: ft

MINOR AQUIFER: 46 47

Lithology: 48 49 Origin: 50 Aquifer Thickness: ft
Length of well open to: ft Depth to top of: ft

Intervals Screened: **62-112'** **50 ft screen**

Depth to consolidated rock: 64 Source of data: 64

Depth to basement: 65 68 Source of data: 69

Surficial material: 70 71 Infiltration characteristics: 72

Coefficient Trans: gpd/ft Coefficient Storage: 76 78

Coefficient Perm: gpd/ft²; Spec cap: gpm/ft; Number of geologic cards: 79

7.2 miles N. of Greenville **See Paul Banks.**
Clay to 38 ft
Bottom in coarse sand and gravel

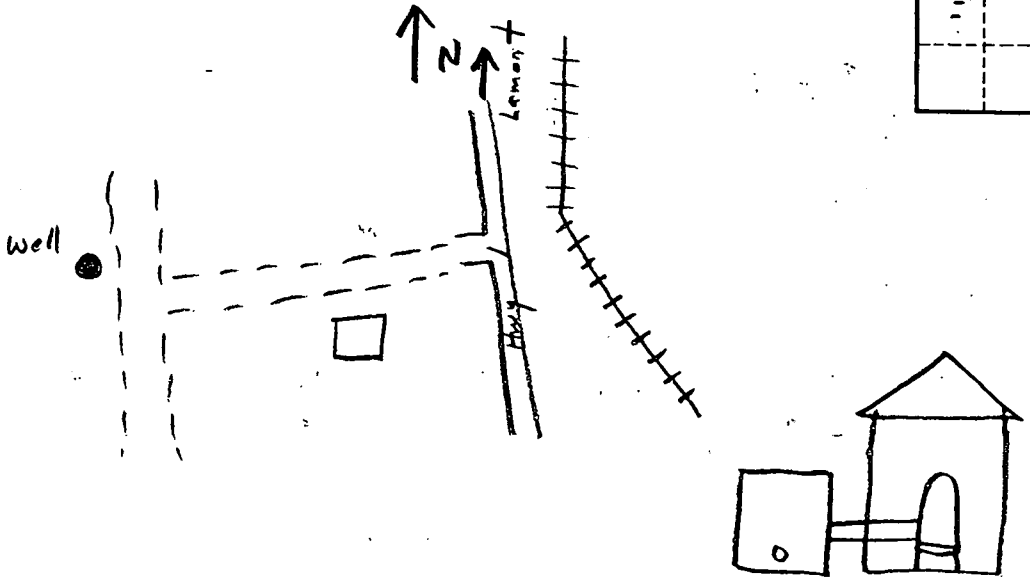
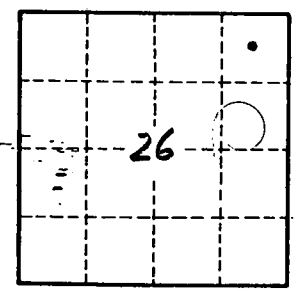

Well No. **A4**