

JUN 20 1975
RECORDED

WELL SCHEDULE

U. S. DEPT. OF THE INTERIOR GEOLOGICAL SURVEY WATER RESOURCES DIVISION

MASTER CARD

Record by J.A. Callahan Source of data owner Date 6-9-68 Map _____

State Miss 28 County (or town) Walshall 74

Latitude: 311029 N Longitude: 0900230 Sequential number: 1

Lat-long accuracy: 20 T, 2 S, 11 W, Sec 1, NE, NE

Local well number: F008440102N11E Other number: _____ B & M

Local use: _____ Owner or name: Leagia Hammonds

Owner or name: L. HAMMONDS Address: _____

Ownership: County, Fed Gov't, City, Corp or Co, Private, State Agency, Water Dist _____

Use of water: (A) Air cond, (B) Bottling, (C) Comm, (D) Dewater, (E) Power, (F) Fire, (G) Dom, (H) Irr, (I) Med, (J) P S, (K) Rec, (L) Stock, (M) Instit, (N) Unused, (O) Repressure, (P) Recharge, (Q) Desal-P/S, (R) Desal-other, (S) Other _____

Use of well: (A) Anode, (B) Drain, (C) Seismic, (D) Heat Res, (E) Obs, (F) Oil-gas, (G) Recharge, (H) Test, (I) Unused, (J) Withdraw, (K) Waste, (L) Destroyed. _____

DATA AVAILABLE: Well data Freq. W/L meas.: Field aquifer char.

Hyd. lab. data: _____

Qual. water data; type: _____

Freq. sampling: _____ Pumpage inventory: yes, no, period: _____

Aperture cards: _____ yes

Log data: _____

WELL-DESCRIPTION CARD

SAME AS ON MASTER CARD Depth well: _____ ft Meas. rept _____ accuracy _____

Depth cased: (first perf.) _____ ft Casing type: _____; Diam. 2 in

Finish: (A) porous concrete, (B) gravel w. (perf.), (C) gravel w. (screen), (D) horiz. gallery, (E) open end, (F) perf., (G) screen, (H) sd. pt., (I) shored, (J) open hole, (K) other _____

Method: (A) air bored, (B) cable, (C) dug, (D) hyd jetted, (E) air rot, (F) percussion, (G) rotary, (H) reverse, (I) trenching, (J) driven, (K) drive wash, (L) other _____

Date Drilled: 3-59 959 Pump intake setting: _____ ft

Driller: _____ name _____ address _____

Lift (type): (A) air, (B) bucket, (C) cent., (D) jet, (E) multiple, (F) multiple, (G) none, (H) piston, (I) rot, (J) submerg, (K) turb, (L) other _____ Deep Shallow

Power (type): (A) diesel, (B) elec, (C) gas, (D) gasoline, (E) hand, (F) gas, (G) wind, (H) H.P., (I) Trans. or meter no. _____

Descrip. MP _____ ft above LSD, Alt. MP _____

Alt. LSD: _____ Accuracy: (source) _____

Water Level: _____ ft above MP; _____ ft below LSD Accuracy: _____

Date meas: _____ Yield: _____ gpm Method determined _____

Drawdown: _____ ft Accuracy: _____ Pumping period _____ hrs

QUALITY OF WATER DATA: Iron _____ ppm Sulfate _____ ppm Chloride _____ ppm Hard. _____ ppm

Sp. Conduct _____ K x 10 6 Temp. _____ °F Date sampled _____

Taste, color, etc. _____

Well No.

100

Well No. _____

F8

Latitude-longitude _____

N

S

HYDROGEOLOGIC CARD

SAME AS ON MASTER CARD Physiographic Province: _____ Section: _____

Drainage Basin: _____ Subbasin: _____

Topo of well site: (D) depression, stream channel, dunes, flat, hilltop, sink, swamp, (E) offshore, pediment, hillside, terrace, undulating, valley flat, (F) (G) (H) (I) (J) (K) (L) (M) (N) (O) (P) (Q) (R) (S) (T) (U) (V) (W) (X) (Y) (Z) _____

MAJOR AQUIFER: system _____ series _____ aquifer, formation, group _____

Lithology: _____ Origin: _____ Aquifer Thickness: _____ ft

Length of well open to: _____ ft Depth to top of: _____ ft

MINOR AQUIFER: system _____ series _____ aquifer, formation, group _____

Lithology: _____ Origin: _____ Aquifer Thickness: _____ ft

Length of well open to: _____ ft Depth to top of: _____ ft

Intervals Screened: _____

Depth to consolidated rock: _____ ft Source of data: _____

Depth to basement: _____ ft Source of data: _____

Surficial material: _____ Infiltration characteristics: _____

Coefficient Trans: _____ gpd/ft Coefficient Storage: _____

Coefficient Perm: _____ gpd/ft² Spec cap: _____ gpm/ft; Number of geologic cards: _____

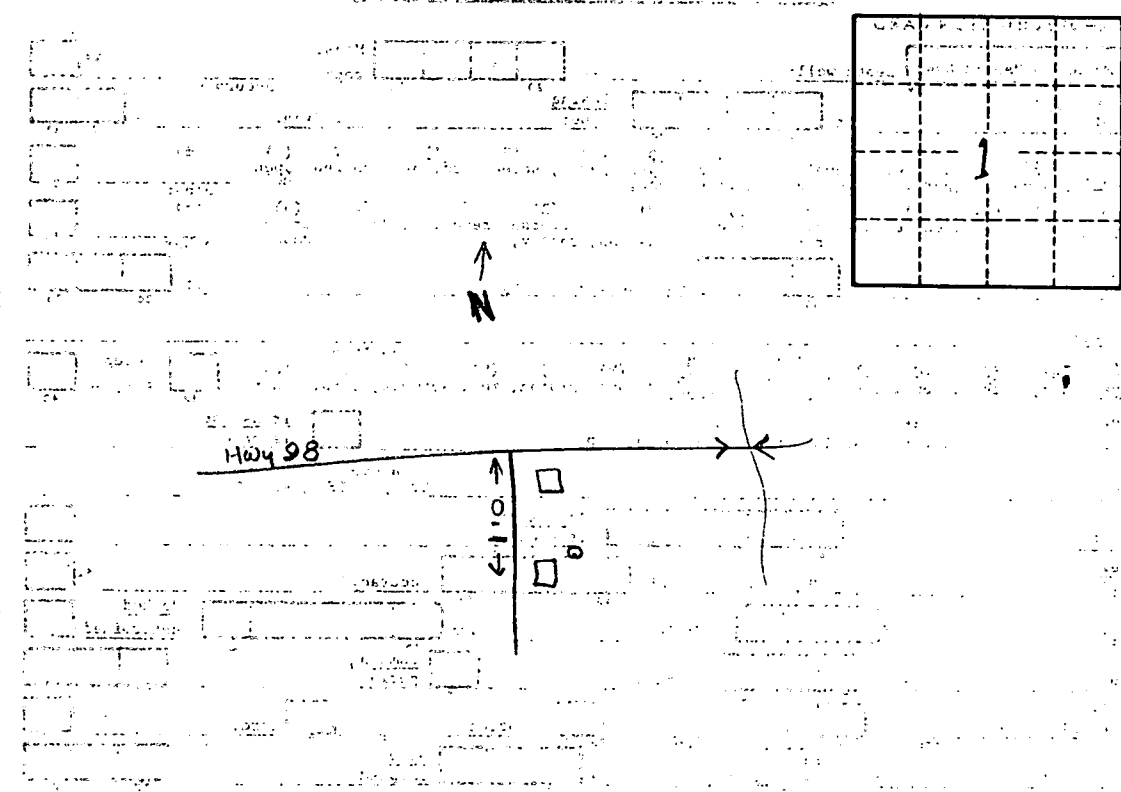

Well No. _____

F8