

8" well

FORM 9-1642 (1-68)

Well No. J12

PUNCHED AUG 6 1973

U. S. DEPT. OF THE INTERIOR

WELL SCHEDULE GEOLOGICAL SURVEY

WATER RESOURCES DIVISION

MASTER CARD

Record by BEE Source of data Driller Date 2/20/62 Map

State 28 County (or town) UNION 73

Latitude: 34² 26³ 33^N Longitude: 08⁸ 50² 27⁷ Sequential number: 2

Lat-long accuracy: 3⁷⁰ 7^N 4^R 4^W Sec 25 SE t. NW t. SW t.

Local well number: J0128C2507504E Other number: B & H

Local use: 064 Owner or name: UNION COUNTY

Owner or name: EAST UNION SCH Address:

Well add.

Ownership: County, Fed Gov't, City, Corp or Co, Private, State Agency, Water Dist C

Use of water: (A) Air cond, Bottling, Comm, Dewater, Power, Fire, Dom, Irr, Med, Ind, P S, Rec, (S) Stock, Instit, Unused, Recharge, (T) Recharge, Desal-P S, Desal-other, Other ?

Use of well: (A) Anode, (D) Drain, (G) Seismic, (H) Heat Res, (O) Obs, (P) Oil-gas, (R) Recharge, (T) Test, (U) Unused, (W) Withdraw, (X) Waste, (Z) Destroyed ?

DATA AVAILABLE: Well data ? Freq. W/L meas.: N Field aquifer char. ?

Hyd. lab. data: ?

Qual. water data; type: ?

Freq. sampling: ? Pumpage inventory: ? period: ?

Aperture cards: ?

Log data: ?

WELL-DESCRIPTION CARD

SAME AS ON MASTER CARD Depth well: 363 ft 357 Meas. 3

Depth cased: 342 ft Casing type: ? accuracy: ? Diam. 8x4 in ?

Finish: porous concrete, gravel w. (H) gravel w. (O) horiz. open (P) screen, sd. pt., shored, open (S) gallery, end, (T) perf., (W) other (Z) other

Method Drilled: (A) air rot., (B) bored, (C) cable, (D) dug, (H) jetted, (I) air percussion, (P) reverse, (R) reverse, (T) trenching, (V) driven, (W) drive wash, (Z) other

Date Drilled: 9-6-61 Pump intake setting: ? ft ?

Driller: Jayne Central name address

Lift (type): (A) air, (B) bucket, (C) cent, (J) jet, (L) multiple, (M) multiple, (N) none, (P) piston, (R) rot, (S) submerg, (T) turb, (Z) other ? Deep ? Shallow ?

Power (type): diesel, elec, gas, gasoline, hand, gas, wind; H.P. ? Trans. or meter no. ?

Descrip. MP ? ft above ? ft below LSD, Alt. MP ?

Alt. LSD: 365 Accuracy: (source) 5

Water Level: ? ft above ? ft below MP; ? ft below LSD Accuracy: ?

Date meas: ? Yield: ? gpm Method determined ?

Drawdown: ? ft Accuracy: ? Pumping period: ? hrs

QUALITY OF WATER DATA: Iron ppm ? Sulfate ppm ? Chloride ppm ? Hard. ppm ?

Sp. Conduct ? K x 10 ? Temp. ? Date sampled ?

Well No.

Well No. _____

Latitude-longitude _____
d m s N S

HYDROGEOLOGIC CARD

FINISHED
1962

SAME AS ON MASTER CARD

Physiographic Province: _____

03
20 21

Section: _____

D
22

Drainage Basin: _____

13C
23 25

Subbasin: _____

24

Topo of well site: (D) depression, (C) stream channel, (E) dunes, (F) flat, (H) hilltop, (K) sink, (L) offshore, (P) pediment, (S) hillside, (T) terrace, (U) undulating, (V) valley flat
27

MAJOR AQUIFER: system _____ series **K3** aquifer, formation, group **C3**
28 29 30 31

Lithology: _____ Origin: **6** Aquifer Thickness: _____ ft
32 33 34

Length of well open to: _____ ft Depth to top of: _____ ft
35 37 38 40 41 43

MINOR AQUIFER: system _____ series _____ aquifer, formation, group _____
44 45 46 47

Lithology: _____ Origin: _____ Aquifer Thickness: _____ ft
48 49 50

Length of well open to: _____ ft Depth to top of: _____ ft
51 53 54 56 57 59

Intervals Screened: _____

Depth to consolidated rock: _____ ft Source of data: _____
60 63 64

Depth to basement: _____ ft Source of data: _____
65 68 69

Surficial material: _____ Infiltration characteristics: _____
70 71 72

Coefficient Trans: _____ gpd/ft² Coefficient Storage: _____
73 75 76 78

Coefficient Perm: _____ gpd/ft²; Spec cap: _____ gpm/ft; Number of geologic cards: _____
79

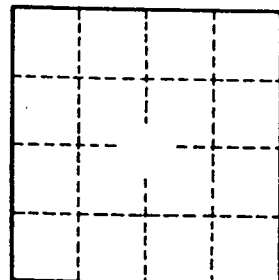
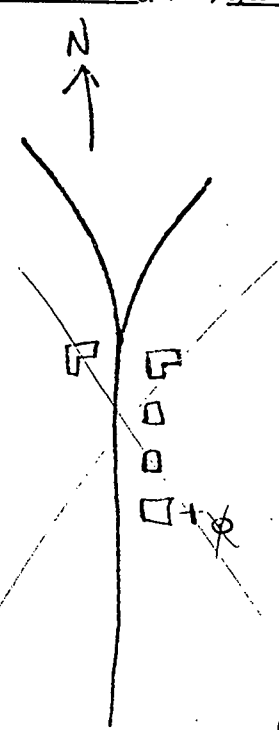

Well behind school (Submersible)

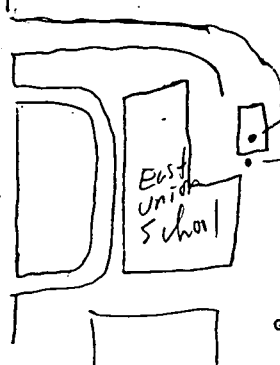

old well abd (JTZ) horses' water tank ball field unable to get in (plugged)