

6/78 WTO

GPSd 8/6/97 LM

Recorded by WTO

U.S. GEOLOGICAL SURVEY
WATER RESOURCES DIVISION
MISSISSIPPI DISTRICT
WELL RECORD

Well No. H62

Date 6/29/74 5/80

Log No. 31

County Union

TRANSMITTED FOR ADP

Site ID 342956089011701 R=0* T=A* 2=W* Myrtle Quad

GEN. SITE DATA

Data reliab. 3=C* Report. agency 4=USGS* Dist. 6=28* 7=28* Co. 8=145*

Lat. Long. 9=342956* 10=0890117* Well No. 12=H062*

Location 13=N E S 06 T 07 S R 03 E* Alt. 16=410*

Hyd. Unit (OWDC) 20= Date 21=06/24/1974*

Well use 23=W* Water Use 24=P* Hole depth 27=1109* Well depth 28=1095*

WL 30=187* Date 31=01/15/1975* Source 33=D*

Status 273= Project No. 5=

OWNER

R=158* T=A* Date 159#01/15/1975* Owner No.

Owner 161=NEW ALBANY

FIELD OW

R=192* T=A* Date 193# Temp. 196#00010* 197=

R=192* T=A* Date 193# Cond. 196#00095* 197=

R=192* T=A* Date 193# pH 196#00400* 197=

CONSTR.

R=58* T=A* 59#1* Date 60=01/15/1975* Remarks

Drlg. 63=330* Name Herndon Method 65=H* Finish 66=E*

CASING

R=76* T=A* 59#1*

Top csgn. 77#0* Bot. csgn. 78=1000* Diam. 79#8*

R=76* T=A* 59#1*

Top csgn. 77# Bot. csgn. 78= Diam. 79#

OPENINGS

R=82* T=A* 59#1* Top 83#1015* Bottom 84=1095*

Type 85=S* Diam. 87=4* Size 88=

R=82* T=A* 59#1* Top 83# Bottom 84=

Type 85= Diam. 87= Size 88=

YIELD

R=146* T=A* 147#1* Q 150=225* Q/S 272=

134 flows 146 pumped

R=42* T= A * Lift type 43# T* Intake 44= * Power type 45= E*

LIFT Date 38= 01/15/1975* H.P. 46= 40.*

R=198* T= A * Log 199# D* Top 200= 0.* Bot 201= 1109.*

R=198* T= A * Log 199# E* Top 200= 5.* Bot 201= 1109.*

R=189* T= A * E Log No. 190# 031* 191= M I S S D I S T *

ANAL. R=114* T= A * Year 115# * Type 120= *

R=90* T= A * 256# 1 * Top 91= 1000.* Bot 92= 1090.*

Unit ID 93= ZILLEUTW * Name of Unit

R=90* T= A * 256# 1 * Top 91= * Bot 92= *

Unit ID 93= * Name of Unit

R=98* T= A * 99# 1 * Unit tested 100= * 103= *

R=105* T= A * 99# 1 * Test No. 106# *

107= * Transmissivity (gal/d)/ft

108= * Hydraul. cond. (gal/d)/ft²

110= * Storage coeff. Boundaries

R=121* T= * Yr Begin 122# * Network 258= *

Water Level Data Collection (1)

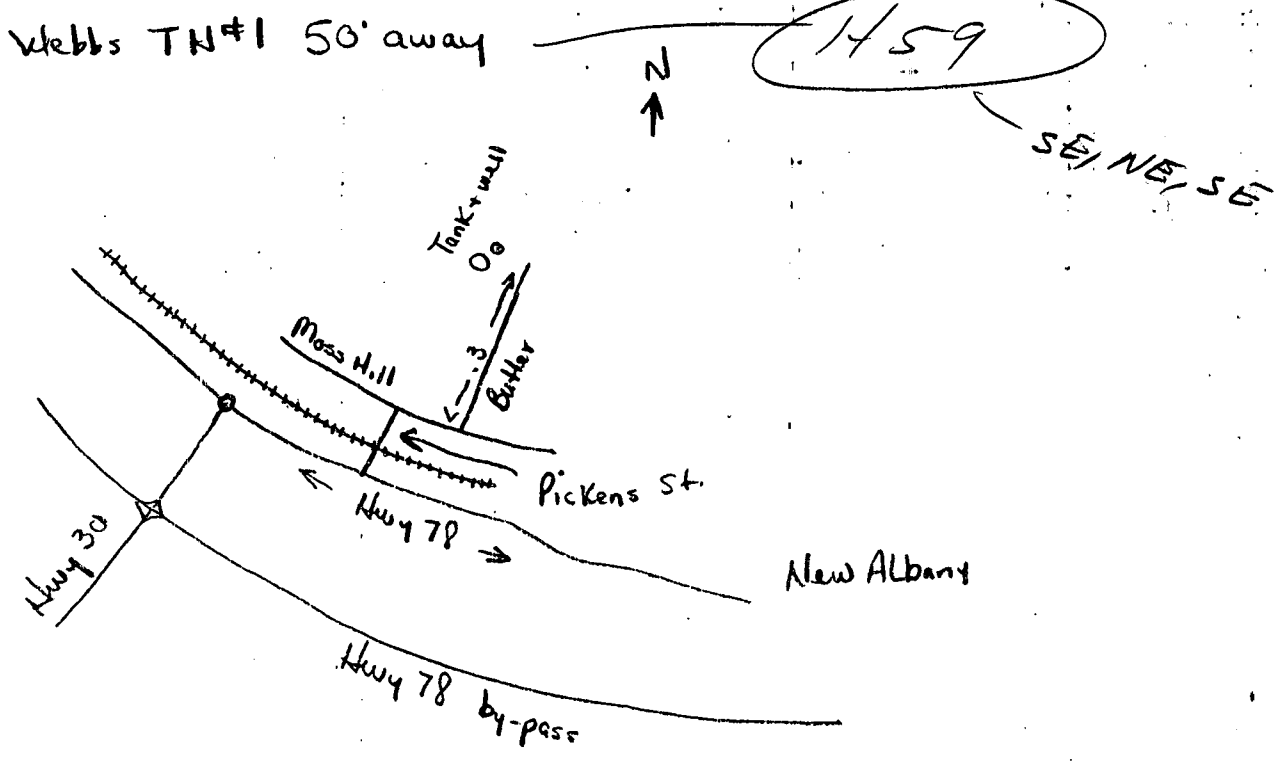

DEPARTMENT OF ENVIRONMENTAL QUALITY - OLWR
PUBLIC SUPPLY WELLS PROJECT

GPS LOG

USER NAME(S): Lisa May DATE: 8-6-97

UNIT DEQ #: 84759 FILE #: A080621D

HEALTH DEPT. #: 730006-03 ELEV. 405

USGS #: H62 OLWR #: G.W00557

OWNER: New Albany QUAD: Murple

LOCATION: NW/SE/NE/SE S 6 T 7 S R 3 E COUNTY: Union

LOCATION DESCRIPTION: Lake Moss Hill N off Hwy 178 W and Lake
R on Boulder - Well under Elbow Fork

CASING DIA: _____ PUMP TYPE & SIZE: _____

GPS FIELD LOCATION: LAT. 34-30-04.6 LONG. 89-01-06.4

GPS CORRECTED LOCATION: LAT. 34.501285 LONG. 89.01847680

REMARKS: 50' SE of well

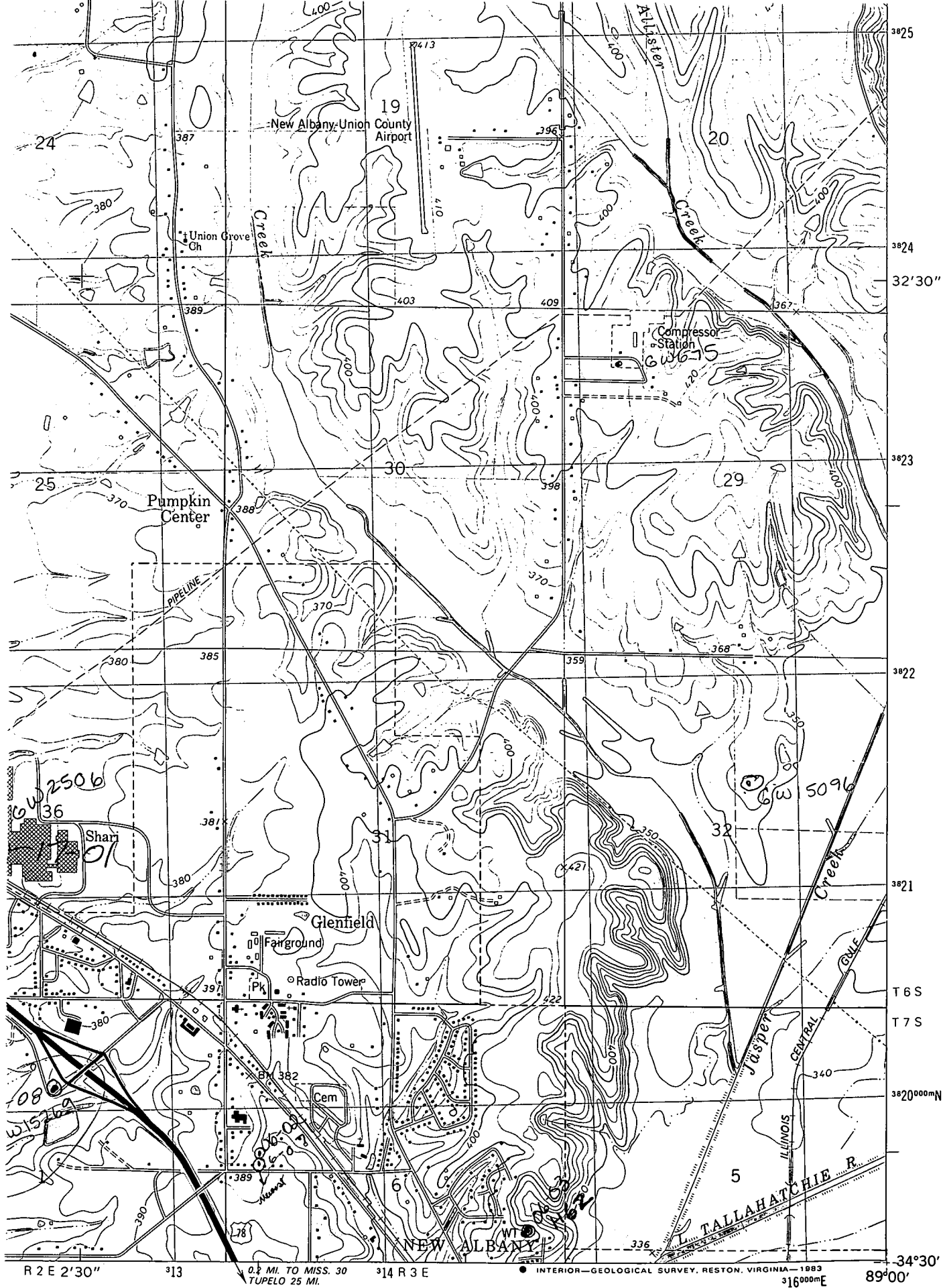

1 MILE

ROAD CLASSIFICATION

Primary highway, hard surface	Light-duty road, hard or improved surface
Secondary highway, hard surface	Unimproved road

0.2 MI. TO MISS. 30 TUPELO 25 MI.

INTERIOR—GEOLOGICAL SURVEY, RESTON, VIRGINIA—1983

1:160000M

NEW ALBANY EAST 3252' N NW