

New owner } 11/92
Billy Miller

New Albany E.

FORM 9-1642
(1-68)

Well No. H53

PUNCHED

WELL SCHEDULE

U. S. DEPT. OF THE INTERIOR

GEOLOGICAL SURVEY

WATER RESOURCES DIVISION

DEC 8 1972

MASTER CARD

1988
WL = 160.2
1992 = 165.70

Record by JCM Source of data BOWC Date 6-72 Map New Albany E

State 28 County (or town) Union 73

Latitude: 34 28 22 N Longitude: 088 56 08 Sequential number: 1

Lat-long accuracy: 5 T 70 S R 30 W, Sec 13, SE 1/4, NW 1/4, SE 1/4

Local well number: H053 1307313 Other number: B & M

Local use: 027 Owner or name: HAYS HOWELL

Owner or name: HAYS HOWELL Address: Santer

Ownership: County, Fed Gov't, (M) City, Corp or Co, Private, State Agency, Water Dist P

Use of water: Air cond, Bottling, Comm, Dewater, Power, Fire, Dom, Irr, Med, Ind, P S, Rec, (S) (T) (U) (V) (W) (X) (Y) (Z) H

Use of well: Anode, Drain, Seismic, Heat Res, Obs, Oil-gas, Recharge, Test, Unused, Withdraw, Waste, Destroyed. (A) (D) (G) (H) (I) (J) (K) (L) (M) (N) (O) (P) (Q) (R) (S) (T) (U) (V) (W) (X) (Y) (Z) W

DATA AVAILABLE: Well data Freq. W/L meas.: Field aquifer char.

Hyd. lab. data:

Qual. water data; type:

Freq. sampling: Pumpage inventory: yes no: period:

Aperture cards: yes

Log data:

WELL-DESCRIPTION CARD

SAME AS ON MASTER CARD Depth well: 605 Meas. 3

Depth cased: 267 Casing type: Steel Diam. 4

Finish: porous concrete, gravel w. (perforated), gravel w. (screen), horiz. gallery, open perf., screen, sd. pt., shored, open hole, other P

Method: air bored, cable, dug, hyd jetted, air reverse trenching, driven, drive rot., percussion, rotary, other H

Date Drilled: 9-7-72 Pump intake setting: ft

Driller: J.W. White

Lift (type): air, bucket, cent, jet, multiple, multiple, none, piston, rot, submerg, turb, other S Deep Shallow

Power (type): diesel, elec, gas, gasoline, hand, gas, wind; H.P. 3/4 Trans. or meter no. 5

Descrip. MP 440 6/93 (1988) ft above below LSD, Alt. MP ft

Alt. LSD: 453 Accuracy: (source) Topo

Water Level: 211 Accuracy: D

Date meas: 5-7-72 Yield: 8 Method determined 61

Drawdown: ft Accuracy: ft Pumping period: hrs

QUALITY OF WATER DATA: Iron ppm Sulfate ppm Chloride ppm Hard. ppm

Sp. Conduct K x 10⁶ Temp. °F Date sampled 77

Taste, color, etc.

11/92
200.00
33.36
166.70
-1.00
165.70

Well No. H53

Well No. _____

PUNCHED

Latitude-longitude _____
d m s N S d m s

HYDROGEOLOGIC CARD

SAME AS ON MASTER CARD

Physiographic Province: _____

03

Section: _____

Sta 8 232

Drainage Basin: _____

15F

Subbasin: _____

26

Topo of well site: (D) depression, stream channel, dunes, flat, hilltop, sink, swamp, (E) (F) (H) (K) (L) (P) (S) (T) (U) (V) offshore, pediment, hillside, terrace, undulating, valley flat _____ 27

MAJOR AQUIFER: _____ system _____ series **K3** _____ aquifer, formation, group **CS**

Lithology: _____ Origin: **6** Aquifer Thickness: **103** ft
Length of well open to: _____ ft **300** Depth to top of: _____ ft **502**

MINOR AQUIFER: _____ system _____ series _____ aquifer, formation, group _____
Lithology: _____ Origin: _____ Aquifer Thickness: _____ ft

Length of well open to: _____ ft _____ Depth to top of: _____ ft _____

Intervals Screened: **300' of perf. pipe in bottom of well**

Depth to consolidated rock: _____ ft _____ Source of data: _____

Depth to basement: _____ ft _____ Source of data: _____

Surficial material: _____ Infiltration characteristics: _____

Coefficient Trans: _____ gpd/ft _____ Coefficient Storage: _____

Coefficient Perm: _____ gpd/ft²; Spec cap: _____ gpm/ft; Number of geologic cards: _____

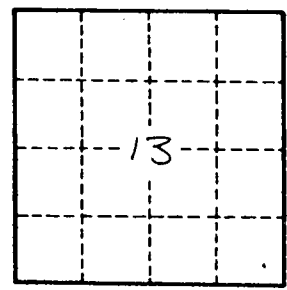
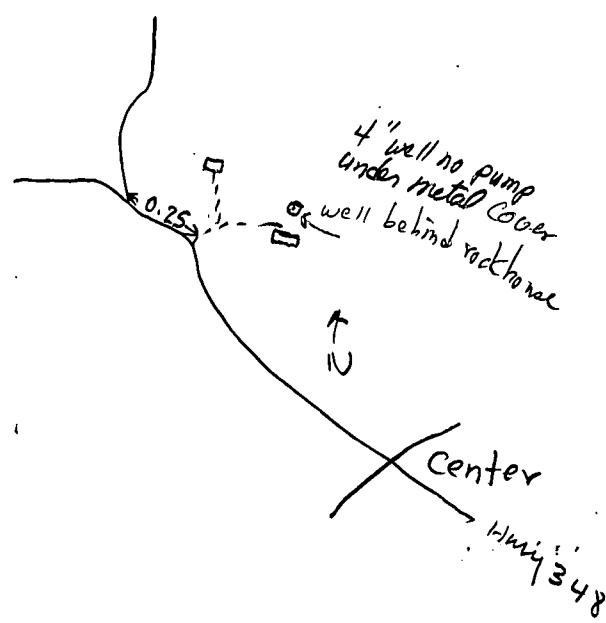

Well No. **H53**

770.00
3.30
16670
1.00
165.70