

9-185-July 1935
Revised

UNITED STATES
DEPARTMENT OF THE INTERIOR
GEOLOGICAL SURVEY
WATER RESOURCES BRANCH

WELL SCHEDULE

Date July 25, 1940 Field No. 1
Record by U. M. Foster Office No. H-8
Source of data Mr. W. F. Baker, Engineer

1. Location: State Miss County Union
Map at water works

NW $\frac{1}{4}$ NE $\frac{1}{4}$ sec. 8 T. 7 N. R. 3 E

2. Owner: City of New Albany Address New Albany Miss
Tenant _____ Address _____

Driller Layne Central Address Memphis Tenn

3. Topography Hill

4. Elevation 300 ft. above _____
below _____

5. Type: Dug drilled driven, bored, jetted _____ 1938

6. Depth: Rept. 1020 1034 ft. Meas. _____ ft.

7. Casing: Diam. 1.5 in., to 2 in., Type _____
Depth 1020 ft., Finish Cravel Wall

8. Chief Aquifer Eutaw From 925 ft. to 1024 ft.
Others _____

9. Water level _____ ft. rept. _____ above
meas. _____ below

10. Pump: Type Layne deepwell turbine Capacity 425 G. M.
Power: Kind Electric Horsepower 30

11. Yield: Flow _____ G. M., Pump 425 G. M., Meas. Rept. Est. _____

Drawdown 7 ft. after 4 1/2 hours pumping 210 G. M.

12. Use: Dom., Stock, PS, RR., Ind., Irr., Obs. _____
Adequacy, permanence _____

13. Quality _____ Temp _____ °F.
Taste, odor, color _____ Sample Yes 1954
Unfit for _____

14. Remarks: (Log, Analyses, etc.) Town uses about 400,000 g.p.d. No.

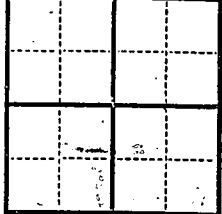

100

1. Name of (or) locality of site

2. State or other locality

3. Section

4. Township

5. Range

6. County

7. State

8. Date of collection

9. Name of collector

10. Name of institution

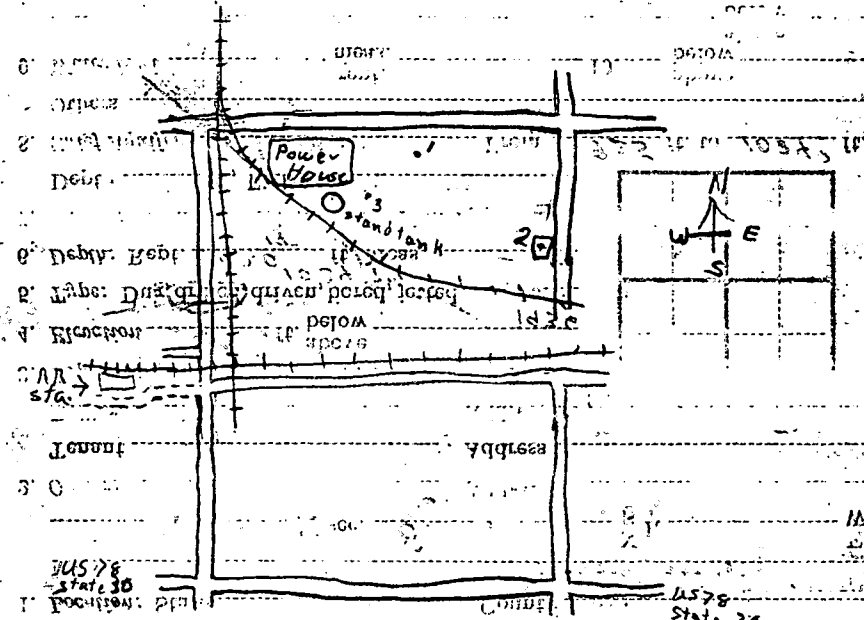

Source of data

Records of

Field notes

Other

WELL SCHEDULE

WATER RESOURCES BRANCH

GEOLOGICAL SURVEY

DEPARTMENT OF THE INTERIOR

PAID BY THE UNITED STATES

de / 2E / 3E

NEW ALBANY WEST QUADRANGLE

MISSISSIPPI

7.5 MINUTE SERIES (TOPOGRAPHIC)

NE/4 NEW ALBANY 15' QUADRANGLE

3253 III SW (KEOWNVILLE)

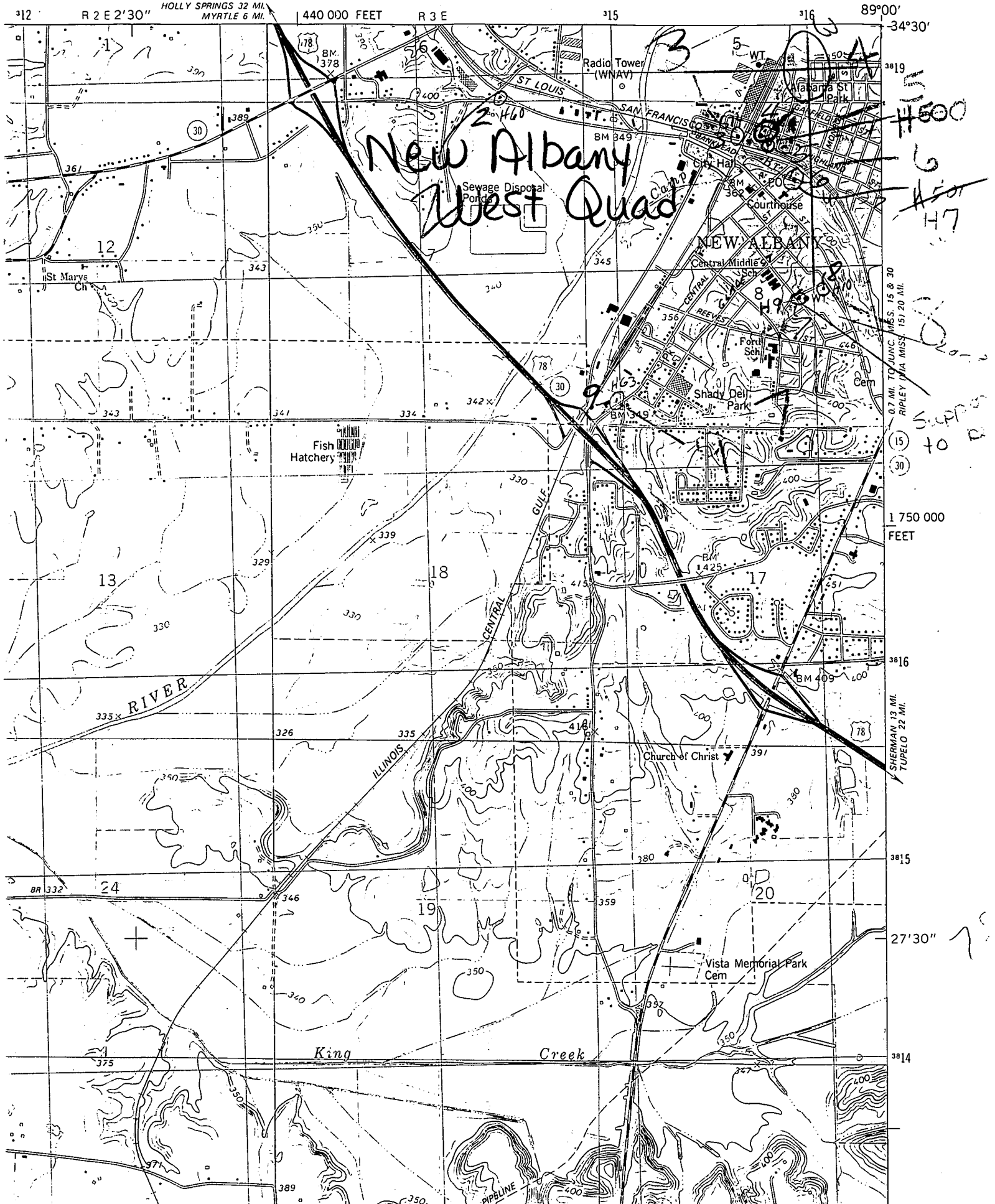

H500
 6
 H501
 H7
 8
 15
 30
 1750000
 FEET
 3816
 3815
 27'30"

0.7 MI TO JUNC. MISS. 15 & 30
 RIPLEY VIA MISS. 151 20 MI.

SHERMAN 13 MI
 TUPELO 22 MI.

PIPELINE