

9-185
(October 1950)

UNITED STATES
DEPARTMENT OF THE INTERIOR
GEOLOGICAL SURVEY
WATER RESOURCES DIVISION

Log
Well #2

WELL SCHEDULE

Date May 18, 1959 Field No. _____
Record by B. E. ELLISON Office No. E-9
Source of data B. B. ROBINSON, Plant Foreman C1

1. Location: State MS County Union
Map _____

NW $\frac{1}{4}$ NW $\frac{1}{4}$ sec. 29 T 6 N R 3
2. Owner: TENN. GAS PIPE Address NEW ALBANY
Tenant LINE CO. Address _____
Driller LOVNE CENTRAL Address MEMPHIS

3. Topography PRairie
4. Elevation 905 ft. above below TOPO

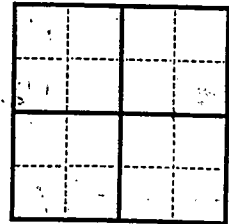

5. Type: Dug drilled driven, bored, jetted _____ 1956
6. Depth: Rept. 781 ft. Meas. _____ ft.

7. Casing: Diam. 12 in., to _____ in., Type _____
Depth 200-50 ft., Finish 822-862

8. Chief Aquifer KC From _____ ft. to _____ ft.
Others _____

9. Water level -90 ft. above below 1956
_____ which is _____ ft. above below surface

10. Pump: Type Turbine Capacity _____ G. M.
Power: Kind Electric Horsepower _____

11. Yield: Flow _____ G. M., Pump 290 G. M., Meas., Rept. Est. _____
Drawdown _____ ft. after _____ hours pumping _____ G. M.

12. Use: Dom., Stock, PS., RR., Ind., Irr., Obs. _____
Adequacy, permanence Plenty

13. Quality good Temp. 67 °F.
Taste, odor, color Clear Sample Yes No 5-18-59

Unfit for _____
14. Remarks: (Log, Analyses, etc.) _____

18. [Faint, illegible text]

19. [Faint, illegible text]

20. [Faint, illegible text]

21. [Faint, illegible text]

22. [Faint, illegible text]

23. [Faint, illegible text]

24. [Faint, illegible text]

25. [Faint, illegible text]

26. [Faint, illegible text]

27. [Faint, illegible text]

28. [Faint, illegible text]

29. [Faint, illegible text]

30. [Faint, illegible text]

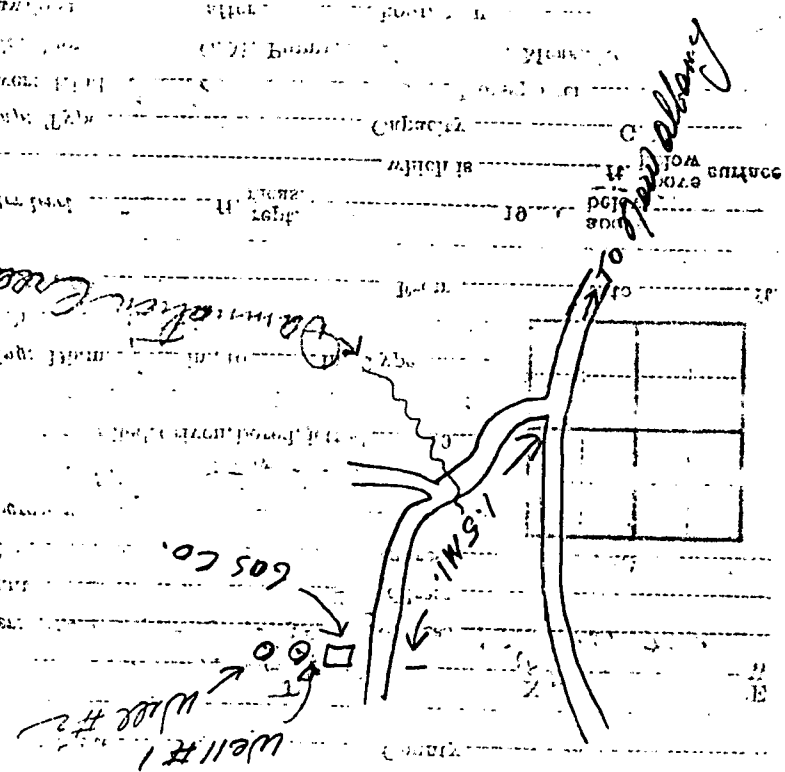

31. [Faint, illegible text]

32. [Faint, illegible text]

33. [Faint, illegible text]

34. [Faint, illegible text]

35. [Faint, illegible text]

36. [Faint, illegible text]

37. [Faint, illegible text]

38. [Faint, illegible text]

39. [Faint, illegible text]

40. [Faint, illegible text]

DEPARTMENT OF THE INTERIOR
UNITED STATES

(2020) 1220

