

TRANSMITTED FOR ADP

Replacement

Coded By J Crout 9/81
Checked By [Signature]
Entered By [Signature]
Date 8-22-89

U.S. GEOLOGICAL SURVEY
WATER RESOURCES DIVISION
MISSISSIPPI DISTRICT

E-Log No. [Blank]
County TUNICA
Agency [Blank]

Well No. D29

WELL RECORD

Agency Code: U S G S Site Id: 13445410191023108011 Project No.: 54

Station Name: 12 DP291 JACKI DIAYI PIERIRIYI Latitude: 9 3445401 Longitude: 10 0910231081

Lat/Long Ac.: 11 S F T M Dist: 6=28 State: 7=28 County: 8 11431 Land Net: 13 SWSEISPO15T014SIRI111W1

Location Map: 14= Altitude: 16 11881 Met/Meas: 17 A M Accuracy: 18 15 Hydrologic Unit: 20 01810310210141

Agency Use: 803 A I O Date Inventoried: 711 / / / / / Station Type: Data Type: 804

Instru.: 805 Remarks: 806 Relia.: 3 D L M U 2 W X

Date of Construction: 21 0121 / 1011 / 1197781 Well Use: 23 W Water Use: 24 I Primary Aquifer: 714 1121RVAI1 Hole Depth: 27 1125

Well Depth: 28 1125 Water Level: 30 116 Water Level Date: 31 96 / 11 / 119811 Method: 34 Status: 37 Source: 33

CONSTRUCTION DATA

R=58 T=A 723#1 Construction Date: 60 0121 / 1011 / 1197781 Contractor: 63 Name: Hester Method: 65 A Finish: 66 S

CONSTRUCTION CASING DATA

R=76	T=A	725#1	59#1	77 1101	78 1115	79 116
R=76	T=A	725#2	59#1	77	78	79

CONSTRUCTION OPENINGS DATA

R=82	T=A	726#1	59#1	83 1115	84 1125	87 116	85 S	89	88
R=82	T=A	726#2	59#1	83	84	87	85	89	88

CONSTRUCTION LIFT DATA

R=42 T=A 254#1 Lift Type: 43 Date: 38 / / / / / Intake: 44

Power: 45 H.P.: 46 Serial No.: 49

MISCELLANEOUS OWNER DATA

R=158 T=A 718#1 Date of Ownership: 159 0121 / 1011 / 1197781 Owner Name: 161 JACK DIAYI PIERIRIYI

MISCELLANEOUS OTHER ID DATA

R=189 T=A 736#1 E-Log No.: 190 Assigner: 191 M I S S I D I S T

MISCELLANEOUS QW DATA

R=192	T=A	738#1	Date of Measurement	1934 / *	Aquifer Sampled	195 *	Temp	196#00010	Value	197
R=192	T=A	738#2	Date of Measurement	1934 / *	Aquifer Sampled	195 *	Sp Cond	196#00095	Value	197 *
R=192	T=A	738#3	Date of Measurement	1934 / *	Aquifer Sampled	195 *	pH	196#00400	Value	197

MISCELLANEOUS LOGS DATA

R=198	T=A	739#1	Log Type	1994 *	Beg. Depth	200 *	End Depth	201 *
R=198	T=A	739#1	Log Type	1994 *	Beg. Depth	200 *	End Depth	201 *

MISCELLANEOUS NETWORK DATA

706 = WL *

R=114	T=A	730#1	Beg. Year	1154 98 *	End Year	116 19 *	Agency Source	120=A	117#	Freq.	118 *
R=121	T=A	730#2	Beg. Year	122 123 19 *	End Year	123 126 19 *	Agency Source	124 117#	Freq.	118 *	

MISCELLANEOUS REMARKS DATA

R=183	T=A	311#1	Date of Remarks	184 / / *	Remarks	185 *
-------	-----	-------	-----------------	---------------------------	---------	---------------------------

DISCHARGE DATA

R=146	T=A	Pump/Flow	147#1	Date	148 / / *	Type	703 P F	Discharge	150 *	Sp. Capacity	272 *
-------	-----	-----------	-------	------	---------------------------	------	---------	-----------	-----------------------	--------------	-----------------------

GEOHYDROLOGIC DATA

R=90	T=A	721#1	Depth Top	91 *	Depth Bot.	92 *	Unit Id	93 12MIRVIAI *	304=P
------	-----	-------	-----------	----------------------	------------	----------------------	---------	--------------------------	-------

HYDRAULIC DATA

R=98	T=A	790#1	Unit Tested	100 *	103 *
------	-----	-------	-------------	-----------------------	-------------

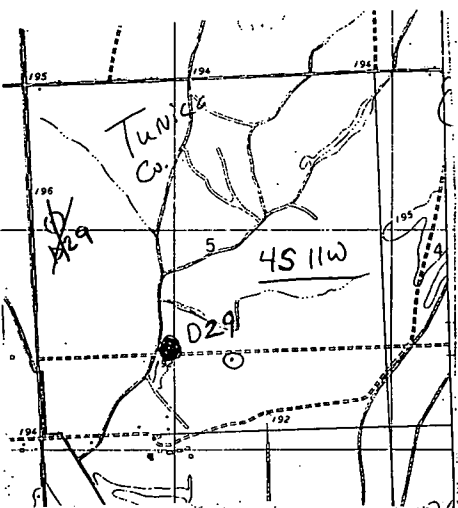

Water Level Data Collection (1) - [] - [] - []

Mr. Perry P.O. Box-1309
363-1309 Tunica, Ms. 38676

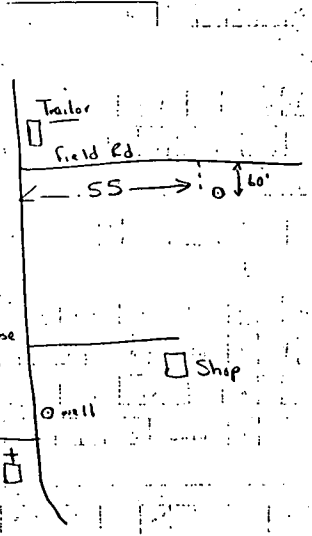

Take left just past chev dealer just W of Tunica
then take 1st Rt follow Rd. North