

Recorded by WTO
Date 6/20/80

TRANSMITTED FOR ADP
9/80

U.S. GEOLOGICAL SURVEY
WATER RESOURCES DIVISION
MISSISSIPPI DISTRICT
WELL RECORD

MBOH tag
710005-01

Well No. L47
E-Log No. _____
County TISH.

Site ID 342918088112301 R=0* T=A* 2=W*

Data reliab. 3=U* Report. agency 4=USGS* Dist. 6=28* 7=28* Co. 8=141*

Lat. _____ Long. 9=342918* 10=0881123* Well No. 12=L047*

Location 13=SE, SW, SENE S 1/2 T 07 S R 10 E* Alt. 16=560* 556 1/93

Hyd. Unit (OWDC) 20= _____* Date 21=06/20/1980*

Well use 23=W* Water Use 24=P* Hole depth 27=112* Well depth 28=107*

WL 30=33* Date 31=06/20/1980* Source 33=D*

Status 273= _____* Project No. 5= _____*

R=158* T=A* Date 159#06/20/1980* Owner No. _____

Owner 161=GOLDEN WA*

R=192* T=A* Date 193# _____* Temp. 196#00010* 197= _____*

R=192* T=A* Date 193# _____* Cond. 196#00095* 197= _____*

R=192* T=A* Date 193# _____* pH 196#00400* 197= _____*

R=58* T=A* 59# 1* Date 60=06/20/1980* Remarks _____

Drlg. 63=064* Name Layne Method 65=R* Finish 66=S*

R=76* T=A* 59# 1* Top csng. 77# 0* Bot. csng. 78=82* Diam. 79# 16*

R=76* T=A* 59# 1* Top csng. 77# _____* Bot. csng. 78= _____* Diam. 79# _____*

R=82* T=A* 59# 1* Top 83# 82* Bottom 84=107*

Type 85=S* Diam. 87=10* Size 88= _____*

R=82* T=A* 59# 1* Top 83# _____* Bottom 84= _____*

Type 85= _____* Diam. 87= _____* Size 88= _____*

YIELD R=146* T=A* 147# 1* Q 150=150* Q/S 272= _____*

134 flows 146 pumped

St. e.

GEN. SITE DATA

OWNER

FIELD QW

CONSTR.

CASING

OPENINGS

YIELD

R=42* T= A * Lift type 43# T* Intake 44= * Power type 45= E*

Date 38= 06/20/1980* H.P. 46= 7.5*

LIFT

R=198* T= A * Log 199# D* Top 200= 0.* Bot 201= 112.*

R=198* T= A * Log 199# * Top 200= * Bot 201= *

R=189* T= A * E Log No. 190# * 191= M I S S D I S T *

LOGS

R=114* T= A * Year 115# * Type 120= *

ANAL.

R=90* T= A * 256# 1* Top 91= 23.* Bot 92= 112.*

Unit ID 93= 21150RD * Name of Unit

AQUIFERS

R=90* T= A * 256# 1* Top 91= * Bot 92= *

Unit ID 93= * Name of Unit

R=98* T= A * 99# 1* Unit tested 100= * 103= *

R=105* T= A * 99# 1* Test No. 106# *

HYDRAULICS

107= * Transmissivity (gal/d)/ft

108= * Hydraul. cond. (gal/d)/ft²

110= * Storage coeff. Boundaries

R=121* T= * Yr Begin 122# * Network 258= *

Water Level Data Collection (1)

driller rpt 39pm/ft.

description of formations encountered	from	to
Clay & gravel	0	10
Clay	10	19
Clay & Sand stks.	19	23
Gravel	23	32
Sand & gravel	32	90
Rock	90	91
Sand & gravel	91	98
Clay	98	103
Sand & gravel & clay stks	103	112

247

MSGW 13761

MSDDH 710005-01

Tishomingo
~~1112~~
 6/20/80

MISSISSIPPI
 BOARD OF WATER COMMISSIONERS
 416 North State Street
 Jackson, Mississippi 39201
 WATER WELL DRILLERS LOG

CODED

6/20 19 80 Layne-Central Company Tishomingo
 date well completed firm name county well located

LANDOWNER: Golden Water Association City Hall Golden, MS 38847 (mailing address)	description of formations encountered	from to	
		ft	ft
	Clay & gravel	0	10
	Clay	10	19
	Clay & Sand stks.	19	23
	Gravel	23	32
	Sand & gravel	32	90
	Rock	90	91
	Sand & gravel	91	98
	Clay	98	103
	Sand & gravel & clay stks	103	112

WELL LOCATION:
 sec. 7 T. 7 S. R. 11 E. 105
 in Golden city limits of (distance) miles (direction) of (nearest town)

WELL PURPOSE: municipal
 (home, irrigation, municipal, industrial)

WELL COMPLETION DATA:

(1) diameter (inches) 16"
 (2) total depth (feet) 110'
 (3) static water level (feet) 33' 3" below top of ground.
 (4) casing steel 82' (material) (depth) If telescope see back. (size)
 (5) screen 25' 107' (length) (depth to top) 10" stainless steel (size) (material)
 (6) pump 7 1/2 150 (HP) (yield gpm). elec. (type power)
 (7) electric log No. (yes or no) (organization running log)
 (8) how well bottom plugged S.S. plate

CODED

DEPT. OF NATURAL RESOURCES
 BUREAU OF LAND & WATER RESOURCES

AUG 4 1980

RECEIVED

DRILLERS REMARKS:

OR

*Red BAY
QUAD*

UNITED STATES
TENNESSEE VALLEY AUTHORITY
MAPPING SERVICES BRANCH

0 603 000 6

10051

87 280 000 FEET (ALA.)

88

12°30'

10 KA 2.3 MI.
TISHOMINGO 10 MI.

90

3353 II SW
(BELMONT 26-SW)

92

10° 93

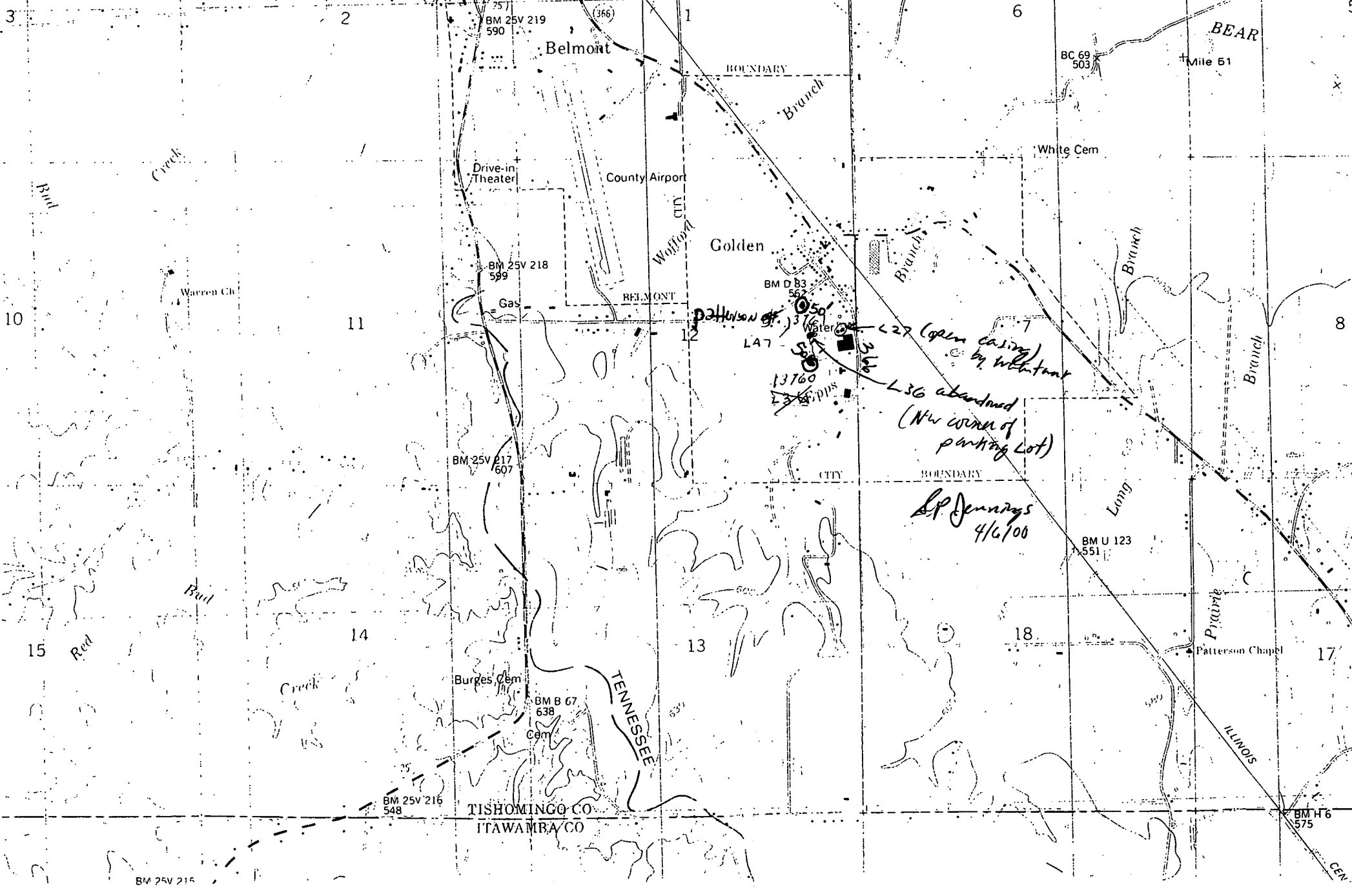

3

2

1

6

5

10

11

12

7

8

15

14

13

18

17

BM 25V 215

BM 25V 216
548

TISHOMINGO CO
ITAWAMBA CO

BM B 67
638

Burges Cem

BM D 83
567

Water

13760

23 pps

*L27 (open casing)
by Wellman*
*L36 abandoned
(NW corner of
parking lot)*

*S.P. Jennings
4/6/00*

BM U 123
551

BM H 6
575

*Bull
Creek*

Warren Ch

*Bull
Creek*

Creek

TENNESSEE

Belmont

Golden

BEAR

Mile 51

White Cem

County Airport

Drive-in Theater

BM 25V 219
590

BM 25V 218
599

BM 25V 217
607

Cem

Patterson Chapel

Pirate

Long

Branch

Branch

Branch

BOUNDARY

WOLFORD
CITY

BELMONT

BOUNDARY

CITY

Branch

Branch

ILLINOIS

CEN