

Hole 34 A

FORM 9-1642 (1-68)

Well No. J13

WELL SCHEDULE

U. S. DEPT. OF THE INTERIOR

GEOLOGICAL SURVEY

WATER RESOURCES DIVISION

PUNCHED
JAN 12 1974

MASTER CARD

Water level
11/18/82
107.32
8-13-87
161.11

Record by B.S. 100 Source of data obs. 501 Date 7/28/71 Map Paden

State Michigan County 28 (or town) Chickadee 71

Latitude: 34° 40' 53" N Longitude: 088° 16' 12" W
Lat-long accuracy: 2 sec

Local well number: J013AB0505S10E Other number: 2

Local use: 028 Owner or name: Marvin Donaldson

Owner or name: USCE NO 34A Address: _____

Ownership: County, (F) Fed Gov't, City, Corp or Co, Private, State Agency, Water Dist F

Use of Air cond, Bottling, Comm, Dewater, Power, Fire, Dom, Irr, Med, Ind, P S, Rec, water: _____

Stock, Instit, Unused, Repressure, Recharge, Desal-P S, Desal-other, Other U

Use of well: Anode, Drain, Seismic, Heat Res, Obs, Oil-gas, Recharge, Test, Unused, Withdraw, Waste, Destroyed. U

DATA AVAILABLE: Well data 70 Freq. W/L meas.: M Field aquifer char. 71

Hyd. lab. data: _____

Qual. water data; type: P

Freq. sampling: _____ Pumpage inventory: 75 yes no period: _____

Aperture cards: _____

Log data: D.E

WELL-DESCRIPTION CARD

SAME AS ON MASTER CARD Depth well: 266 ft Meas. rept. accuracy 3

Depth cased: (first perf.) 256 ft Casing type: PVC Diam. 4 1/2 in

Finish: porous concrete, gravel w. concrete, gravel w. (screen), horiz. gallery, open perf., screen, ad. pt., shored, open hole, other S

Method Drilled: air rot, bored, cable, dug, hyd rot, jetted, air percussion, rotary, reverse trenching, driven, drive wash, other H

Date Drilled: 9-7-71 Pump intake setting: _____ ft

Driller: USCE

Lift (type): air, bucket, cent, jet, multiple, multiple, none, piston, rot, submerg, turb, other S Deep 39 Shallow 40

Power (type): diesel, elec, gas, gasoline, hand, gas, wind; H.P. 41 Trans. or meter no. _____

Descrip. MP Top of 4' col. 5' 0.5' ft above below LSD, Alt. MP _____

Alt. LSD: OK (11/89) 560 Accuracy: 70 ft 5

Water Level 83.28 ft above below MP; Ft below LSD 83 Accuracy: _____ A

Date meas: 3-7-82 Yield: 8 gpm Method determined _____

Drawdown: _____ ft Accuracy: _____ hrs 50 Pumping period _____

QUALITY OF WATER DATA: Iron _____ ppm Sulfate _____ ppm Chloride _____ ppm Hard. _____ ppm
Sp. Conduct 162 K x 10⁶ Temp. 47.2 °F Date sampled _____

Taste, color, etc. _____

WELL NO.

Latitude-longitude _____
d m s N S

HYDROGEOLOGIC CARD

SAME AS ON MASTER CARD

Physiographic Province: _____

Section: 03

Drainage Basin: D

Subbasin: 13B

Topo of well site: (D) depression, (C) stream channel, (E) dunes, (F) flat, (H) hilltop, (K) sink, (L) swamp, (O) offshore, (P) pediment, (S) hillside, (T) terrace, (U) undulating, (V) valley flat

MAJOR AQUIFER:

system _____ series K3

aquifer, formation, group G9

Lithology: _____

QY

Origin: _____

2

Aquifer Thickness: _____ ft

Length of well open to: 73 ft

ft _____

Depth to top of: 40 ft

ft 226

MINOR AQUIFER:

system _____ series _____

aquifer, formation, group _____

Lithology: _____

Origin: _____

Aquifer Thickness: _____ ft

Length of well open to: _____ ft

ft _____

Depth to top of: _____ ft

ft _____

Intervals Screened: 266-288

266-288 008 x 2"

Depth to consolidated rock: _____ ft

ft _____

Source of data: _____

Depth to basement: _____ ft

ft _____

Source of data: _____

Surficial material: _____

Infiltration characteristics: _____

Coefficient Trans: _____

_____ gpd/ft

Coefficient Storage: _____

Coefficient Perm: _____

_____ gpd/ft²; Spec cap: _____

_____ gpd/ft; Number of geologic cards: _____

6" hole & 4" pipe to 266'
2" pipe 266' - 288'
008 x 2" " 288 - 298

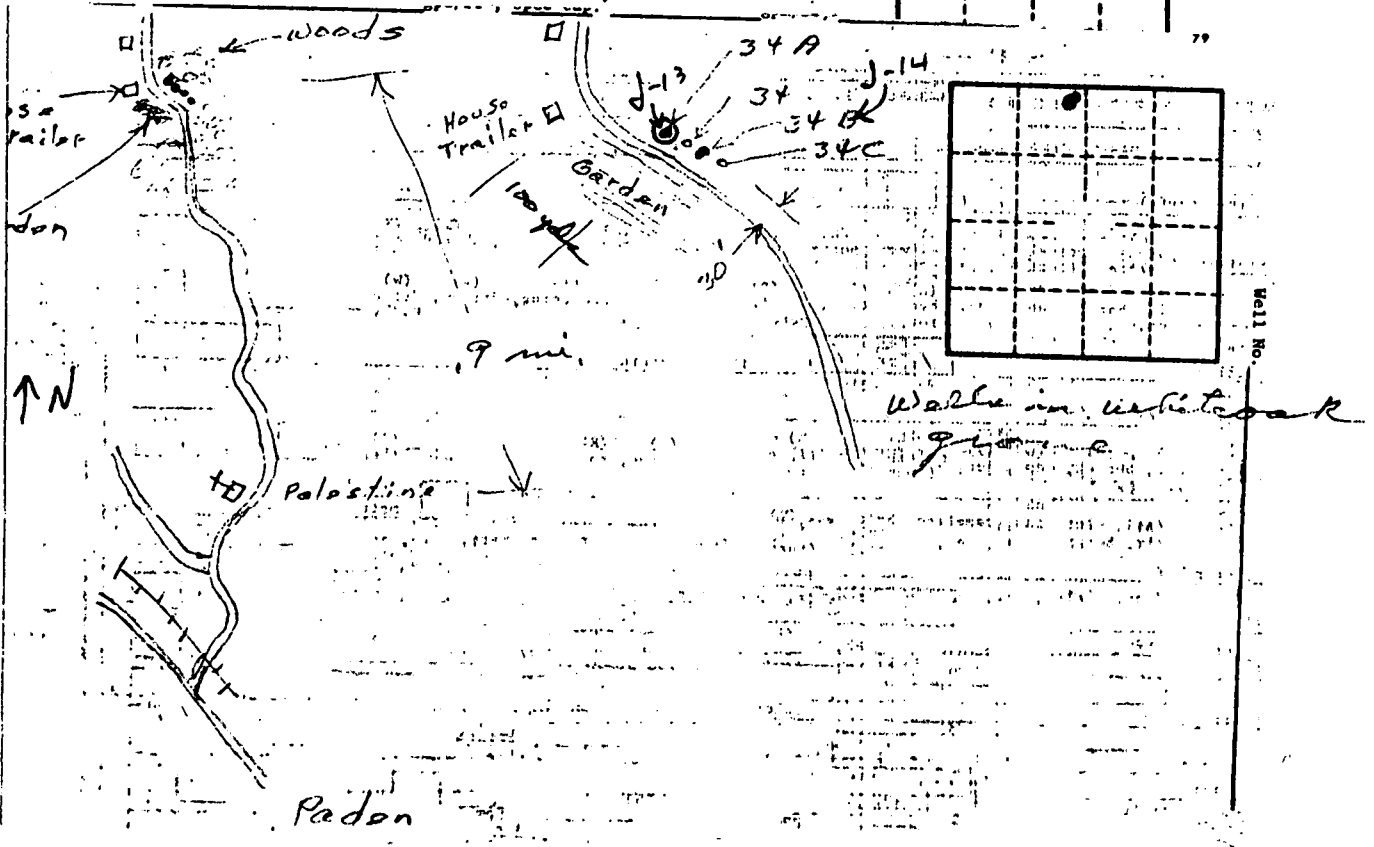
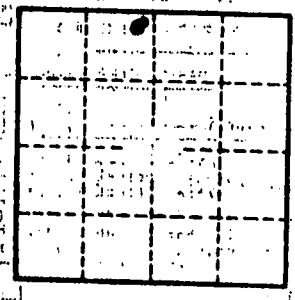
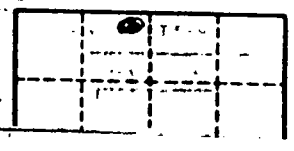

MISSISSIPPI DEPARTMENT OF ENVIRONMENTAL QUALITY
Bureau of Land and Water Resources

P.O. Box 10631
 Jackson, Mississippi 39289-0631
**WATER WELL PLUGGING
 DECOMMISSIONING**

COUNTY WELL LOCATED Tishomingo	
WELL NUMBER 34A	CODED
DATE WELL PLUGGED 4 Oct 90	

PERMIT NUMBER
NAME OF DRILLING FIRM

NAME & MAILING ADDRESS OF LANDOWNER U.S. Army Engr. Dist., Mobile			
P.O. Box 2288			
Mobile, AL 36628			
WELL LOCATION	SEC	TOWNSHIP	RANGE
NWNE505T05SR10E			
DISTANCE	DIRECTION	NEAREST TOWN	
OTHER LANDMARK			
WELL PURPOSE Home, Irrigation, Municipal, Industrial, Fish Pond etc Ground water Study			

NAME OF WELL CONTRACTOR WHO DRILLED THE WELL		
NAME OF LANDOWNER WHEN WELL WAS DRILLED		
WELL DATA		
Well Depth 266	Casing Diameter (In.) 4"	Casing Length (Ft.)
Type of Casing PVC	Hole Depth	Depth to Static Water Level 102.5
DATE WELL COMPLETED		

DESCRIBE HOW THE WELL OR HOLE WAS PLUGGED (AMOUNT OF CASING AND/OR SCREEN THAT WAS REMOVED OR LEFT IN HOLE. MATERIAL USED IN PLUGGING ETC.)
<p>Portland cement Mix - 1 bag cement to 5.5 gallons water.</p> <p>Pumped approx 30 c.f. grout mix - used 25 bags cement. Cut riser pipe off flush w/ground, left remaining pipe and well screen in hole.</p>

I CERTIFY THAT THE WELL WAS PLUGGED OR ABANDONED IN ACCORDANCE WITH THE STATE OF MISSISSIPPI REGULATIONS	
_____ SIGNATURE	_____ DATE

PADEN QUAD

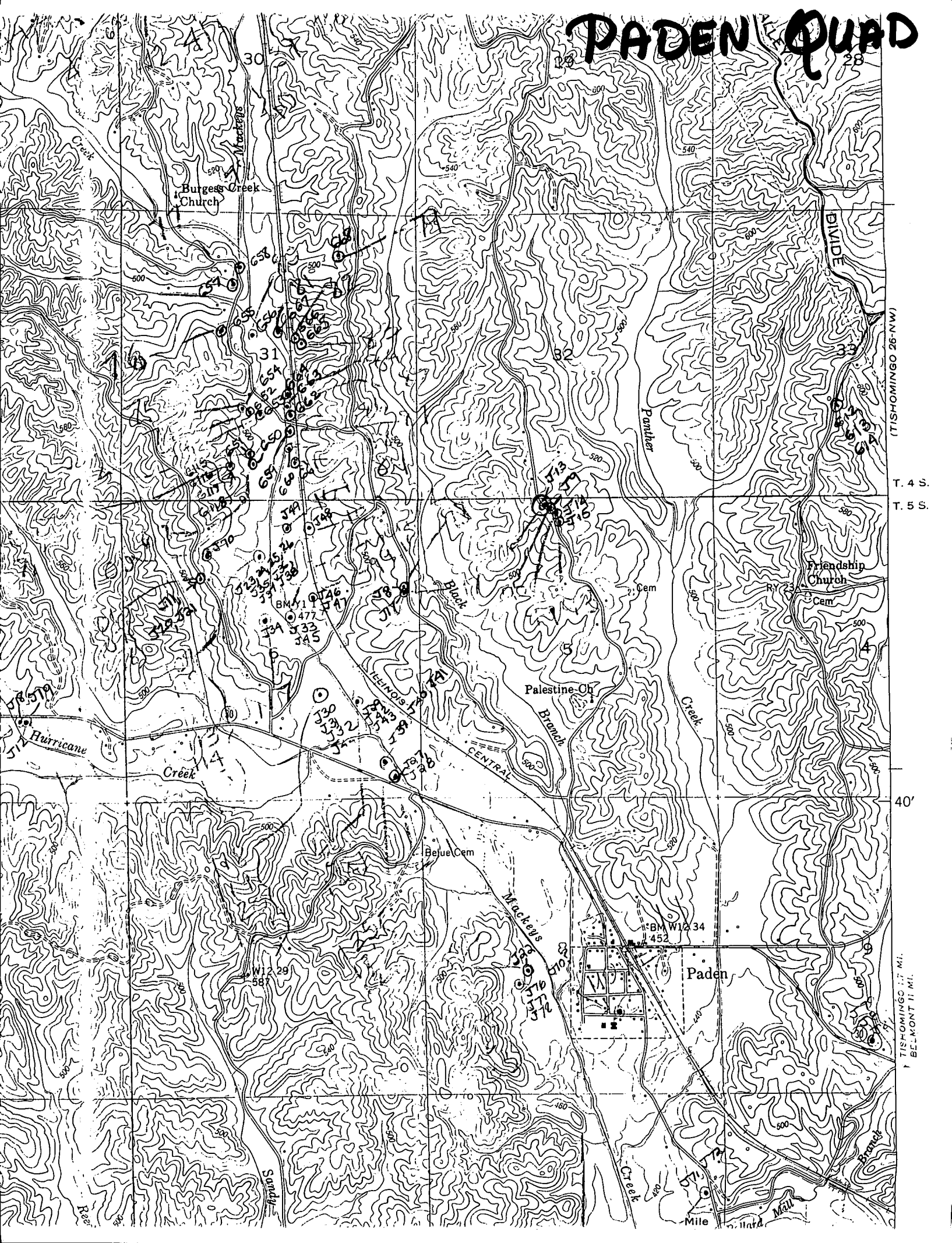

(TISHOMINGO 26-NW)

T. 4 S.
T. 5 S.

40'

1.7 MI.
TISHOMINGO
1.1 MI.
BELMONT