

GW-815

Inka Quad

TRANSMITTED FOR ADP

6/77-WTO

Recorded by B.W.
Date 5/25/1978

U.S. GEOLOGICAL SURVEY
WATER RESOURCES DIVISION
MISSISSIPPI DISTRICT
WELL RECORD

Well No. E19
E-Log No. 72
County TISHOMINGO

115A

Site ID 344849 088 1E 0601 R=0* T=A* 2=W*

GEN. SITE DATA

Data reliab. 3=C Report. agency 4=USGS Dist. 6=28 7=28 Co. 8=141
Lat. 9=344849 10=088 1E 0601 Well No. 12=E019
Long. 13=SE 1/4 Location 13=SE SW 1/4 T 03 S R 10 E Alt. 16=590
Hyd. Unit (OWDC) 20= Date 21=10 02 1973
Well use 23=W Water Use 24=P Hole depth 27=416 Well depth 28=400
WL 30=106 Date 31=10 02 1973 Source 33=S
Status 273= Project No. 5=

WL=105.50 10/97

OWNER

R=158* T=A* Date 159# 10 02 1973 Owner No. 161=IUKA

FIELD QW

R=192* T=A* Date 193# Temp. 196#00010 197=
R=192* T=A* Date 193# Cond. 196#00095 197=
R=192* T=A* Date 193# pH 196#00400 197=

CONSTR.

R=58* T=A* 59#1 Date 60=10 02 1973 Remarks
Drig. 63=064 Name LANE-CENTRAL Method 65=H Finish 66=S

CASING

R=76* T=A* 59#1
Top csng. 77# 0 Bot. csng. 78=320 Diam. 79# 12.0
R=76* T=A* 59#1
Top csng. 77# Bot. csng. 78= Diam. 79#

OPENINGS

R=82* T=A* 59#1 Top 83# 320 Bottom 84=400
Type 85=S Diam. 87=8.0 Size 88=
R=82* T=A* 59#1 Top 83# Bottom 84=
Type 85= Diam. 87= Size 88=

YIELD

R= 146 T=A* 147# 1 Q 150=750 Q/S 272=14
134 flows 146 pumped

R=42* T= A * Lift type 43# T* Intake 44= * Power type 45= E*

Date 38= 10/02/1973* H.P. 46= 75.*

R=198* T= A * Log 199# D* Top 200= 0.* Bot 201= 410.*

R=198* T= A * Log 199# E* Top 200= 30.* Bot 201= 385.*

R=189* T= A * E Log No. 190# 0.72* 191= M I S S D I S T *

R=114* T= A * Year 115# * Type 120= *

R=90* T= A * 256# 1 * Top 91= * Bot 92= *

Unit ID 93= 300PLZC * Name of Unit

R=90* T= A * 256# 1 * Top 91= * Bot 92= *

Unit ID 93= * Name of Unit

R=98* T= A * 99# 1 * Unit tested 100= 300PLZC * 103= *

R=105* T= A * 99# 1 * Test No. 106# 1 *

107= 6952 * Transmissivity (gal/d)/ft 52,000

108= 35 * Hydraul. cond. (gal/d)/ft² 260

110= * Storage coeff. Boundaries

R=121* T= * Yr Begin 122# *

Water Level Data Collection (1)

11/18/82
WL= 85.95

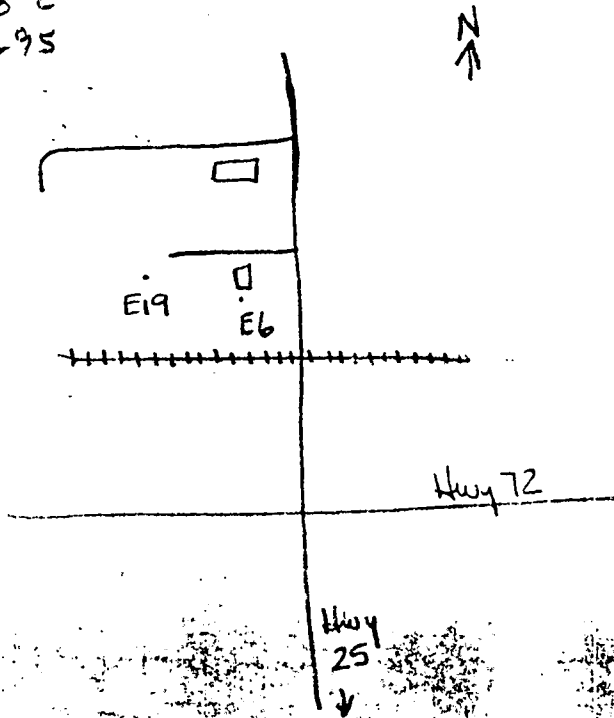

IUKA QUAD

