

FORM 9-1642 (1-68)

Well No. B 27

WELL SCHEDULE

PUNCHED

U. S. DEPT. OF THE INTERIOR

GEOLOGICAL SURVEY

WATER RESOURCES DIVISION

JAN 11 1974

MASTER CARD

Record by D E Williams Source of data obs & dir Date 10-30-73 Map Yellow Creek

State 28 County TISH. 71

Latitude: 345725 N Longitude: 0881456 Sequential number: 1

Local well number: B022BA3301S10E Other number: B & M

Local use: 073 66 Owner or name: well #5 Yellow Creek Port anti.

Owner or name: YELLOW CR PORT Address: _____

Ownership: (C) County, Fed Gov't, City, Corp or Co, Private, State Agency, Water Dist S

Use of water: (A) Air cond, Bottling, Comm, Dewater, Power, Fire, Dom, Irr, Med, Ind, P S, Rec, (S) Stock, Inactit, Unused, Repressure, Recharge, Desal-P S, Desal-other, Other U

Use of well: (A) Anode, Drain, Seismic, Heat Res, Obs, Oil gas, Recharge, Test, Unused, Withdraw, Waste, Destroyed. T

DATA AVAILABLE: Well data Freq. W/L meas: Field aquifer char. Z

Hyd. lab. data: _____

Qual. water data; type: _____

Freq. sampling: _____ Pumpage inventory: _____

Aperture cards: _____

Log data: DE

WELL-DESCRIPTION CARD

SAME AS ON MASTER CARD Depth well: 247 Meas. rept accuracy 1

Depth cased: 77 Casing type: _____ Diam. in 6

Finish: (C) concrete, (F) gravel w. concrete, (G) gravel w. (perf.), (H) horz. screen, (J) open gallery, end, (P) perf., (S) screen, (T) sd. pt., (W) shored, (X) open hole, other X

Method: (A) air bored, (B) cable, (C) dug, (D) hyd rot., (H) air rot., (J) jetted, (P) air percussion, (R) reverse, (T) trenching, (V) driven, (W) drive wash, other A

Date Drilled: 973 Pump intake setting: _____

Driller: Miller Drilling Co. Lawrenceburg Tenn.

Lift (type): (A) air, (B) bucket, (C) cent, (J) jet, (L) multiple, (M) multiple, (N) none, (P) piston, (R) rot, (S) submerg, (T) turb, other N Deep Shallow

Power (type): (nat) diesel, elec, gas, gasoline, hand, gas, wind; (LP) H.P. Trans. or meter no.

Descrip. MP _____ ft above below LSD, Alt. MP

Alt. LSD: 442 Accuracy: 5 ft tops

Water Level: above below MP; Ft below LSD 14 Accuracy: _____

Date meas: 10-3-73 Yield: 80 gpm 80 Method determined 1

Drawdown: 12 Accuracy: A Pumping period: 24 hrs

WATER DATA: Iron 0.1 Sulfate _____ Chloride _____ Hard. _____

Sp. Conduct 450 K x 10⁶ Temp. 60 °F Date sampled 10-3-73

Taste, color, etc. P2-54

Well No. B22

PUNCHED

Latitude-longitude _____
d m s d m s

HYDROGEOLOGIC CARD

SAME AS ON MASTER CARD Physiographic Province: 03 Section: _____

D Drainage Basin: 119 R Subbasin: _____

Topo of well site: (D) depression, stream channel, dunes, flat, hilltop, sink, swamp, (E) (F) (R) (S) (L) (P) (S) (T) (U) (V) offshore, pediment, hillside, terrace, undulating, valley flat _____

MAJOR AQUIFER: system _____ series Y aquifer, formation, group _____

Lithology: _____ Origin: _____ Thickness: _____
Length of well open to: _____ ft 170 Depth to top of: _____ ft _____

MINOR AQUIFER: system _____ series _____ aquifer, formation, group _____

Lithology: _____ Origin: _____ Thickness: _____
Length of well open to: _____ ft _____ Depth to top of: _____ ft _____

Intervals Screened: _____

Depth to consolidated rock: _____ ft _____ Source of data: _____

Depth to basement: _____ ft _____ Source of data: _____

Surficial material: _____ Infiltration characteristics: _____

Coefficient Trans: 6.000 gpd/ft 602 Coefficient Storage: _____

Coefficient Perm: _____ gpd/ft²; Spec cap: 6.6 gpm/ft; Number of geologic cards: _____

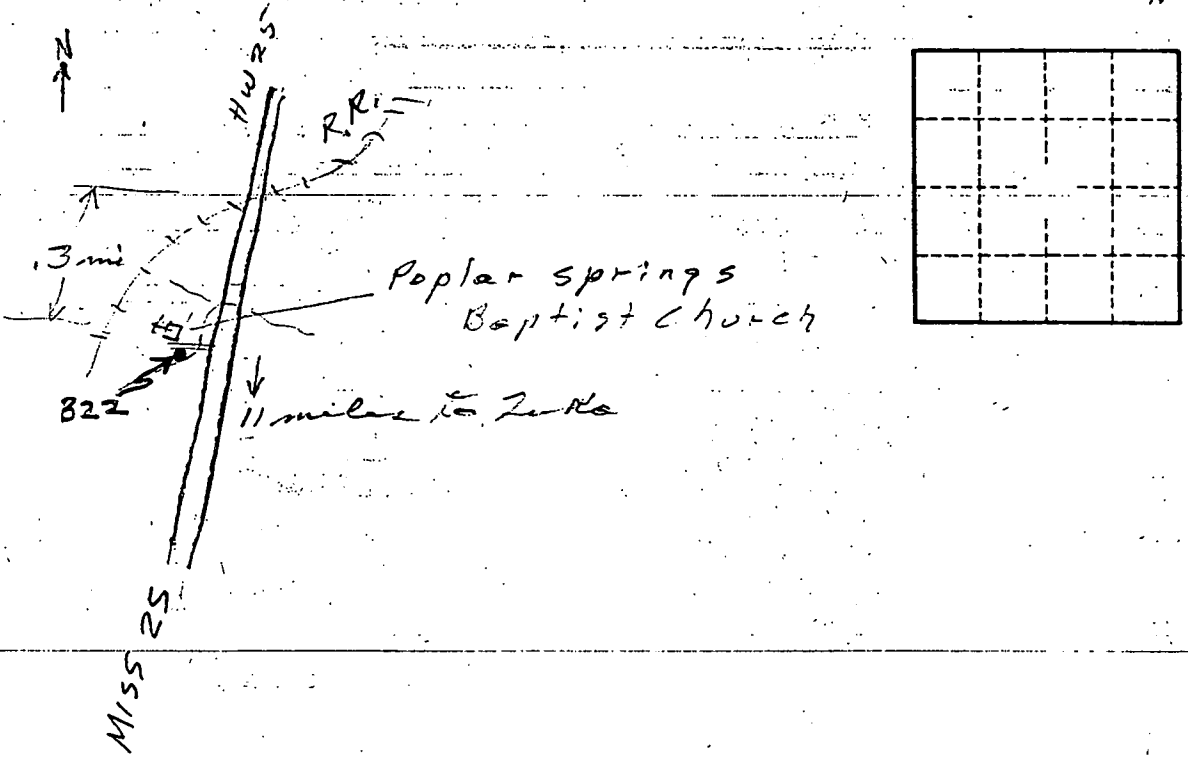

YELLOW CREEK QUAD

TENN. FEET

B-27.1
+6
? B-31

