

6/77 WIO

Recorded by WIO

Date 5/19/77 4/23/78

U.S. GEOLOGICAL SURVEY
WATER RESOURCES DIVISION
MISSISSIPPI DISTRICT
WELL RECORD

TRANSMITTED FOR ADP
5/78

Well No. J73
E-Log No. 23
County TIPPAH

Site ID 344142088555301 R=0* T=A* 2=W*

Data reliab. 3=C Report. agency 4=USGS Dist. 6=28 7=28 Co. 8=139

Lat. Long. 9=344142 10=0885553 Well No. 12=J073

Location 13=SENE S 36 T 04 S R 03 E Alt. 16=545

Hyd. Unit (OWDC) 20= Date 21=05/19/1977

Well use 23=W Water Use 24=P Hole depth 27=1050 Well depth 28=960

WL 30=245 Date 31=12/01/1977 Source 33=D

Status 273= Project No. 5=

GEN. SITE DATA

OWNER

R=158* T=A* Date 159#12/01/1977 Owner No.

Owner 161=NEW HOPE-BUENA VISTA W.A.

FIELD QW

R=192* T=A* Date 193# Temp. 196#00010 197=

R=192* T=A* Date 193# Cond. 196#00095 197=

R=192* T=A* Date 193# pH 196#00400 197=

CONSTR.

R=58* T=A* 59#1* Date 60=12/01/1977 Remarks

Drlg. 63=027 Name Webb Method 65=H Finish 66=S

CASING

R=76* T=A* 59#1*

Top csng. 77# 0 Bot. csng. 78=860 Diam. 79# 10

R=76* T=A* 59#1*

Top csng. 77# 810 Bot. csng. 78=900 Diam. 79# 6

OPENINGS

R=82* T=A* 59#1* Top 83# 900 Bottom 84=960

Type 85=S Diam. 87=6 Size 88=

R=82* T=A* 59#1* Top 83# Bottom 84=

Type 85= Diam. 87= Size 88=

YIELD

R=146 T=A* 147# 1* Q 150=200 Q/S 272=
134 flows 146 pumped

R=42* T= A * Lift type 43# T* Intake 44= * Power type 45= E*

Date 38= 12/01/1977* H.P. 46= 40.*

R=198* T= A * Log 199# D* Top 200= 0.* Bot 201= 960.*

R=198* T= A * Log 199# E* Top 200= 270.* Bot 201= 1050.*

R=189* T= A * E Log No. 190# 023* 191= M I S S D I S T *

R=114* T= A * Year 115# * Type 120= *

R=90* T= A * 256# 1 * Top 91= 860.* Bot 92= 960.*

Unit ID 93= 211 COFF * Name of Unit

R=90* T= A * 256# 1 * Top 91= * Bot 92= *

Unit ID 93= * Name of Unit

R=98* T= A * 99# 1 * Unit tested 100= * 103= *

R=105* T= A * 99# 1 * Test No. 106# *

107= * Transmissivity (gal/d)/ft

108= * Hydraul. cond. (gal/d)/ft²

110= * Storage coeff. Boundaries

R=121* T= * Yr Begin 122# *

Water Level Data Collection (1)

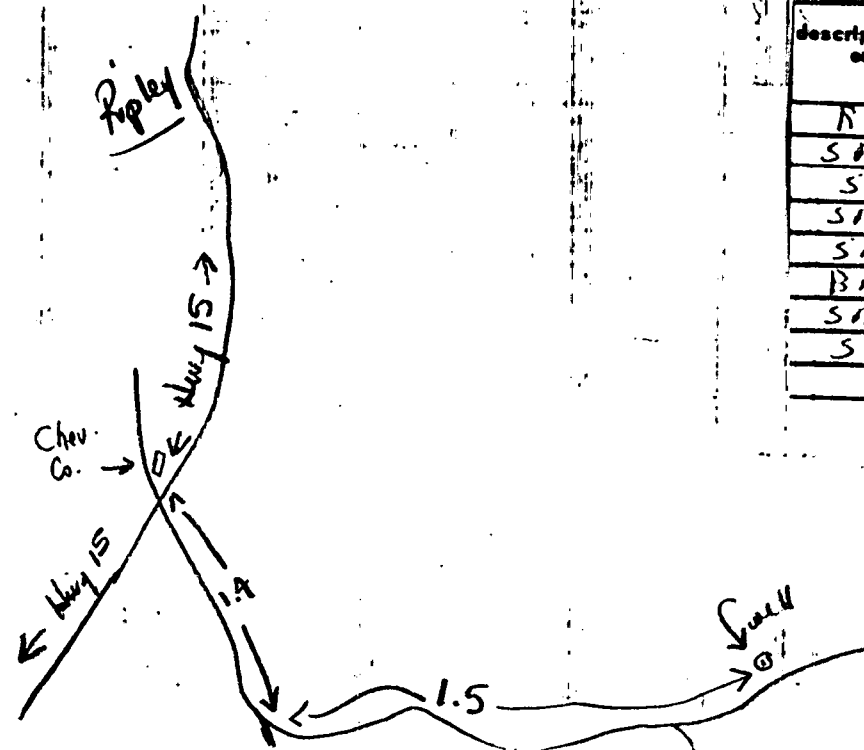

description of formations encountered	from	to
RED CLAY	0	25
SAND & CLAY	25	60
SAND & ROCK	60	220
SANDY CLAY	220	310
SAND & ROCK	310	400
BLUE CLAY	400	760
SAND & CLAY	760	810
SAND & ROCK	810	960

TIPPAH
 J 73
 12/71
 Elong # 23

MISSISSIPPI
 BOARD OF WATER COMMISSIONERS
 416 North State Street
 Jackson, Mississippi 39201

WATER WELL DRILLERS LOG

CODED

DEC 1 1977 J.W. WEBB & SONS TIPPAH
 date well completed firm name county well located

LANDOWNER: NEW-HOPE	description of formations encountered		from	to
BUENA-VISTA	RED CLAY		0	25
RIPLY, MISS (mailing address)	SAND & CLAY		25	60
	SAND & ROCK		60	220
	SANDY CLAY		220	310
	SAND & ROCK		310	400
	BLUE CLAY		400	760
	SAND & CLAY		760	860
	SAND & ROCK		860	960

WELL LOCATION:
 sec 36 T 05 S R 03 E
 2 miles NE of RIPLY
 (distance) (direction) (nearest town)

WELL PURPOSE: MUNICIPAL
 (home, irrigation, municipal, industrial)

- WELL COMPLETION DATA:
- (1) diameter (inches) 10"
 - (2) total depth (feet) 960'
 - (3) static water level (feet) 245 below top of ground.
 - (4) casing STEEL 860'
 (material) (depth)
 - (5) screen 60' 9800'
 (length) (depth to top)
 6" S.S.
 (size) (material)
 - (6) pump 40 200
 (HP) (yield gpm)
 - ELEC.
 (type power)
 - (7) electric log YES
 (yes or no)
 U.S.G.S.
 (organization running log)
 - (8) how well bottom plugged

CODED

RECEIVED

APR - 6 1978

MISS. BD. OF WATER COMM

DRILLERS REMARKS:

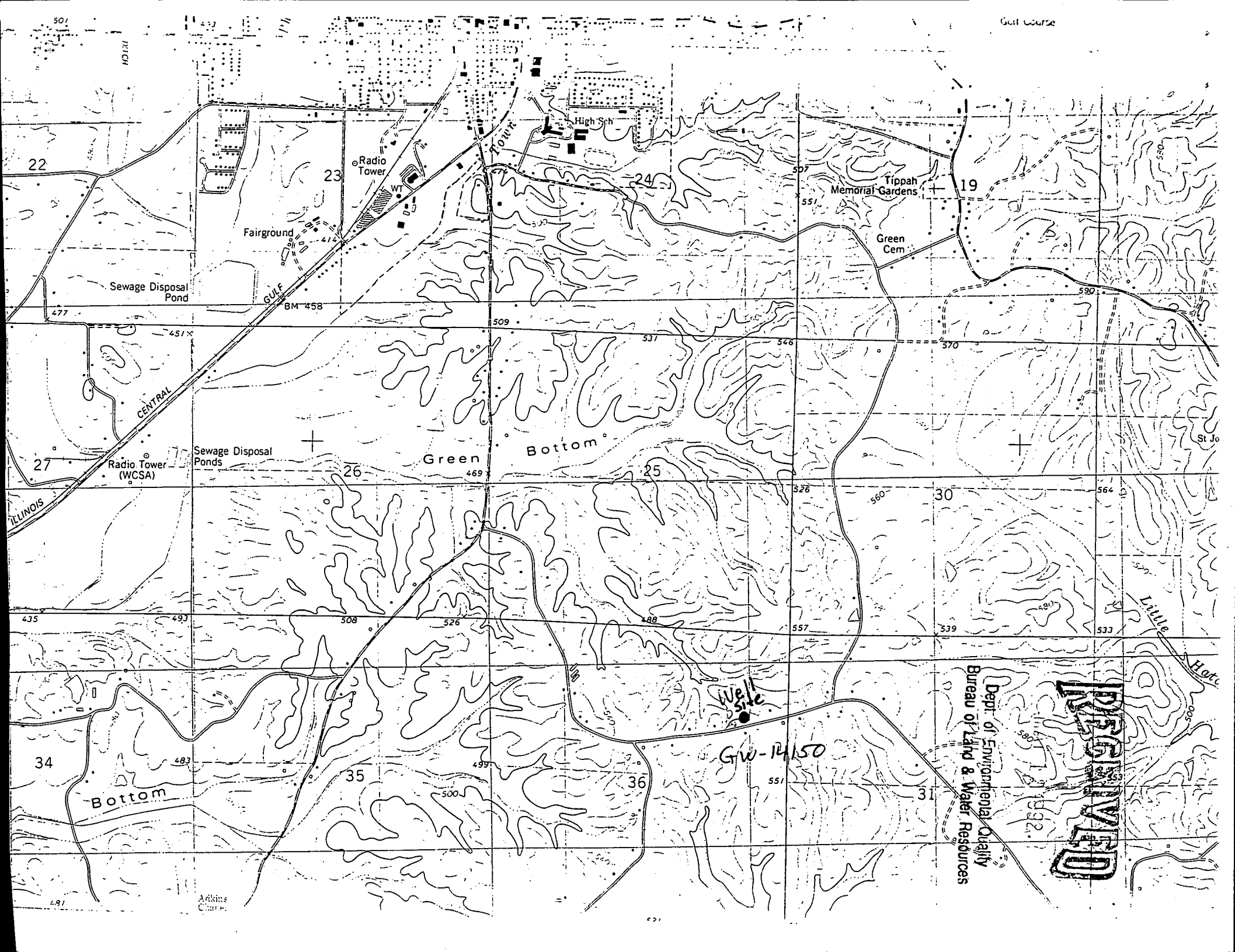

Dept. of Environmental Quality
 Bureau of Land & Water Resources

RESERVED

Well Site
 GW-14150

Arkins
 Clark

COFF

FORM BLW-AP-1
(rev. 10/88)

The box below is for office use only.

AMM

Issued: <u>6/9/92</u>	Expires: <u>6/9/02</u>	Fee Paid	<input checked="" type="checkbox"/>	Permit No. <u>GW-14150</u>
Lat. <u>344140</u>	Long. <u>885600</u>	Elev. <u>540</u>		USGS No.
Quad <u>Ripley</u>	Dist.			Basin No. <u>08030201</u>
STAC				Dam inv. No.
				Dam appl. No.

RECEIVED

Dept. of Natural Resources, Bureau of Land and Water Resources, P.O. Box 10631, Jackson, MS 39289-0631

APPLICATION FOR PERMIT TO DIVERT OR WITHDRAW FOR BENEFICIAL USE THE PUBLIC WATERS OF THE STATE OF MISSISSIPPI

MAR 26 1992

This application is for (circle one): GROUNDWATER SURFACE WATER

Dept. of Environmental Quality
Bureau of Land & Water Resources

Beneficial Use (circle one or more): Irrigation Fish Culture Municipal Rural Water Association Industrial
Recreation Institutional (Examples: Church, School) Commercial (Examples: Hotel, Restaurant) Livestock Standby
Fire Protection Flood Protection Other: _____

LANDOWNER:

New Hope Buena Vista Water Assoc. 64-0793225
(Name) (S/S or Tax ID No.)
8240 CR701
(Address)
Ripley MS 38663 (601) 837-8104
(City) (State and Zip) (Telephone Number)

APPLICANT, AGENT, OR LESSEE (If different from Landowner):

(Name) (S/S or Tax ID No.)

(Address)

(City) (State and Zip) (Telephone Number)

Location of diversion/withdrawal point (A suitable location map must accompany this application):

SE 1/4 of the NE 1/4 of Section 36, Township 4S, Range 3E, County Tippah

Volume of water diverted/withdrawn (Choose "a", "b", "c", or "d" ["d" is for units other than those shown in "a", "b", or "c"]):

- (a) _____ acre-feet per year at a maximum rate of _____ gallons per minute
- (b) 0.06 million gallons per day at a maximum rate of 200 gallons per minute
what they actually use.
- (c) _____ acre feet of storage at normal pool
- (d) _____ per _____ at a maximum rate of _____

Construction of proposed work will begin on (date) _____, 19____ and will be completed by (date) _____, 1994.

Water will be used from (month) _____ to (month) _____ each year.

Does the land to which this application pertains have any source(s) of water other than that for which you are now applying (circle one)?
YES NO If yes, describe the nature and amount of any additional supply and, if applicable, list permit numbers.

50 connections supplied by Ripley Water system

SECTION A (to be completed if application is for surface water source)

- Source of water is from _____ which drains into _____ which drains into _____
- Description of pump/diversion works:
 - (a) Pump (size and type): _____ Power Unit (size and type): _____
Lift: _____ feet Maximum capacity: _____ gallons per minute.
 - (b) Name of storage reservoir: _____ Dam height: _____ feet.
Surface area at normal pool: _____ acres. Storage capacity at normal pool: _____ acre-feet.

(Continued on back)

SECTION B (to be completed if application is for groundwater source)

1. Source of water is Kutaw Coffee sand aquifer.
 2. Description of proposed water well:
 (a) DEPTH OF WELL: 960 feet. DRILLER (name): JW Wobbe & Son
 (b) SURFACE CASING: Length: 860 feet. Diameter: 10 inches. Type: 5" x 1"
 (c) SCREEN: Length: 60 feet. Diameter: 6 inches. Type: 5" x 1"
 (d) PUMP: Type: Electric. Size: 40 HP. Capacity: 200 gallons per minute.
 Number of stages: _____ Setting depth: _____ feet.
 (e) POWER UNIT: Type: 3 phase. Size: 40 horsepower.
 DATE OF COMPLETION: _____

WATER USE DATA:

If for IRRIGATION, FISH CULTURE or any other areal use, show the number of acres to which water will be applied in the appropriate 40-acre block(s). Acreage must be shown on accompanying location map.

TOWN-SHIP	RANGE	SEC-TION	NE1/4				NW1/4				SW1/4				SE1/4				TOTALS
			NE1/4	NW1/4	SW1/4	SE1/4	NE1/4	NW1/4	SW1/4	SE1/4	NE1/4	NW1/4	SW1/4	SE1/4	NE1/4	NW1/4	SW1/4	SE1/4	

1. IRRIGATION: List the number of acres of each crop to be irrigated: Rice _____; Cotton _____; Soybeans _____; Corn _____; Pasture _____; Truck _____; Wheat _____; Oats _____; Grain sorghum _____; Other (specify) _____ Acres _____

2. FISH CULTURE: Explain how water will be used: _____
 How often will reservoir(s) be emptied and refilled? _____

3. MUNICIPAL or WATER ASSOCIATION
 Choose "a" or "b". (a) The number of people served is _____. (b) The number of connections/customers is 251.
 What is the estimated average daily consumption during periods of maximum use at the end of each five-year period during the next twenty years?
 _____ (Volume) _____ (Year); _____ (Volume) _____ (Year); _____ (Volume) _____ (Year); _____ (Volume) _____ (Year)

4. INDUSTRIAL: If water is to be released into a watercourse, indicate the amount released each year _____;
 Rate of release _____; Location of release point in reference to diversion/withdrawal point _____;
 _____; Explain any change in quality of water to be released: _____
 NPDES Permit No. _____
 Explain how water will be used: _____
 How much groundwater will be used for once-through non-contact cooling? _____

5. RECREATION: Explain how water will be used: _____

6. OTHER use: Explain in detail: _____

REMARKS: _____

List below the person to be contacted for additional information if required:
Ricky Martin
 (Name)
Box 7740 8240 CR 701
 (Address)
Ripley MS 38663
 (City, State, Zip)
601-837-8104
 (Telephone)

The accompanying map is hereby declared a part of this application. The TEN DOLLAR (\$10.00) permit fee is enclosed herewith.
Kyle Smith Secretary
 (Signature)

Subscribed and sworn to before me this 23rd day of March 1992, at Ripley, Ms.
 County of Leflore. My commission expires My. Collins. III Expires Dec. 13, 1993
Carolyn R. Sanderson, Notary Public